

Castors



Twin Wheel Castors



266-269



Light, Medium and Heavy-Duty Castors



270-285



Stainless Steel Castors



286-287



Temperature-Resistant Castors



288-291



Expander Fitting Castors and Wheels



292-293



A range of light duty to heavy duty castors.

Twin wheel castors are produced in numerous combinations of wheel and stem. Our twin wheel castors have an easy glide action and are available with or without brakes. Industrial castors are ideal for office furniture, shopfitting, and catering. Our industrial castors may also be used with light-duty medical apparatus.



High Temperature Resistant Castors

- Phenolic wheels with steel or stainless steel housing
- Operating temperature up to 260°C
- Ideal for powder coating, bakery ovens and other applications where resistance to temperatures are required
- Good resistance to water and chemicals
- See pages 288 - 291

White Nylon Wheel, Stainless Steel Housing Castors

- Stainless steel housing resistant to corrosion and rust
- Ideal for catering and medical industries
- Excellent resistance to water and chemicals
- See page 286 - 287



32mm Light Duty Castor - Hooded

SR 1547

Black Nylon

- Spark eroded finish
- Easy glide action
- Choice of mounting stems

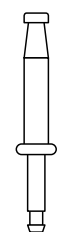

Gripneck

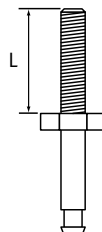

Threaded

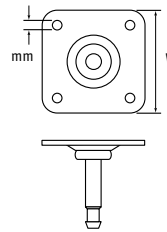

Plate

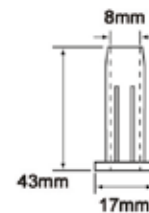

Plastic Socket

Part Number	Wheel Dia.	Hooded	Braked	Max. Static Load Bearing (kg)	Std Pack Qty
500300	32	Yes	No	30	150

Part Number	Type	Dimensions (mm)	Std Pack Qty
500318	Plate Fixing	35x35 (W)	150
500319	Threaded Stem	M8x15 (L)	150
500321	Threaded Stem	M8x25 (L)	150
500320	Gripneck Stem	38 (L)	150
500316	Plastic Socket for Gripneck Stem	-	900

40mm Twin Wheel Castor - Unhooded

SR 1547

Black Nylon

- Spark eroded finish
- Easy glide action
- Choice of mounting stems

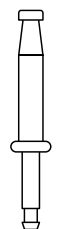

Gripneck

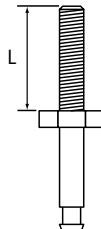

Threaded

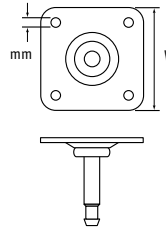

Plate

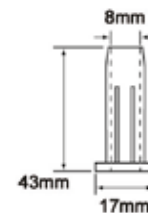

Plastic Socket

Part Number	Wheel Dia.	Hooded	Braked	Max. Static Load Bearing (kg)	Std Pack Qty
500301	40	No	No	50	150

Part Number	Type	Dimensions (mm)	Std Pack Qty
500323	Plate Fixing	35x35 (W)	150
500322	Threaded Stem	M8x15 (L)	150
500325	Threaded Stem	M8x25 (L)	150
500324	Gripneck Stem	38 (L)	150
500316	Plastic Socket for Gripneck Stem	-	900

The weight loadings quoted in this catalogue are for guide purposes only and assume that castors are used in a normal operating environment with floors in a smooth and reasonable condition.

Uneven or irregular floors will cause increased shock loadings. Castors of higher load-bearing capacity must be specified in these situations.

Castor loading capacity can be seriously impaired if castors are misused or poorly maintained, e.g. if used outside normal operating temperatures and/or if used in caustic environments.

40mm Twin Wheel Castor - Hooded

SR 1547

Black Nylon

- Spark eroded finish
- Easy glide action
- Choice of mounting stems
- Standard and heavy duty version available



40mm Hooded Twin Wheel Castors

Part Number	Wheel Dia.	Hooded	Braked	Max. Static Load Bearing (kg)	Std Pack Qty
500302	40	Yes	No	44	150
500303	40	Yes	Yes	44	150
500304	40	Yes	No	50	150
500305	40	Yes	Yes	50	150

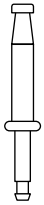

Gripneck

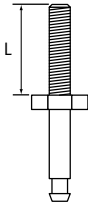

Threaded

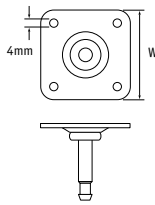

Plate

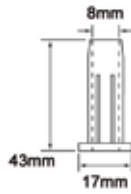

Plastic Socket

40mm Hooded Twin Wheel Castor Fittings

Part Number	Type	Dimensions (mm)	Std Pack Qty
500318	Plate Fixing	35x35 (W)	150
500319	Threaded Stem	M8x15 (L)	150
500321	Threaded Stem	M8x25 (L)	150
500320	Gripneck Stem	38 (L)	150
500316	Plastic Socket for Gripneck Stem	-	900

50mm Twin Wheel Castor - Hooded

SR 1547

Black Nylon

- Spark eroded finish
- Easy glide action
- Choice of mounting stems
- Standard and heavy duty version available



50mm Hooded Twin Wheel Castors

Part Number	Wheel Dia.	Hooded	Braked	Max. Static Load Bearing (kg)	Std Pack Qty
500306	50	Yes	No	60	100
500307	50	Yes	Yes	60	100
500308	50	Yes	No	80	100
500309	50	Yes	Yes	80	100



Gripneck

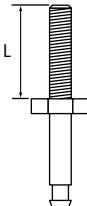

Threaded

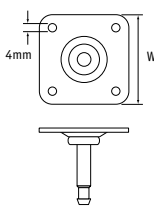

Plate

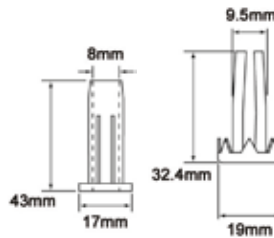

Plastic Socket

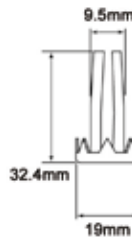

Metal Socket

50mm Hooded Twin Wheel Castor Fittings

Part Number	Type	Dimensions (mm)	Std Pack Qty
500311	Plate Fixing	38x38 (W)	100
500310	Threaded Stem	M8x15 (L)	100
500313	Threaded Stem	M8x25 (L)	100
500314	Threaded Stem	M10x15 (L)	100
500315	Threaded Stem	M10x25 (L)	100
500312	Grip Neck Stem	38 (L)	100
500316	Plastic Socket for Gripneck Stem	-	900
500317	Metal Socket for Gripneck Stem	-	300

The weight loadings quoted in this catalogue are for guide purposes only and assume that castors are used in a normal operating environment with floors in a smooth and reasonable condition.

Uneven or irregular floors will cause increased shock loadings. Castors of higher load-bearing capacity must be specified in these situations.

Castor loading capacity can be seriously impaired if castors are misused or poorly maintained, e.g. if used outside normal operating temperatures and/or if used in caustic environments.

Black Plastic Twinwheel Castors with Bolt Hole Fitting

SR 5627

- For applications where a low level strong castor is required
- Swivel pressed steel housing with double ball race and bolt hole fitting
- Braked and unbraked available
- Zinc plated steel housing



Unbraked



Braked

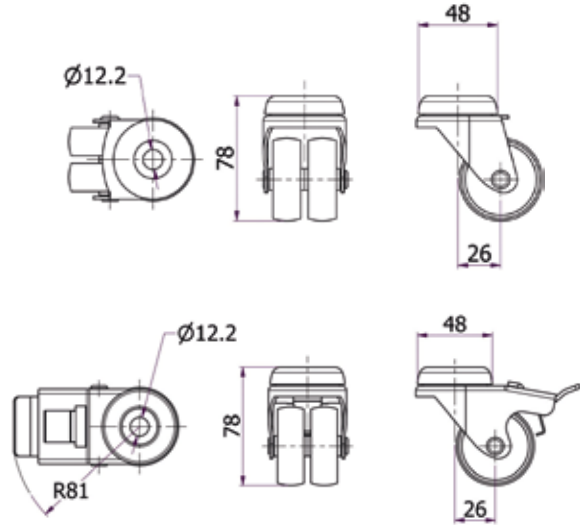

Part Number	Wheel Dia.	Approximate Load Capacity (kg)	Braked	Std Pack Qty
491131	50	70	No	40
491132	50	70	Yes	40

Black Plastic Twinwheel Castors with Threaded Stem

SR 5628

- For applications where a low level strong castor is required
- Swivel pressed steel housing with double ball race and bolt hole fitting
- Braked and unbraked available
- Zinc plated steel housing



Unbraked



Braked

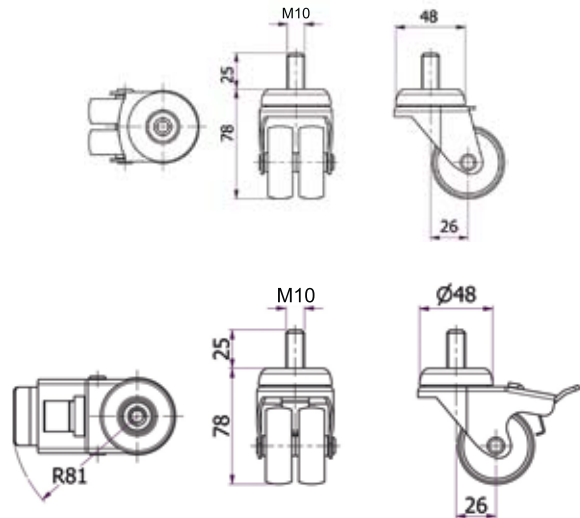

Part Number	Dimensions (mm)		Thread Size	Approximate Load Capacity (kg)	Braked	Std Pack Qty
	Wheel Dia.	Thread Length (mm)				
491133	50	25	M10	70	No	36
491134	50	25	M10	70	Yes	36

Black Plastic Twinwheel Castors with Swivel Plate Fitting

SR 5658

- Ideal for electronic cabinets or shopfitting applications
- For applications where a low level strong castor is required
- Swivel pressed steel housing with double ball race and swivel plate fitting
- Braked and unbraked available
- Zinc plated steel housing

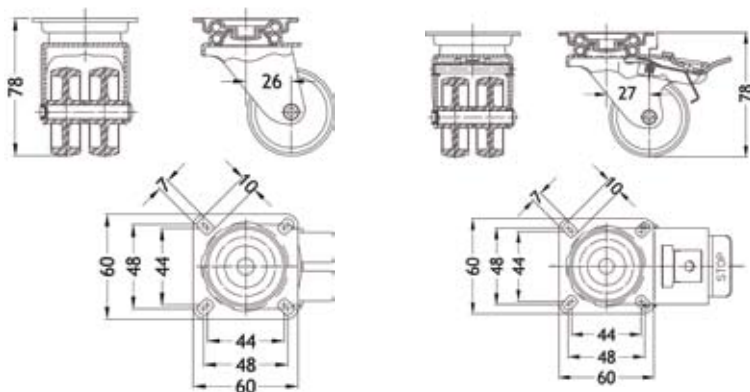

Part Number	Wheel Dia.	Approximate Load Capacity (kg)	Braked	Std Pack Qty
494759	50	70	No	40
494760	50	70	Yes	36



Machine Feet and Inserts

Please see pages 296-300

Black Plastic Wheel Swivel Plate Unbraked Castors

SR 5646

Black Plastic Wheel, Zinc Plated Housing

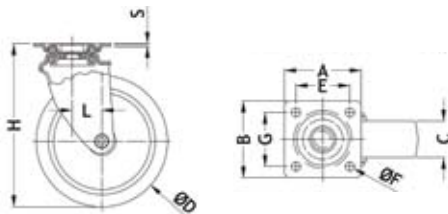

NEW

- Suitable for light weight medical equipment, display cabinets and point-of-sale applications

Part Number	Dimensions (mm)								Approximate Load Capacity (kg)	Std Pack Qty
	D	A X B	E X G	C	F	H	L	S		
494721	40	47 x 47	33 x 33	17.5	5.5	62	18.5	1.5	25	110
494722	50	47 x 47	33 x 33	17.0	5.5	67	18.5	1.5	35	100
494723	60	47 x 47	33 x 33	21.5	5.5	79	18.5	1.5	40	80
494724	80	47 x 47	33 x 33	20.0	5.5	99	18.0	1.5	50	50

Black Plastic Wheel Swivel Plate Braked Castors

SR 5647

Black Plastic Wheel, Zinc Plated Housing

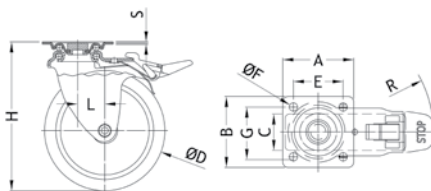

NEW

- Suitable for light weight medical equipment, display cabinets and point-of-sale applications

Part Number	Dimensions (mm)									Approximate Load Capacity (kg)	Std Pack Qty
	D	A X B	E X G	C	F	H	L	S	R		
494725	50	47 x 47	33 x 33	17.0	5.5	67.5	27.0	1.5	77	35	80
494726	60	47 x 47	33 x 33	21.5	5.5	79.0	24.5	1.5	77	40	60
494727	80	47 x 47	33 x 33	20.0	5.5	99.0	23.0	1.5	77	50	40

Black Plastic Wheel Bolt Hole Unbraked Castors

SR 5648

Black Plastic Wheel, Zinc Plated Housing

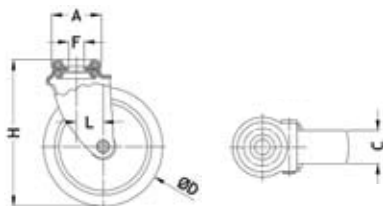

NEW

- Suitable for light weight medical equipment, display cabinets and point-of-sale applications

Part Number	Dimensions (mm)						Approximate Load Capacity (kg)	Std Pack Qty
	D	A	C	F	H	L		
494728	40	33.5	17.5	10	62.5	18.5	25	125
494729	50	33.5	17.0	10	67.5	18.5	35	110
494730	60	33.5	21.5	10	79.0	18.5	40	80
494731	80	33.5	20.0	10	97.0	18.0	50	50

Black Plastic Wheel Bolt Hole Braked Castors

SR 5649

Black Plastic Wheel, Zinc Plated Housing

- Suitable for light weight medical equipment, display cabinets and point-of-sale applications

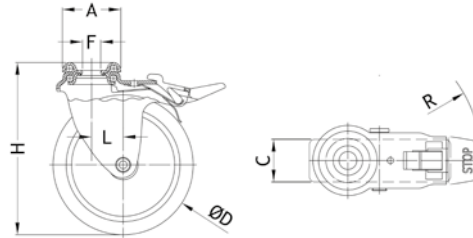

Part Number	Dimensions (mm)								Approximate Load Capacity (kg)	Std Pack Qty
	A	C	D	F	H	L	R			
494732	33.5	17.0	50	10	67.5	27.0	77	35	90	
494733	33.5	21.5	60	10	79.0	24.5	77	40	60	
494734	33.5	20.0	80	10	99.0	23.0	77	50	40	

Grey Synthetic Rubber Swivel Plate Braked Castors

SR 5651

Grey Synthetic Rubber, Zinc Plated Housing

- Suitable for light weight medical equipment, display cabinets and point-of-sale applications
- Plastic rubber tyre not resistant to contact with greases, oils or chloride

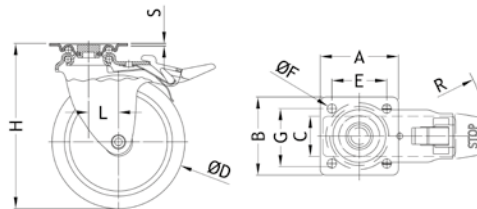

Part Number	Dimensions (mm)									Approximate Load Capacity (kg)	Std Pack Qty
	D	A X B	E X G	C	F	H	L	R	S		
494739	50	47 x 47	33 x 33	18.5	5.5	67.5	27.0	77	1.5	35	80
494740	63	47 x 47	33 x 33	21.5	5.5	80.5	24.5	77	1.5	40	60
494741	80	47 x 47	33 x 33	22.0	5.5	99.0	23.0	77	1.5	50	40

Grey Synthetic Rubber Swivel Plate Unbraked Castors

SR 5650

Grey Synthetic Rubber, Zinc Plated Housing

- Suitable for light weight medical equipment, display cabinets and point-of-sale applications
- Plastic rubber tyre not resistant to contact with greases, oils or chloride

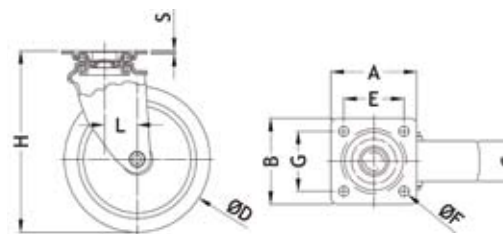

Part Number	Dimensions (mm)									Approximate Load Capacity (kg)	Std Pack Qty
	D	A X B	E X G	C	F	H	L	S			
494735	40	47 x 47	33 x 33	18.5	5.5	62	18.5	1.5	25	100	
494736	50	47 x 47	33 x 33	18.5	5.5	67	18.5	1.5	35	95	
494737	63	47 x 47	33 x 33	21.5	5.5	80	18.5	1.5	40	70	
494738	80	47 x 47	33 x 33	22.0	5.5	99	18.0	1.5	50	40	

Grey Synthetic Rubber Bolt Hole Unbraked Castors

SR 5652

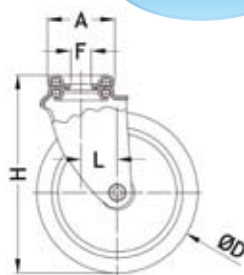

NEW

Grey Synthetic Rubber, Zinc Plated Housing

- Suitable for light weight medical equipment, display cabinets and point-of-sale applications
- Plastic rubber tyre not resistant to contact with greases, oils or chloride

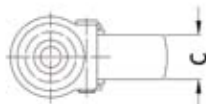

Part Number	Dimensions (mm)						Approximate Load Capacity (kg)	Std Pack Qty
	D	A	C	F	H	L		
494742	40	33.5	18.5	10	62.5	18.5	25	120
494743	50	33.5	18.5	10	67.5	18.5	35	100
494744	63	33.5	21.5	10	80.5	18.5	40	75
494745	80	33.5	22.0	10	99.0	18.0	50	40

Grey Synthetic Rubber Bolt Hole Braked Castors

SR 5653

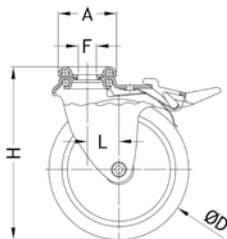

NEW

Grey Synthetic Rubber, Zinc Plated Housing

- Suitable for light weight medical equipment, display cabinets and point-of-sale applications
- Plastic rubber tyre not resistant to contact with greases, oils or chloride

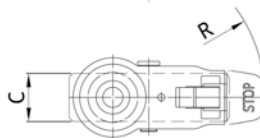

Part Number	Dimensions (mm)							Approximate Load Capacity (kg)	Std Pack Qty
	D	A	C	F	H	L	R		
494746	50	33.5	18.5	10	67.5	27.0	77	35	80
494747	63	33.5	21.5	10	80.5	24.5	77	40	60
494748	80	33.5	22.0	10	99.0	23.0	77	50	40

Red Polyurethane Tyre Swivel Plate Unbraked Castors

SR 5654

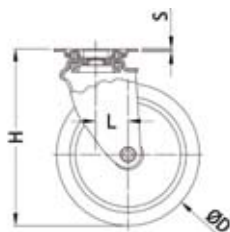

NEW

Red Polyurethane Tyre, Zinc Plated Housing

- Suitable for light weight applications such as medical equipment, display cabinets and point-of-sale stands
- Good resistant to wear, greases and petroleum byproducts

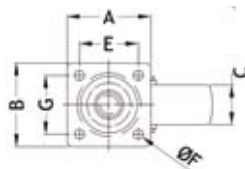

Part Number	Dimensions (mm)									Approximate Load Capacity (kg)	Std Pack Qty
	D	A X B	E X G	C	F	H	L	S			
494749	40	47 x 47	33 x 33	18.5	5.5	62.5	18.5	1.5	25	90	
494750	50	47 x 47	33 x 33	18.5	5.5	67.5	18.5	1.5	35	80	
494751	63	47 x 47	33 x 33	21.5	5.5	80.5	18.5	1.5	40	60	

Red Polyurethane Tyre Swivel Plate Braked Castors

SR 5655

Red Polyurethane Tyre, Zinc Plated Housing

- Suitable for light weight applications such as medical equipment, display cabinets and point-of-sale stands
- Good resistant to wear, greases and petroleum byproducts

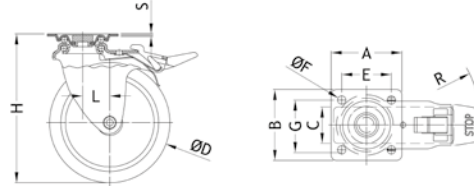

Part Number	Dimensions (mm)										Approximate Load Capacity (kg)	Std Pack Qty
	D	A X B	E X G	C	F	H	L	R	S			
494752	50	47 x 47	33 x 33	18.5	5.5	67.5	27.0	77	1.5	35	68	
494753	63	47 x 47	33 x 33	21.5	5.5	80.5	24.5	77	1.5	40	52	

Red Polyurethane Tyre Bolt Hole Unbraked Castors

SR 5656

Red Polyurethane Tyre, Zinc Plated Housing

- Suitable for light weight applications such as medical equipment, display cabinets and point-of-sale stands
- Good resistant to wear, greases and petroleum byproducts

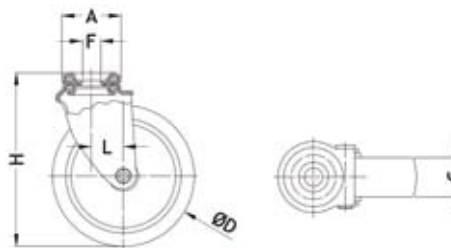

Part Number	Dimensions (mm)							Approximate Load Capacity (kg)	Std Pack Qty
	D	A	C	F	H	L			
494754	40	33.5	17.5	10	62.5	18.5	25	110	
494755	50	33.5	17.0	10	67.5	18.5	35	100	
494756	63	33.5	21.5	10	80.5	18.5	40	75	

Red Polyurethane Tyre Bolt Hole Braked Castors

SR 5657

Red Polyurethane Tyre, Zinc Plated Housing

- Suitable for light weight applications such as medical equipment, display cabinets and point-of-sale stands
- Good resistant to wear, greases and petroleum byproducts

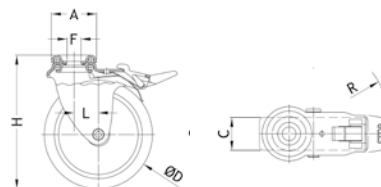

Part Number	Dimensions (mm)								Approximate Load Capacity (kg)	Std Pack Qty
	D	A	C	F	H	L	R			
494757	50	33.5	18.5	10	67.5	27.0	77	35	80	
494758	63	33.5	21.5	10	80.5	24.5	77	40	60	

Nylon Wheel Bolt Hole Unbraked Castors

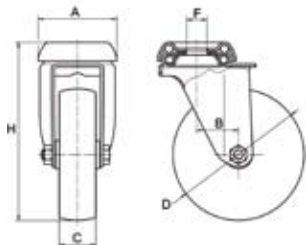

SR 5600

Nylon Wheel, Zinc Plated Steel Housing

- Ideal for display units, restaurant equipment, trolleys, office & medical equipment
- Good resistance to abrasion, petroleum & chemical agents
- Double ball race swivel action
- Swivel pressed steel housing with bolt-hole fitting

Part Number	Dimensions (mm)							Approximate Load Capacity (kg)	Std Pack Qty
	D	A	B	C	F	H			
490995	50	48	26	18	12	70	55	48	
490996	60	48	26	22	12	90	60	40	
490997	75	48	25	23	12	106	60	36	
490998	80	48	25	22	12	109	60	36	
490999	100	57	36	27	12	134	80	16	
491000	125	57	35	27	12	159	80	12	

Nylon Wheel Bolt Hole Braked Castors

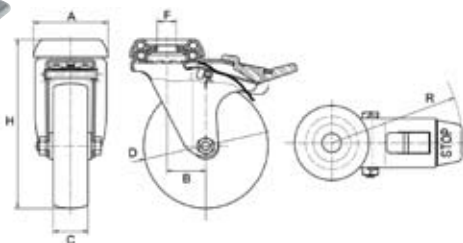

SR 5601

Nylon Wheel, Zinc Plated Steel Housing

- Ideal for display units, restaurant equipment, trolleys, office & medical equipment
- Good resistance to abrasion, petroleum & chemical agents
- Double ball race swivel action
- Swivel pressed steel housing with bolt-hole fitting
- Total stop brake locks wheel and swivel

Part Number	Dimensions (mm)							Approximate Load Capacity (kg)	Std Pack Qty
	A	B	C	D	F	H	R		
491001	48	26	18	50	12	70	80	55	48
491002	48	28	22	60	12	90	84	60	40
491003	48	25	23	75	12	106	84	60	36
491004	48	25	23	80	12	109	84	60	36
491005	57	35	27	100	12	134	106	80	16
491006	57	33	27	125	12	159	106	80	12

Tube Fittings

Please see pages
322-336

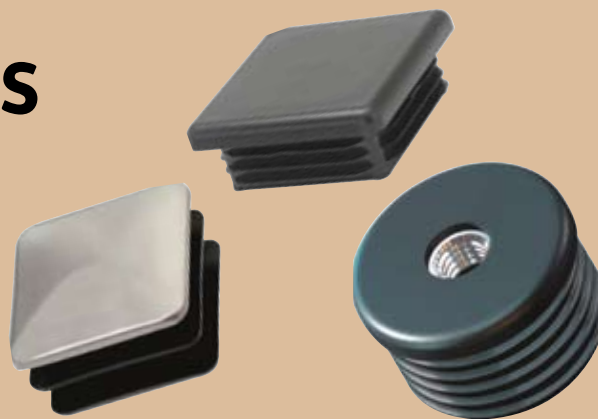

Nylon Wheel Fixed Plate Castors

SR 5602

Nylon Wheel, Zinc-Plated Steel Housing

- Ideal for display units, restaurant equipment, trolleys, office & medical equipment
- Good resistance to abrasion, petroleum & chemical agents
- Fixed plate steel housing with square plate fitting

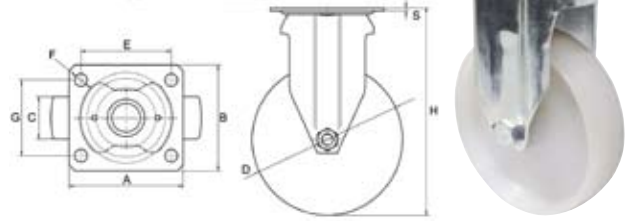

Part Number	Dimensions (mm)								Approximate Load Capacity (kg)	Std Pack Qty
	D	A X B	E X G	C	F	H	S			
491007	50	60 x 60	45 x 45	18	6.5	70	2	55	48	
491008	60	60 x 60	45 x 45	22	6.5	90	2	60	40	
491009	75	60 x 60	45 x 45	23	6.5	106	2	60	36	
491010	80	60 x 60	45 x 45	22	6.5	109	2	60	36	
491011	100	76 x 70	60 x 50	27	8.3	134	2	80	14	

Nylon Wheel Swivel Plate Unbraked Castors

SR 5603

Nylon Wheel, Zinc-Plated Steel Housing

- Ideal for display units, restaurant equipment, trolleys, office & medical equipment
- Good resistance to abrasion, petroleum & chemical agents
- Double ball race swivel action

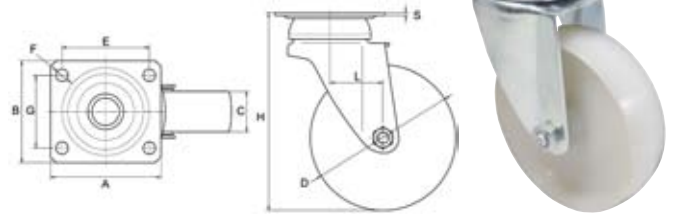

Part Number	Dimensions (mm)								Approximate Load Capacity (kg)	Std Pack Qty
	D	A X B	E X G	C	F	H	L	S		
491012	50	60 x 60	45 x 45	18	6.5	70	26	2	55	48
491013	60	60 x 60	45 x 45	22	6.5	90	26	2	60	36
491014	75	60 x 60	45 x 45	23	6.5	106	25	2	60	28
491015	80	60 x 60	45 x 45	22	6.5	109	25	2	60	28
491016	100	76 x 70	60 x 50	27	8.3	134	36	2	80	16
491017	125	76 x 70	60 x 50	27	8.3	159	35	2	80	14

Nylon Wheel Swivel Plate Braked Castors

SR 5604

Nylon Wheel, Zinc-Plated Steel Housing

- Ideal for display units, restaurant equipment, trolleys, office & medical equipment
- Good resistance to abrasion, petroleum & chemical agents
- Double ball race swivel action
- Total stop brake locks wheel & swivel

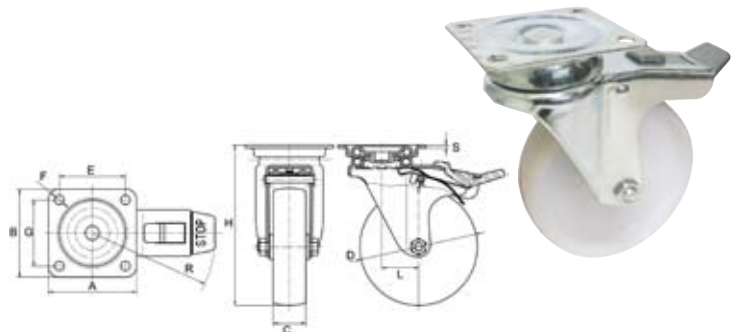

Part Number	Dimensions (mm)										Approximate Load Capacity (kg)	Std Pack Qty
	D	A X B	E X G	C	F	H	L	S	R			
491018	50	60 x 60	45 x 45	18	6.5	70	26	2	80	55	48	
491019	60	60 x 60	45 x 45	22	6.5	90	26	2	84	60	36	
491020	75	60 x 60	45 x 45	23	6.5	106	25	2	84	60	28	
491021	80	60 x 60	45 x 45	22	6.5	109	25	2	84	60	28	
491022	100	76 x 70	60 x 50	27	8.3	134	36	2	106	80	16	
491023	125	76 x 70	60 x 50	27	8.3	159	35	2	106	80	14	

Natural Rubber Tyre Bolt Hole Unbraked Castors

SR 5605

Natural Rubber Tyre, Zinc-Plated Steel Housing

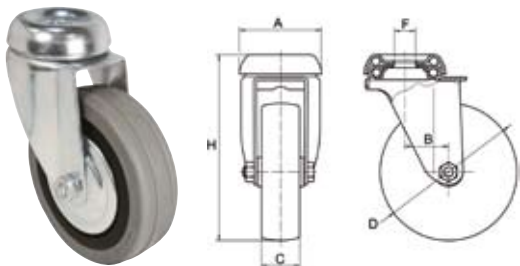

- Suitable for medical equipment, display cabinets, point-of-sale, educational furniture, computer & office furniture
- Natural grey rubber tyre not resistant to contact with greases, oils or chloride
- Swivel pressed steel housing with double ball race and bolt-hole fitting
- Comes with threadguards as standard

Part Number	Dimensions (mm)							Approximate Load Capacity (kg)	Std Pack Qty
	D	A	B	C	F	H			
491024	60	48	26	20	12	90	60	40	
491025	80	48	25	22	12	109	60	32	
491026	100	57	36	28	12	134	80	16	
491027	125	57	35	28	12	159	80	14	

Natural Rubber Tyre Bolt Hole Braked Castors

SR 5606

Natural Rubber Tyre, Zinc-Plated Steel Housing

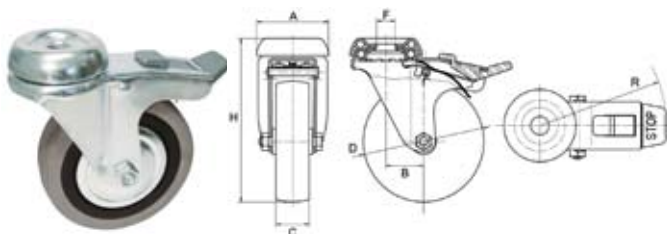

- Suitable for medical equipment, display cabinets, point-of-sale, educational furniture, computer & office furniture
- Natural grey rubber tyre not resistant to contact with greases, oils or chloride
- Swivel pressed steel housing with double ball race and bolt-hole fitting
- Comes with threadguards as standard
- Total stop brake locks wheel and swivel

Part Number	Dimensions (mm)							Approximate Load Capacity (kg)	Std Pack Qty
	D	A	B	C	F	H	R		
491028	60	48	28	20	12	90	84	60	40
491029	80	48	25	22	12	109	84	60	32
491030	100	57	35	28	12	134	106	80	16
491031	125	57	33	28	12	159	106	80	14

Adjustable Levelling Feet

Please see pages
301-308



Natural Rubber Tyre Fixed Plate Castors

SR 5607

Natural Rubber Tyre, Zinc-Plated Steel Housing

- Suitable for medical equipment, display cabinets, point-of-sale, educational furniture, computer & office furniture
- Natural grey rubber tyre not resistant to contact with greases, oils and chloride
- Comes with threadguards as standard

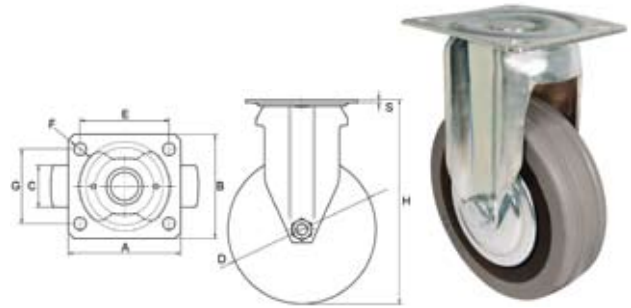

Part Number	Dimensions (mm)									Approximate Load Capacity (kg)	Std Pack Qty
	D	A	B	C	E	G	F	H	S		
491032	60	60	60	20	45	45	6.5	90	2	60	40
491033	80	60	60	22	45	45	6.5	109	2	60	32
491034	100	76	70	28	60	50	8.3	134	2	80	16

Natural Rubber Tyre Swivel Plate Unbraked Castors

SR 5608

Natural Rubber Tyre, Zinc-Plated Steel Housing

- Suitable for medical equipment, display cabinets, point-of-sale, educational furniture, computer & office furniture
- Natural grey rubber tyre not resistant to contact with greases, oils or chloride
- Swivel pressed steel housing with double ball race and bolt-hole fitting
- Comes with threadguards as standard
- Total stop brake locks wheel and swivel

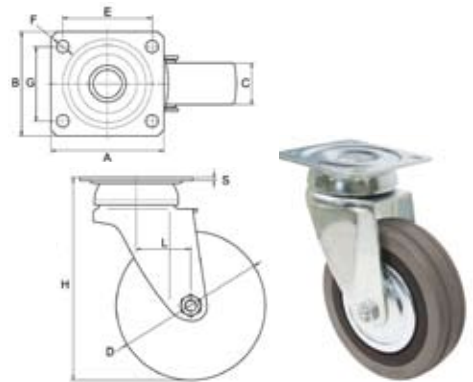

Part Number	Dimensions (mm)									Approximate Load Capacity (kg)	Std Pack Qty
	D	A	B	C	E	G	F	H	S		
491035	60	60	60	20	45	45	6.5	90	2	60	36
491036	80	60	60	22	45	45	6.5	109	2	60	32
491037	100	76	70	28	60	50	8.3	134	2	80	16
491038	125	76	70	28	60	50	8.3	159	2	80	14

Natural Rubber Tyre Swivel Plate Braked Castors

SR 5609

Natural Rubber Tyre, Zinc-Plated Steel Housing

- Suitable for medical equipment, display cabinets, point of sale, educational furniture, computer & office furniture
- Natural grey rubber tyre not resistant to contact with greases, oils & chloride
- Pressed steel housing with double ball race and swivel plate fitting
- Comes with threadguards as standard
- Total stop brake locks swivel and wheel



Part Number	Dimensions (mm)									Approximate Load Capacity (kg)	Std Pack Qty
	D	A	B	C	E	G	F	H	R		
491039	60	60	60	20	45	45	12	90	84	60	40
491040	80	60	60	22	45	45	12	109	84	60	32
491041	100	76	70	28	60	50	12	134	106	80	16
491042	125	76	70	28	60	50	12	159	106	80	14

Synthetic Rubber Tyre Bolt Hole Unbraked Castors

SR 5610

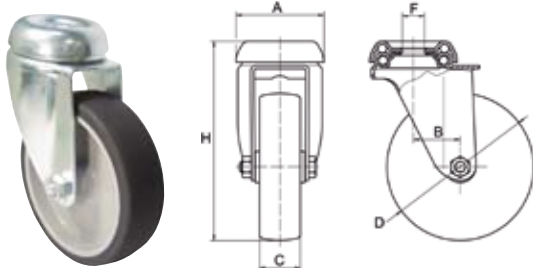

Synthetic Rubber Tyre, Zinc-Plated Steel Housing

- Suitable for medical equipment, display cabinets, point-of-sale, educational furniture, computer & office furniture
- Thermoplastic rubber tyre not resistant to contact with greases, oils or chloride
- Swivel pressed steel housing with double ball race and bolt-hole fitting

Part Number	Dimensions (mm)							Approximate Load Capacity (kg)	Std Pack Qty
	D	A	B	C	F	H			
491043	50	48	26	18	12	70	40	52	
491044	63	48	26	22	12	90	60	40	
491045	75	48	25	24	12	106	60	32	
491046	80	48	25	22	12	109	60	32	
491047	100	57	36	27	12	134	80	16	
491048	125	57	35	27	12	159	80	16	

Synthetic Rubber Tyre Bolt Hole Braked Castors

SR 5611

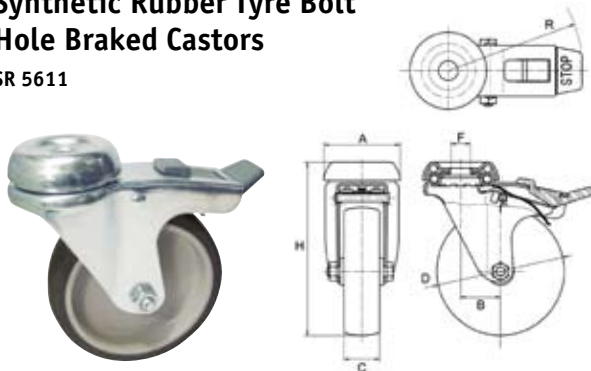

Synthetic Rubber Tyre, Zinc-Plated Steel Housing

- Applications - Medical equipment, display cabinets, point-of-sale, educational furniture, computer & office furniture
- Thermoplastic rubber tyre not resistant to contact with greases, oils or chloride
- Swivel pressed steel housing with double ball race and bolt-hole fitting
- Total stop brake locks wheel and swivel

Part Number	Dimensions (mm)								Approximate Load Capacity (kg)	Std Pack Qty
	D	A	B	C	F	H	R			
491049	50	48	26	18	12	70	80	40	52	
491050	63	48	28	22	12	90	84	60	40	
491051	75	48	25	24	12	106	51	60	32	
491052	80	48	25	22	12	109	84	60	32	
491053	100	57	35	27	12	134	106	80	16	
491054	125	57	33	27	12	159	106	80	16	

For a complete range of
Drawer Slides, see page 205.



All Available
from Stock!

Synthetic Rubber Tyre Fixed Plate Castors

SR 5612

Synthetic Rubber Tyre, Zinc-Plated Steel Housing

- Suitable for medical equipment, display cabinets, point-of-sale, educational furniture, computer & office furniture
- Thermoplastic rubber tyre not resistant to contact with greases, oils or chloride

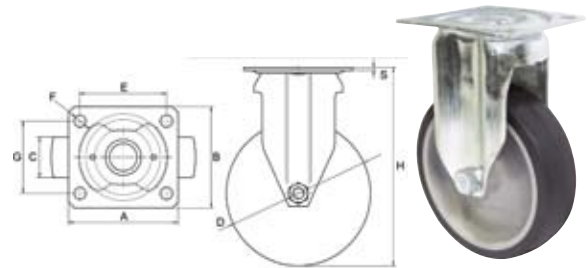

Part Number	Dimensions (mm)								Approximate Load Capacity (kg)	Std Pack Qty
	D	A X B	E X G	C	F	H	S			
491055	50	60 x 60	45 x 45	18	6.5	70	2	40	52	
491056	63	60 x 60	45 x 45	22	6.5	90	2	60	40	
491057	75	60 x 60	45 x 45	24	6.5	106	2	60	32	
491058	80	60 x 60	45 x 45	22	6.5	109	2	60	32	
491059	100	76 x 70	60 x 50	27	8.3	134	2	80	16	

Synthetic Rubber Tyre Swivel Plate Unbraked Castors

SR 5613

Synthetic Rubber Tyre, Zinc-Plated Steel Housing

- Suitable for medical equipment, display cabinets, point-of-sale, educational furniture, computer & office furniture
- Thermoplastic rubber tyre not resistant to contact with greases, oils or chloride
- Zinc plated, pressed steel housing with double ball race and swivel plate fitting

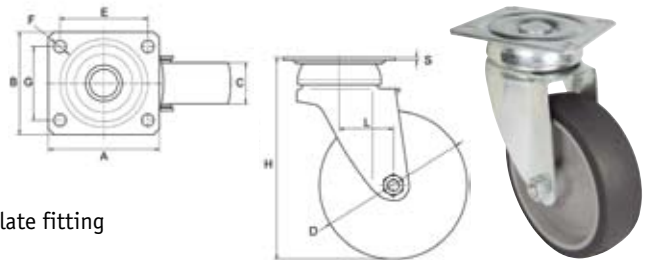

Part Number	Dimensions (mm)								Approximate Load Capacity (kg)	Std Pack Qty
	D	A X B	E X G	C	F	H	S			
491060	50	60 x 60	45 x 45	18	6.5	70	2	40	52	
491061	63	60 x 60	45 x 45	22	6.5	90	2	60	40	
491062	75	60 x 60	45 x 45	24	6.5	106	2	60	32	
491063	80	60 x 60	45 x 45	22	6.5	109	2	60	32	
491064	100	76 x 70	60 x 50	27	8.3	134	2	80	16	
491065	125	76 x 70	60 x 50	27	8.3	159	2	80	14	

Synthetic Rubber Tyre Swivel Plate Braked Castors

SR 5614

Synthetic Rubber Tyre, zinc-Plated Steel Housing

- Suitable for medical equipment, display cabinets, point-of-sale, educational furniture, computer & office furniture
- Thermoplastic rubber tyre not resistant to contact with greases, oils or chloride
- Pressed steel housing with double ball race & swivel plate fitting
- Total stop brake locks swivel and wheel

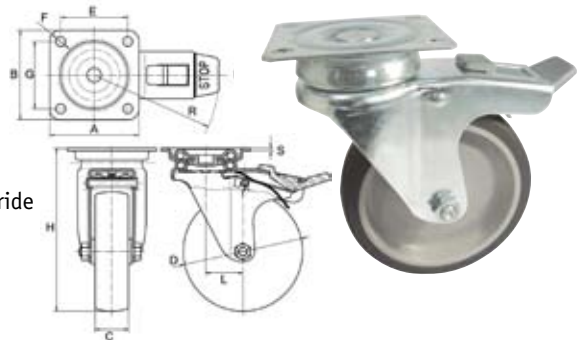

Part Number	Dimensions (mm)										Approximate Load Capacity (kg)	Std Pack Qty
	D	A X B	E X G	C	F	H	L	S	R			
491066	50	60 x 60	45 x 45	18	6.5	70	26	2	80	40	52	
491067	63	60 x 60	45 x 45	22	6.5	90	28	2	84	60	40	
491068	75	60 x 60	45 x 45	24	6.5	106	25	2	84	60	32	
491069	80	60 x 60	45 x 45	22	6.5	109	25	2	84	60	32	
491070	100	76 x 70	60 x 50	27	8.3	134	35	2	106	80	16	
491071	125	76 x 70	60 x 50	27	8.3	159	33	2	106	80	14	

Medium Duty Nylon Wheel Bolt Hole Unbraked Castors

SR 5662



Nylon Wheel, Zinc Plated Steel Housing

- Ideal for trolleys, roll cages and material handling applications

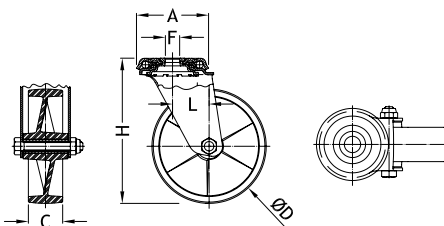

Part Number	Dimensions (mm)							Approximate Load Capacity (kg)	Std Pack Qty
	D	C	A	F	H	L			
494773	80	30	64	12	108	32		100	20
494774	100	30	64	12	127	32		120	16
494775	125	39	64	12	155	31		120	12

Medium Duty Nylon Wheel Bolt Hole Braked Castors

SR 5663



Nylon Wheel, Zinc Plated Steel Housing

- Ideal for trolleys, roll cages and material handling applications

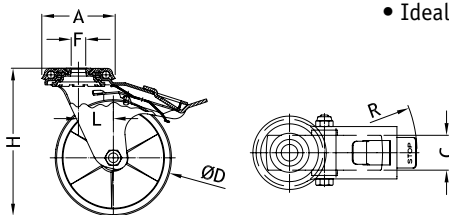

Part Number	Dimensions (mm)							Approximate Load Capacity (kg)	Std Pack Qty
	D	C	A	F	H	L	R		
494776	80	30	64	12	108	32	110	100	16
494777	100	30	64	12	127	32	110	120	14
494778	125	39	64	12	155	31	113	120	12

Buy any quantity!

**SPLIT PACKS
AVAILABLE**



Medium Duty Nylon Wheel Swivel Plate Unbraked Castors

NEW

SR 5659

Nylon Wheel, Zinc Plated Steel Housing

- Ideal for trolleys, roll cages and material handling applications

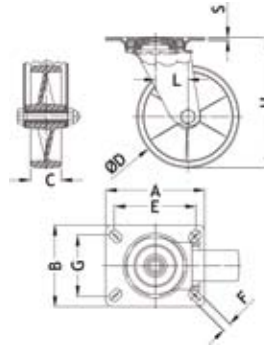

Part Number	Dimensions (mm)									Approximate Load Capacity (kg)	Std Pack Qty
	D	A X B	E X G	C	F	H	L	S			
494761	80	95 X 80	80 X 60	30	9	108	32	2.5	100	20	
494762	100	95 X 80	80 X 60	30	9	127	32	2.5	120	16	
494763	125	95 X 80	80 X 60	39	9	155	31	2.5	150	10	
494764	150	118 X 86	80 X 60	40	9	184	48	3.0	180	6	

Medium Duty Nylon Wheel Swivel Plate Braked Castors

NEW

SR 5660

Nylon Wheel, Zinc Plated Steel Housing

- Ideal for trolleys, roll cages and material handling applications

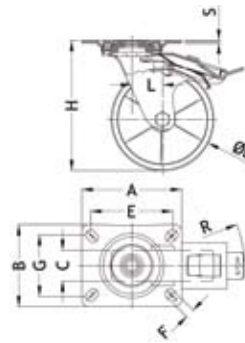

Part Number	Dimensions (mm)										Approximate Load Capacity (kg)	Std Pack Qty
	D	A X B	E X G	C	F	H	L	R	S			
494765	80	95 x 80	80 x 60	30.0	9	108	32	110	2.5	100	16	
494766	100	95 x 80	80 x 60	30.0	9	127	32	110	2.5	120	14	
494767	125	95 x 80	80 x 60	39.0	9	155	31	113	2.5	150	8	
494768	150	118 x 86	80 x 60	40.0	9	184	48	130	3.0	180	6	

Medium Duty Nylon Wheel Fixed Plate Castors

NEW

SR 5661

Nylon Wheel, Zinc Plated Steel Housing

- Ideal for trolleys, roll cages and material handling applications

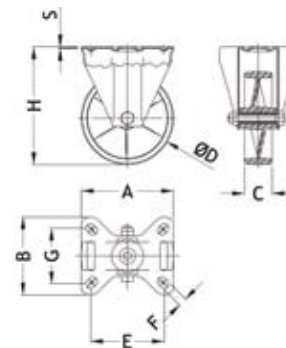

Part Number	Dimensions (mm)									Approximate Load Capacity (kg)	Std Pack Qty
	D	A	B	C	E	G	F	H	S		
494769	80	100	84	30	80	60	9	108	1.8	100	16
494770	100	100	84	30	80	60	9	127	1.8	120	12
494771	125	100	84	39	80	60	9	155	1.8	150	10
494772	150	116	84	40	80	60	9	184	2.0	180	6

Industrial Castors - Black Rubber Tyre, Plastic Centre, Fixed Plate

SR 5615

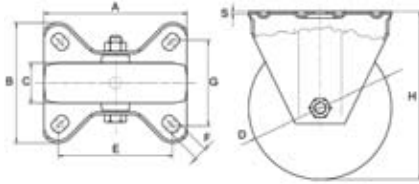

Natural Rubber Tyre, Zinc-Plated Steel Housing, Plastic Wheel Centre

- Suitable for heavier duty applications such as trolleys, cabinets, waste equipment & workstations
- Black rubber tyre not resistant to grease, oils, chlorides & solvents

Part Number	Dimensions (mm)								Approximate Load Capacity (kg)	Std Pack Qty
	D	A X B	E X G	C	F	H	S			
491072	80	100 x 84	80 x 60	25.0	9	108	1.8	50	16	
491073	100	100 x 84	80 x 60	30.0	9	127	1.8	70	14	
491074	125	116 x 84	80 x 60	37.5	9	160	2.0	100	12	
491075	150	116 x 84	80 x 60	40.0	9	183	2.0	130	6	
491076	150	133 x 106	105 x 80	40.0	11	184	2.0	140	6	
491078	180	135 x 110	105 x 80	45.0	11	218	2.5	170	4	
491079	200	135 x 110	105 x 80	50.0	11	240	2.5	205	2	

Industrial Castors - Black Rubber Tyre, Plastic Centre, Swivel Plate

SR 5616

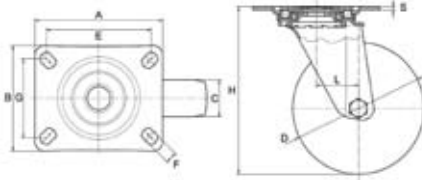

Natural Rubber Tyre, Zinc Plated Steel Housing, Plastic Wheel Centre

- Suitable for heavier duty applications such as trolleys, cabinets, waste equipment & workstations
- Black rubber tyre not resistant to grease, oils, chlorides & solvents
- Zinc plated pressed steel housing with swivel plate fitting

Part Number	Dimensions (mm)								Approximate Load Capacity (kg)	Std Pack Qty
	D	A X B	E X G	C	F	H	L	S		
491080	80	97 x 80	80 x 60	25.0	9	108	32	2.5	50	16
491081	100	97 x 80	80 x 60	30.0	9	127	32	2.5	70	14
491082	125	97 x 80	80 x 60	37.5	9	155	31	2.5	100	12
491084	150	117 x 85	80 x 60	40.0	11	184	47	3.0	130	6
491083	150	133 x 106	105 x 80	40.0	11	192	52	3.0	140	6
491085	180	129 x 106	105 x 80	45.0	11	230	48	3.0	170	4
491086	200	129 x 106	105 x 80	50.0	11	240	48	3.0	205	2

Industrial Castors - Black Rubber Tyre, Plastic Centre, Swivel Plate

Braked

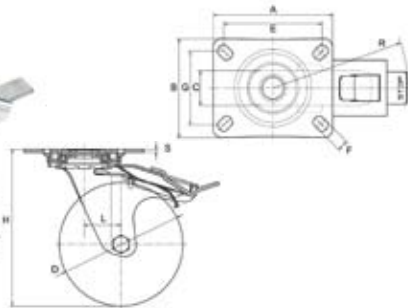

SR 5617

Natural Rubber Tyre, Zinc Plated Steel Housing, Plastic Wheel Centre

- Suitable for heavier duty applications such as trolleys, cabinets, waste equipment & workstations
- Black rubber tyre not resistant to grease, oils, chlorides & solvents
- Zinc plated pressed steel housing with swivel plate fitting
- Total stop brake locks both swivel and wheel

Part Number	Dimensions (mm)										Approximate Load Capacity (kg)	Std Pack Qty
	D	A X B	E X G	C	F	H	L	R	S			
491087	80	97 x 80	80 x 60	25.0	9	108	32	110	2.5	50	16	
491088	100	97 x 80	80 x 60	30.0	9	127	32	110	2.5	70	14	
491089	125	97 x 80	80 x 60	37.5	9	155	31	113	2.5	100	12	
491091	150	117 x 85	80 x 60	40.0	9	185	52	150	3.0	130	6	
491090	150	133 x 106	105 x 80	40.0	11	185	52	150	3.0	140	6	
491092	180	129 x 106	105 x 80	45.0	11	230	48	150	3.0	170	4	
491093	200	129 x 106	105 x 80	50.0	11	240	48	150	3.0	205	2	

Industrial Castors - Black Rubber Tyre, Steel Centre Fixed Plate

SR 5618

Natural Rubber Tyre, Zinc Plated Steel Housing and Wheel Centre

- Suitable for heavier duty applications such as trolleys, cabinets, waste equipment & workstations
- Black rubber tyre not resistant to grease, oils, chlorides & solvents
- Roller bearing for smooth motion

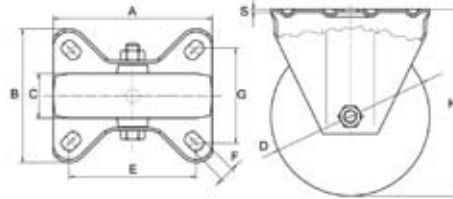

Part Number	Dimensions (mm)								Approximate Load Capacity (kg)	Std Pack Qty
	D	A X B	E X G	C	F	H	S			
491094	80	100 x 84	80 x 60	25.0	9	108	1.8	50	16	
491095	100	100 x 84	80 x 60	30.0	9	127	1.8	70	14	
491096	125	116 x 84	80 x 60	37.5	9	160	2.0	110	12	
491098	150	117 x 85	80 x 60	40.0	9	171	2.0	150	6	
491097	150	135 x 110	105 x 80	40.0	11	184	2.0	150	6	
491099	180	135 x 110	105 x 80	45.0	11	218	2.5	180	4	
491100	200	135 x 110	105 x 80	50.0	11	240	2.5	220	2	

Industrial Castors - Black Rubber Tyre, Steel Centre Swivel Plate

SR 5619

Natural Rubber Tyre, Zinc Plated Steel Housing and Wheel Centre

- Suitable for heavier duty applications such as trolleys, cabinets, waste equipment & workstations
- Zinc plated pressed steel housing with swivel plate fitting
- Roller bearing for smooth motion

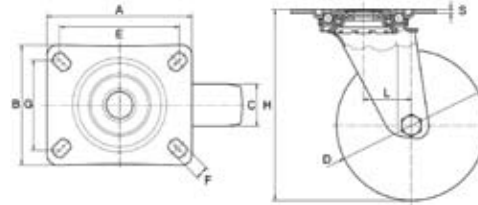

Part Number	Dimensions (mm)									Approximate Load Capacity (kg)	Std Pack Qty
	D	A X B	E X G	C	F	H	L	S			
491101	80	97 x 80	80 x 60	25.0	9	108	32	2.5	50	16	
491102	100	97 x 80	80 x 60	30.0	9	127	32	2.5	70	14	
491103	125	97 x 80	80 x 60	37.5	9	155	31	2.5	110	12	
491105	150	117 x 85	80 x 60	40.0	9	171	52	3.0	140	6	
491104	150	133 x 106	105 x 80	40.0	11	184	52	3.0	150	6	
491106	180	129 x 106	105 x 180	45.0	11	230	48	3.0	180	4	
491107	200	129 x 106	105 x 180	50.0	11	240	48	3.0	220	2	

Industrial Castors - Black Rubber Tyre, Steel Swivel Plate Braked

SR 5620

Natural Rubber Tyre, Zinc Plated Steel Housing & Wheel Centre

- Suitable for heavier duty applications such as trolleys, cabinets, waste equipment & workstations
- Roller bearing for smooth motion
- Total stop brake locks swivel and wheel

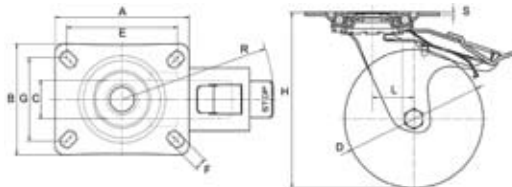

Part Number	Dimensions (mm)										Approximate Load Capacity (kg)	Std Pack Qty
	D	A X B	E X G	C	F	H	L	S	R			
491108	80	97 x 80	80 x 60	25.0	9.0	108	32	2.5	110	50	16	
491109	100	97 x 80	80 x 60	30.0	9.0	127	32	2.5	110	70	14	
491110	125	97 x 80	80 x 60	37.5	9.0	155	31	2.5	113	110	12	
491112	150	117 x 85	80 x 60	40.0	9.0	171	52	3.0	150	140	6	
491111	150	133 x 106	105 x 80	40.0	11.0	184	52	3.0	150	150	6	
491113	180	129 x 106	105 x 80	45.0	11.0	230	48	3.0	150	150	4	
491114	200	129 x 106	105 x 80	50.0	11.0	240	48	3.0	150	220	2	

Industrial Castors - Blue Rubber Tyre, Plastic Centre Swivel Plate

SR 5621

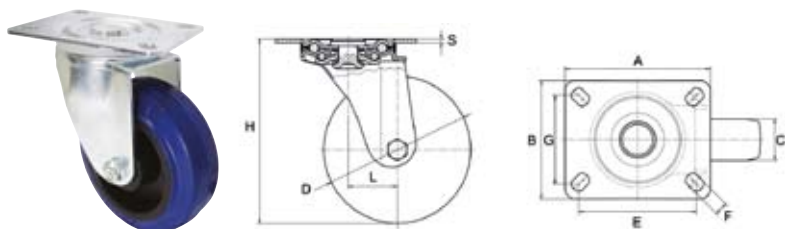

Natural Rubber Tyre, Steel Housing, Polyamide Centre

- Transport cases, catering equipment, flight cases, trolleys
- Non marking blue rubber tyre not resistant to contact with greases, oils & chloride
- Zinc plated pressed steel housing with double ball race and swivel plate fitting

Part Number	Dimensions (mm)									Approximate Load Capacity (kg)	Std Pack Qty
	D	A X B	E X G	C	F	H	L	S			
491115	80	99 x 80	80 x 60	36	9	108	32	2.5	100	12	
491116	100	99 x 80	80 x 60	36	9	127	32	2.5	150	12	
491117	125	99 x 80	80 x 60	36	9	160	47	2.5	200	8	

Industrial Castors - Blue Rubber Tyre, Plastic Centre Swivel Plate Braked

SR 5622

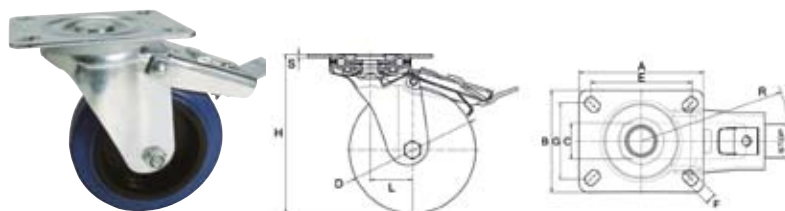

Natural Rubber Tyre, Steel Housing, Polyamide Centre

- Applications include transport cases, catering equipment, flight cases and trolleys
- Non marking blue rubber tyre
- Zinc plated pressed steel housing with double ball race and swivel plate fitting
- Total stop brake locks both swivel and wheel

Part Number	Dimensions (mm)										Approximate Load Capacity (kg)	Std Pack Qty
	D	A X B	E X G	C	F	H	L	S	R			
491118	80	99 x 80	80 x 60	36	9	108	32	2.5	116	100	12	
491119	100	99 x 80	80 x 60	36	9	127	32	2.5	116	150	12	
491120	125	99 x 80	80 x 60	36	9	160	47	2.5	130	130	8	

Industrial Castors - Heavy Duty Nylon Wheel Swivel Plate

SR 5623

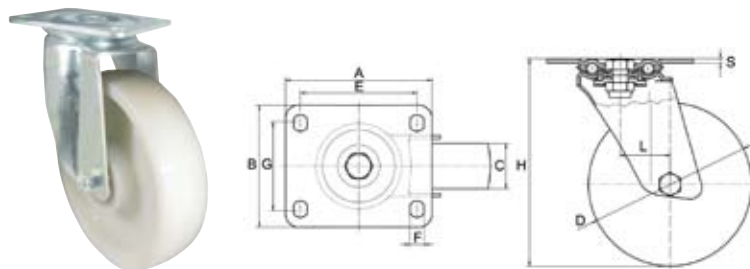

- Ideal for heavy-duty applications such as trolleys, lifting equipment & automatic gates
- Good resistance to abrasion, petroleum and chemical agents
- Double ball race swivel action
- Zinc plated pressed steel housing with swivel plate fitting

Part Number	Dimensions (mm)									Approximate Load Capacity (kg)	Std Pack Qty
	D	A X B	E X G	C	F	H	L	S			
491121	150	132 x 110	105 x 80	42	12	188	45	4	330	4	
491122	200	132 x 110	105 x 80	50	12	243	59	5	600	2	

Industrial Castors - Heavy-Duty Nylon Wheel, Swivel Plate Braked

SR 5624

- Ideal for heavy-duty applications such as trolleys, lifting equipment & automatic gates
- Good resistance to abrasion, petroleum and chemical agents
- Double ball race swivel action
- Zinc plated pressed steel housing with swivel plate fitting
- Total stop brake locks both swivel and wheel

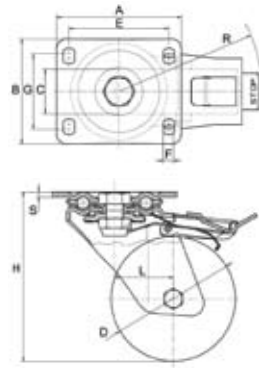

Part Number	Dimensions (mm)										Approximate Load Capacity (kg)	Std Pack Qty
	D	A X B	E X G	C	F	H	L	R	S			
491123	150	132 x 110	105 x 80	42	12	188	45	128	4	4	330	4
491124	200	132 x 110	105 x 80	50	12	2	59	158	5	5	600	2

Industrial Castors - Polyurethane Tyre, Cast Iron Centre, Swivel Plate Braked

EXTENDED RANGE

SR 5626

- Ideal for heavy-duty applications such as trolleys, lifting equipment & automatic gates
- Good resistance to wear, greases and petroleum byproducts
- Heavy-duty pressed steel housing with double ball race crown
- Ball bearings for smooth motion
- Front total stop brake locks both wheel and swivel

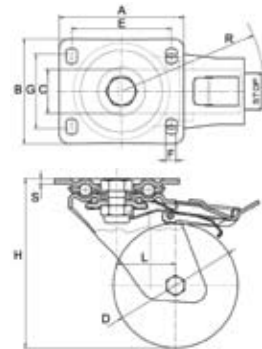

Part Number	Dimensions (mm)										Approximate Load Capacity (kg)	Std Pack Qty
	D	A X B	E X G	C	F	H	L	R	S			
494787	80	100 x 84	80 x 60	25	9	125	47	113	4	4	160	6
494788	100	100 x 84	80 x 60	30	9	135	47	114	4	4	225	5
494789	125	100 x 84	80 x 60	30	9	161	51	128	4	4	300	4
491128	150	132 x 110	105 x 80	40	12	188	45	128	4	4	400	2
491129	175	132 x 110	105 x 80	40	12	230	59	158	5	5	650	2
491130	200	132 x 110	105 x 80	50	12	243	59	158	5	5	700	2

Industrial Castors - Polyurethane Tyre, Cast Iron Centre, Swivel Plate

EXTENDED RANGE

SR 5625

- Ideal for heavy-duty applications such as trolleys, lifting equipment & automatic gates
- Good resistance to wear, greases and petroleum byproducts
- Heavy-duty pressed steel housing with double ball race crown
- Ball bearings for smooth motion

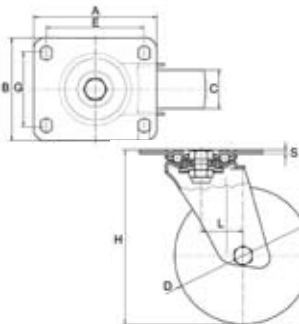

Part Number	Dimensions (mm)										Approximate Load Capacity (kg)	Std Pack Qty
	D	A X B	E X G	C	F	H	L	S				
494784	80	100 x 84	80 x 60	25	9	125	47	4	4	4	160	7
494785	100	100 x 84	80 x 60	30	9	135	47	4	4	4	225	6
494786	125	100 x 84	80 x 60	30	9	161	51	4	4	4	300	5
491125	150	132 x 110	105 x 80	40	12	188	45	4	4	4	400	2
491126	175	132 x 110	105 x 80	40	12	230	59	5	5	5	650	2
491127	200	132 x 110	105 x 80	50	12	243	59	5	5	5	700	2

White Nylon Bolt Hole Unbraked Castors - Stainless Steel Housing

SR 5630

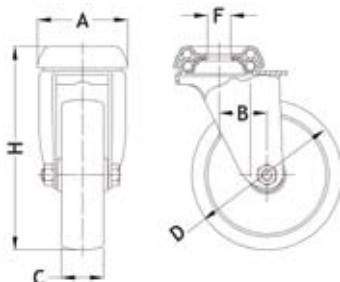

White Nylon, Stainless Steel Housing

- Stainless steel housing resistant to corrosion and rust
- Ideal for catering and medical industries
- Excellent resistance to water and chemicals

Part Number	Dimensions (mm)						Approximate Load Capacity (kg)	Std Pack Qty
	D	A	C	F	H	L		
494463	60	48	22	12	90	26	60	40
494464	80	48	22	12	109	25	60	36
494465	100	57	27	12	132	36	80	16
494466	125	57	27	12	156	35	80	12

White Nylon Bolt Hole Braked Castors - Stainless Steel Housing

SR 5631

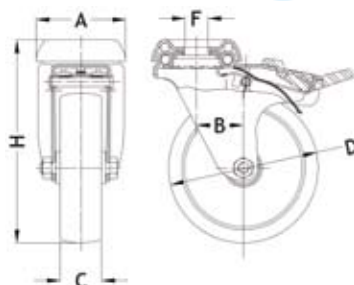

White Nylon, Stainless Steel Housing

- Stainless steel housing resistant to corrosion and rust
- Ideal for catering and medical industries
- Excellent resistance to water and chemicals

Part Number	Dimensions (mm)							Approximate Load Capacity (kg)	Std Pack Qty
	A	C	D	F	H	L	R		
494467	48	22	60	12	90	28	84	60	40
494468	48	22	80	12	109	25	84	60	36
494469	57	27	100	12	132	35	106	80	16
494470	57	27	125	12	156	33	106	80	12

Please see page 293 for replacement wheels



White Nylon, Swivel Plate Unbraked Castors - Stainless Steel Housing

SR 5632

NEW

STAINLESS STEEL

White Nylon, Stainless Steel Housing

- Stainless steel housing resistant to corrosion and rust
- Ideal for catering and medical industries
- Excellent resistance to water and chemicals

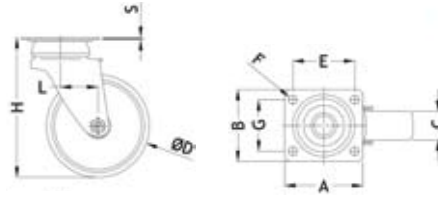

Part Number	Dimensions (mm)									Approximate Load Capacity (kg)	Std Pack Qty
	D	A X B	C	E X G	F	H	L	S			
494473	60	60 x 60	22	45 x 45	6.5	90	26	1.5	60	40	
494474	80	60 x 60	22	45 x 45	6.5	109	25	1.5	60	36	
494475	100	76 x 70	27	60 x 50	8.3	134	36	1.8	80	16	
494476	125	76 x 70	27	60 x 50	8.3	159	35	1.8	80	12	

White Nylon, Swivel Plate Braked Castors - Stainless Steel Housing

SR 5633

NEW

STAINLESS STEEL

White Nylon, Stainless Steel Housing

- Stainless steel housing resistant to corrosion and rust
- Ideal for catering and medical industries
- Excellent resistance to water and chemicals

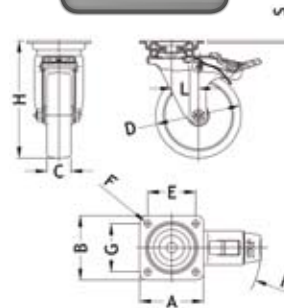

Part Number	Dimensions (mm)										Approximate Load Capacity (kg)	Std Pack Qty
	D	A X B	C	E X G	F	H	L	R	S			
494477	60	60 x 60	22	45 x 45	6.5	90	26	84	1.5	60	40	
494478	80	60 x 60	22	45 x 45	6.5	109	25	84	1.5	60	36	
494479	100	76 x 70	27	60 x 50	8.3	134	36	106	1.8	80	16	
494480	125	76 x 70	27	60 x 50	8.3	159	35	106	1.8	80	12	

White Nylon, Fixed Plate Castors - Stainless Steel Housing

SR 5664

NEW

STAINLESS STEEL

White Nylon, Stainless Steel Housing

- Stainless steel housing resistant to corrosion and rust
- Ideal for catering and medical industries
- Excellent resistance to water and chemicals

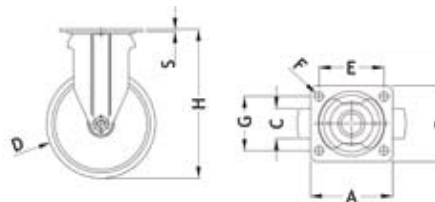

Part Number	Dimensions (mm)								Approximate Load Capacity (kg)	Std Pack Qty
	A X B	C	D	E X G	F	H	S			
494814	60 x 60	22	60	45 x 45	6.5	90	1.5	60	40	
494815	60 x 60	22	80	45 x 45	6.5	109	1.5	60	36	
494816	76 x 70	27	100	60 x 50	8.3	134	1.8	80	12	
494817	76 x 70	27	125	60 x 50	8.3	159	1.8	80	10	

High Temperature Resistant Bolt Hole Unbraked Castors

SR 5638

Phenolic Wheel, Zinc-Plated Steel Housing

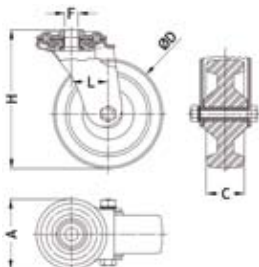

- Phenolic wheel is suitable for high temperature (up to 260°C) operating environments
- Ideal for powder coating, bakery ovens and other applications where resistance to temperatures are required
- Good resistance to water and chemicals

Part Number	Dimensions (mm)						Approximate Load Capacity (kg)	Std Pack Qty
	D	A	C	F	H	L		
494705	80	65	35	12	108	32	100	20
494706	100	65	35	12	127	32	120	16

High Temperature Resistant Bolt Hole Braked Castors

SR 5639

Phenolic Wheel, Zinc-Plated Steel Housing

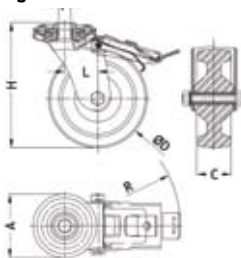

- Phenolic wheel is suitable for high temperature (up to 260°C) operating environments
- Ideal for powder coating, bakery ovens and other applications where resistance to temperatures are required
- Good resistance to water and chemicals

Part Number	Dimensions (mm)							Approximate Load Capacity (kg)	Std Pack Qty
	D	A	C	F	H	R	L		
494707	80	65	35	12	108	116	32	100	16
494708	100	65	35	12	127	116	32	120	12



We are here to help...

Our Customer Service advisors are friendly, knowledgeable, and ready to help you find the right product for your application.

Call +44 (0) 1865 844572

High Temperature Resistant Fixed Plate Castors

NEW

SR 5640

Phenolic Wheel, Zinc-Plated Steel Housing

- Phenolic wheel is suitable for high temperature (up to 260°C) operating environments
- Ideal for powder coating, bakery ovens and other applications where resistance to temperatures are required
- Good resistance to water and chemicals

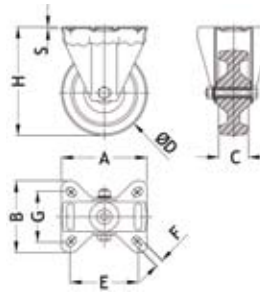

Part Number	Dimensions (mm)								Approximate Load Capacity (kg)	Std Pack Qty
	A X B	C	D	F	E X G	H	S			
494709	100 x 85	35	80	9	80 x 60	108	1.8	100	16	
494710	100 x 85	35	100	9	80 x 60	127	1.8	150	12	

High Temperature Resistant Swivel Plate Unbraked Castors

NEW

SR 5636

Phenolic Wheel, Zinc-Plated Steel Housing

- Phenolic wheel is suitable for high temperature (up to 260°C) operating environments
- Ideal for powder coating, bakery ovens and other applications where resistance to temperatures are required
- Good resistance to water and chemicals

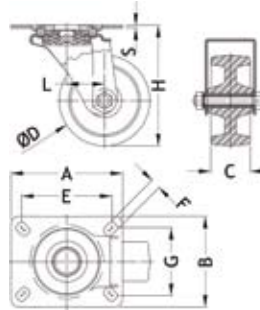

Part Number	Dimensions (mm)								Approximate Load Capacity (kg)	Std Pack Qty
	D	A X B	E X G	C	F	H	L	S		
494701	80	100 x 80	80 x 60	35	9	108	32	2.5	100	18
494702	100	100 x 80	80 x 60	35	9	127	32	2.5	150	14

High Temperature Resistant Swivel Plate Braked Castors

NEW

SR 5637

Phenolic Wheel, Zinc-Plated Steel Housing

- Phenolic wheel is suitable for high temperature (up to 260°C) operating environments
- Ideal for powder coating, bakery ovens and other applications where resistance to temperatures are required
- Good resistance to water and chemicals

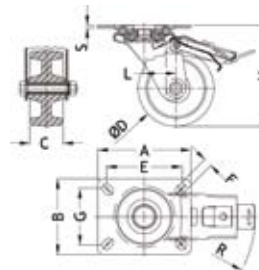

Part Number	Dimensions (mm)										Approximate Load Capacity (kg)	Std Pack Qty
	D	A X B	E X G	C	F	H	L	S	R			
494703	80	100 x 80	80 x 60	35	9	108	32	2.5	116	100	14	
494704	100	100 x 80	80 x 60	35	9	127	32	2.5	116	150	12	

High Temperature Resistant Bolt Hole Unbraked Castors - Stainless Steel Housing

SR 5643

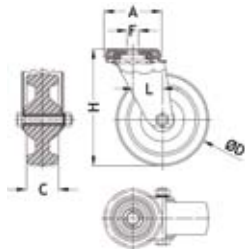

NEW

STAINLESS STEEL

Phenolic Wheel, Stainless Steel Housing

- Stainless steel housing resistant to corrosion and rust
- Phenolic wheel is suitable for high temperature (up to 260°C) operating environments, ideal for powder coating, bakery ovens and other applications
- Good resistance to water and chemicals

Part Number	Dimensions (mm)						Approximate Load Capacity (kg)	Std Pack Qty
	D	A	C	F	H	L		
494715	80	64	35	12	108	32	100	20
494716	100	64	35	12	127	32	120	16

High Temperature Resistant Castors Bolt Hole Braked - Stainless Steel Housing

SR 5644

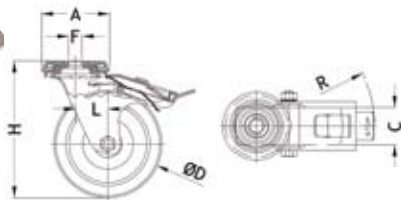

NEW

STAINLESS STEEL

Phenolic Wheel, Stainless Steel Housing

- Stainless steel housing resistant to corrosion and rust
- Phenolic wheel is suitable for high temperature (up to 260°C) operating environments, ideal for powder coating, bakery ovens and other applications
- Good resistance to water and chemicals

Part Number	Dimensions (mm)							Approximate Load Capacity (kg)	Std Pack Qty
	D	A	C	F	H	L	R		
494717	80	64	35	12	108	32	110	100	16
494718	100	64	35	12	127	30	110	120	12

Over 500 million parts in stock - Next day delivery

To order call +44 (0) 1865 844572 or visit www.mossplastics.com

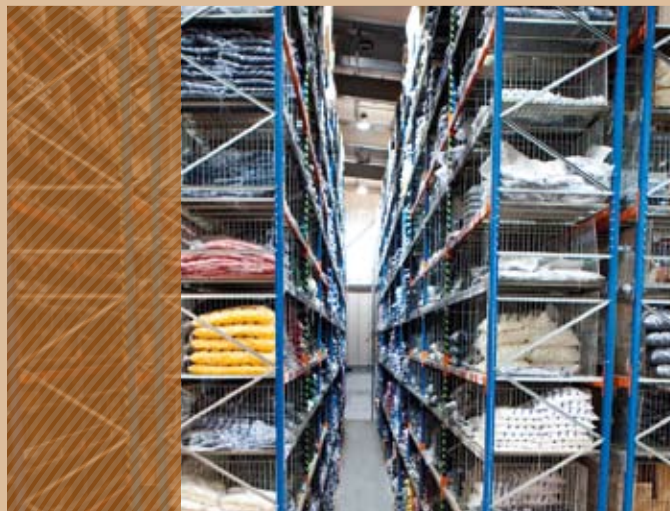

High Temperature Resistant Fixed Plate Castors - Stainless Steel Housing

NEW

STAINLESS STEEL

SR 5645

Phenolic Wheel, Stainless Steel Housing

- Stainless steel housing resistant to corrosion and rust
- Phenolic wheel is suitable for high temperature (up to 260°C) operating environments, ideal for powder coating, bakery ovens and other applications
- Good resistance to water and chemicals

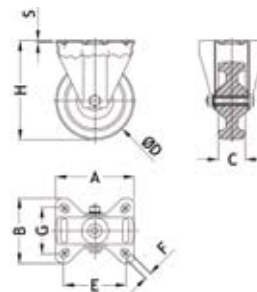

Part Number	Dimensions (mm)								Approximate Load Capacity (kg)	Std Pack Qty
	D	A X B	E X G	C	F	H	S			
494719	80	100 x 85	80 x 60	35	9	108	1.5	100	16	
494720	100	100 x 85	80 x 60	35	9	127	1.5	150	12	

High Temperature Resistant Swivel Plate Unbraked Castors - Stainless Steel Housing

NEW

STAINLESS STEEL

SR 5641

Phenolic Wheel, Stainless Steel Housing

- Stainless steel housing resistant to corrosion and rust
- Phenolic wheel is suitable for high temperature (up to 260°C) operating environments, ideal for powder coating, bakery ovens and other applications
- Good resistance to water and chemicals

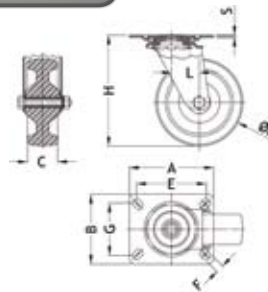

Part Number	Dimensions (mm)									Approximate Load Capacity (kg)	Std Pack Qty
	D	A X B	E X G	C	F	H	L	S			
494711	80	95 x 80	80 x 60	35	9	108	32	2.5	100	16	
494712	100	95 x 80	80 x 60	35	9	127	32	2.5	150	12	

High Temperature Resistant Swivel Plate Braked Castors - Stainless Steel Housing

NEW

STAINLESS STEEL

SR 5642

Phenolic Wheel, Stainless Steel Housing

- Stainless steel housing resistant to corrosion and rust
- Phenolic wheel is suitable for high temperature (up to 260°C) operating environments, ideal for powder coating, bakery ovens and other applications
- Good resistance to water and chemicals

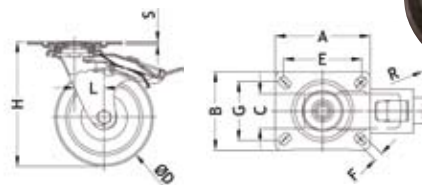

Part Number	Dimensions (mm)										Approximate Load Capacity (kg)	Std Pack Qty
	D	A X B	E X G	C	F	H	L	S	R			
494713	80	95 x 80	80 x 60	35	9	108	32	2.5	110	100	16	
494714	100	95 x 80	80 x 60	35	9	127	30	2.5	110	150	14	

Grey Rubber Tyre Swivel Plated Unbraked Castors - Expander Fitting

NEW

SR 5634

Grey Rubber Tyre, Zinc Plated Housing

- Allows castors to be fitted in to a hollow tube
- Provides secure fitting to all popular sizes of round and square tubing
- Supplied fully assembled

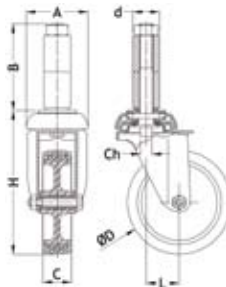

Part Number	Dimensions (mm)						Shape	CH	To Fit Tube Size (mm)	Approximate Load Capacity (kg)	Std Pack Qty
	D	A	B	C	H	L					
494451	80	48	67	22	111	25	Round	9	19 - 22	60	30
494452	80	48	67	22	111	25	Round	9	21 - 23	60	30
494453	80	48	67	22	111	25	Square	9	17x17 - 19x19	60	30
494454	80	48	67	22	111	25	Square	9	22x22 - 24x24	60	30
494455	100	57	67	27	136	36	Round	9	19 - 21	80	16
494456	100	57	67	27	136	36	Round	9	21 - 23	80	16
494457	100	57	67	27	136	36	Square	9	17x17 - 19x19	80	16
494458	100	57	67	27	136	36	Square	9	22x22 - 24x24	80	16

Grey Rubber Tyre Swivel Plated Braked Castors - Expander Fitting

NEW

SR 5635

Grey Rubber Tyre, Zinc Plated Housing

- Allows castors to be fitted in to a hollow tube
- Provides secure fitting to all popular sizes of round and square tubing
- Supplied fully assembled

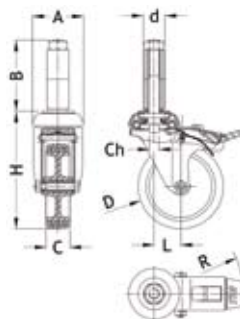

Part Number	Dimensions (mm)								Shape	CH	To Fit Tube Dia (mm)	Approximate Load Capacity (kg)	Std Pack Qty
	D	A	B	C	H	L	R						
494491	80	48	67	22	111	25	84	Round	9	19 - 21	60	28	
494492	80	48	67	22	111	25	84	Round	9	21 - 23	60	28	
494493	80	48	67	22	111	25	84	Square	9	17x17 - 19x19	60	28	
494494	80	48	67	22	111	25	84	Square	9	22x22 - 24x24	60	28	
494495	100	57	67	27	136	36	106	Round	9	19 - 21	80	14	
494496	100	57	67	27	136	36	106	Round	9	21 - 23	80	14	
494497	100	57	67	27	136	36	106	Square	9	17x17 - 19x19	80	14	
494498	100	57	67	27	136	36	106	Square	9	22x22 - 24x24	80	14	

Replacement Castor Wheels

SR 5629

- Suitable for maintenance of castors

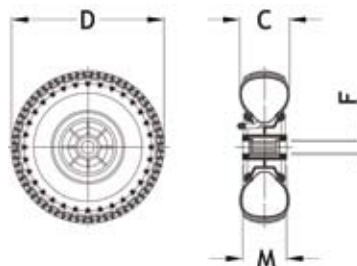
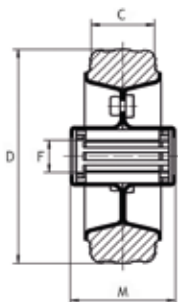

Black Rubber Tyre, Plastic Centre - Plain or Roller Bearing

Part Number	Dimensions (mm)				Pressure Max. Bar	Style	Std Pack Qty
	C	D	F	M			
494781	85	260	20	75	2.0	Plain Bearing	2
494782	50	200	20	59	1.8	Roller Bearing	6
494783	85	260	20	75	2.0	Roller Bearing	2

Black Rubber Tyre, Steel Centre - Roller Bearing

Part Number	Dimensions (mm)				Approximate Load Capacity (kg)	Std Pack Qty
	D	F	M	C		
491135	80	12	39.0	25.0	50	48
491136	100	12	39.0	30.0	70	36
491137	125	15	44.0	37.5	110	20

Compatible with SR 5615 - SR 5620 Castors

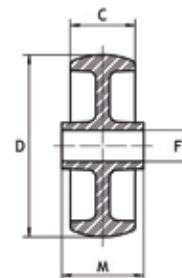
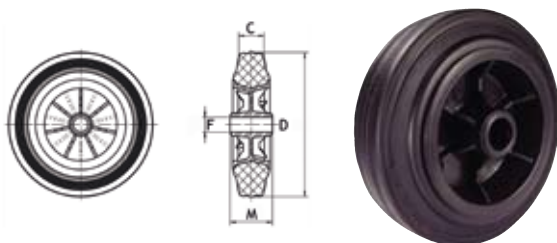

White Nylon, Plain Bearing

Part Number	Dimensions (mm)				Approximate Load Capacity (kg)	Std Pack Qty
	D	F	M	C		
491138	50	8	21.5	17.0	55	48
491139	60	10	27.0	22.0	60	48
491140	75	8.0	27.0	23.0	80	48
491141	80	10	27.0	22.0	80	48
491142	100	12	32.0	27.0	90	44

Compatible with SR 5600 - SR 5614 Castors

Black Rubber Tyre, Plastic Centre - Plain Bearing

Part Number	Dimensions (mm)				Approximate Load Capacity (kg)	Std Pack Qty
	D	F	M	C		
491146	80	12	39.0	25.0	50	48
491147	100	12	39.0	30.0	70	36
491148	125	15	44.0	37.5	100	20

Compatible with SR 5615 - SR 5620 Castors

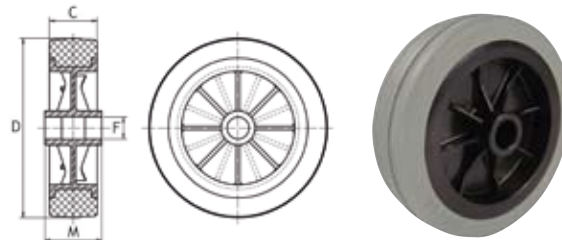
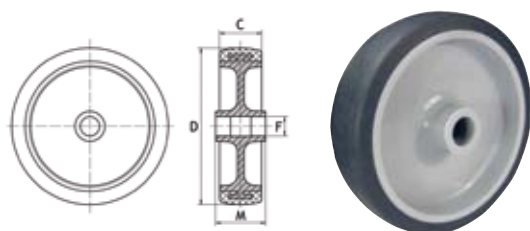

Synthetic Rubber, Plastic Centre - Plain Bearing

Part Number	Dimensions (mm)				Approximate Load Capacity (kg)	Std Pack Qty
	D	F	M	C		
491149	50	8	21.5	19.0	40	68
491150	63	10	27.0	22.0	60	48
491151	75	10	27.0	24.0	60	48
491152	80	10	27.0	22.0	60	48
491153	100	12	32.0	27.0	80	48

Compatible with SR 5600 - SR 5614 Castors

Grey Natural Rubber, Plastic Centre - Plain Bearing

Part Number	Dimensions (mm)				Approximate Load Capacity (kg)	Std Pack Qty
	D	F	M	C		
491143	60	10	27.0	20.0	60	48
491144	80	10	27.0	22.0	60	48
491145	100	12	32.0	28.0	80	48

Compatible with SR 5600 - SR 5614 Castors