



Round Tube End Plugs

SR 1601 Tube End Plugs

White LDPE

- Huge range of sizes
- Secure closures for postal tubes, composite containers and clear plastic tubing

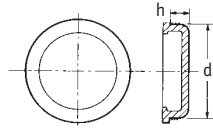

Imperial Range

Part Number	Dimensions (ins)		Std Pack Qty
	d	h	
11123	1.5	0.375	2000
10290	1.75	0.375	1200
15141*	2.0	0.45	3000
10148	2.25	0.375	2000
15142*	2.5	0.45	2000
12300	2.56	0.375	1500
10291	2.75	0.437	1500
12301	2.77	0.50	1000
15143*	3.0	0.43	1000
11357	3.25	0.50	800
12730	3.3	0.375	800
11358	3.5	0.50	700
11600	3.75	0.50	700
12302	3.93	0.50	500
10138	4.0	0.50	600
11888	4.5	0.50	500
12304	4.75	0.50	400
11450	5.0	0.60	300
11898	5.5	0.50	300
11572	6.0	0.59	150
11974	6.5	0.50	200
51854	8.0	0.50	100

* Incorporate bevelled lead-in for easy insertion.

Shallow Range

Part Number	Dimensions (ins)		Std Pack Qty
	d	h	
12360	1.25	0.25	3000
12361	1.37	0.25	3000
12732	1.42	0.37	6000
11924	1.5	0.25	2000
12362	1.62	0.25	2000
11926	2.0	0.25	1200
11927	2.25	0.25	2000
11928	2.5	0.25	2000
11929	2.75	0.25	1500
12734	2.95	0.25	1500
11930	3.0	0.25	500

Metric Range

Part Number	Dimensions (mm)		Std Pack Qty
	d	h	
11619	25.0	8.0	12500
11587	30.0	8.4	8000
12641	40.0	7.8	5000
12305#*	46.0	10.5	3000
12642	50.0	6.9	3000
10920	54.0	8.0	2500
12643	60.0	7.0	2000
12306#	63.0	10.5	1200
12644	70.0	7.3	1800
12307	78.4	10.8	800
12645	80.0	10.2	1000
10724	99.0	8.8	700
12646	100.0	10.8	700
12974	108.0	10.7	500
12964	150.0	12.2	200

Finger grip style * Comes with a vent hole option.

SR 1603 Tube End Plugs with All-Round Grip

White LDPE

- All-round grip for easy removal

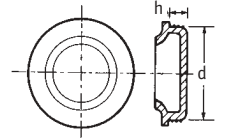

Imperial Range

Part Number	Dimensions (ins)		Std Pack Qty
	d	h	
12623	1.75	0.38	2500
12580	2.0	0.38	2500
12624	2.25	0.38	2000
10301	2.5	0.32	1500
12561	3.0	0.35	1000
12626	3.5	0.5	700
12627	4.0	0.5	600
12628	5.0	0.5	250
12629	6.0	0.5	150

Metric Range

Part Number	Dimensions (mm)		Std Pack Qty
	d	h	
12048	39.0	8.8	4000
12580	50.0	9.5	2000
12581	60.0	9.5	1800
12582	66.0	7.5	1500
10725	71.0	6.0	1000
12560	70.0	9.5	1000
12584	95.0	7.5	600

SR 1604 Tube End Plugs

- Option with finger grip for easy removal

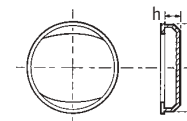

With finger grips

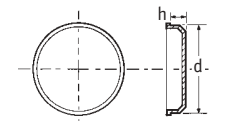

Without finger grips

Part Number		Dimensions (mm)		Std Pack Qty
With Finger Grips	Without Finger Grips	d	h	
10254	-	30.0	7.8	10000
199500	10228	40.0	10.8	4000
199501	10242	50.0	10.8	2500
199502	10245	60.0	10.7	1750
199503	10246	70.0	10.5	1000
199504	10247	80.0	12.5	800
199505	-	90.0	12.5	600
199506	10248	100.0	12.5	500
10542	-	110.0	12.8	350
199507	-	120.0	12.2	300
10543	-	125.0	13.0	300
10544	-	135.0	13.3	200



Square Tube End Plugs and Edge Protectors

SR 1605

Square Tube End Plugs

White LDPE

- Ideal for clear plastic point-of-sale display tubes

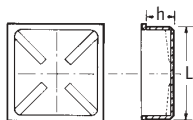
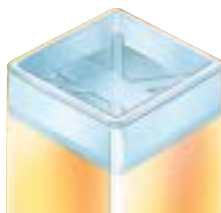

Part Number	Dimensions (mm)		Std Pack Qty
	L	h	
12867	24.0	13.5	3000
15704	30.0	13.5	2000
10164	38.0	14.0	1000
12868	48.0	13.6	1500
12869	52.0	14.8	1500
10729	53.5	13.5	1500
12870	60.0	13.8	400
12871	64.0	13.7	1000
12872	73.0	13.7	800

Other sizes and some rectangular tube end plugs are available; please contact our sales office for more details.

SR 1042

Slotted Edge Protectors

Black Polypropylene or Black LDPE

- Slotted for ease of application
- Polypropylene version for metal strapping



Type 1

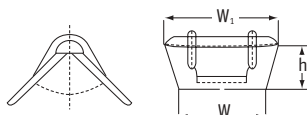

Standard Edge Protectors

Natural LDPE or PPCP

- Popular protection for plastic strapping



Type 2

Heavy-Duty Slotted Edge Protectors

Natural LDPE or Linear LDPE

- Suits wide range of sizes and styles of strapping and webbing



Type 3

Angled Protection Strip

Black LDPE

- Ideal for exposed corners on palletised goods
- Supplied in 1m lengths

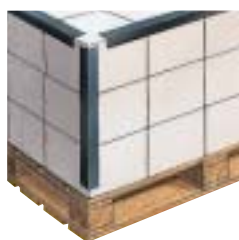

Type 4

Protection Band

Blue HDPE

- Made for steel strapping
- Flexible to fit curved and irregular-shaped items



Type 5

Part Number		Type	Strap Width	W	Dimensions (mm)			Raw Material	Colour	Std Pack Qty
No Slot	Slot				W ₁	h	W			
110243	110244	1	18.00	30.00	40.00	25.00	LDPE	Black	2000	
110247	110248	1	18.00	30.00	40.00	25.00	Polypropylene	Black	2000	
110245	110246	1	28.00	40.00	40.00	40.00	LDPE	Black	1000	
110249	110250	1	28.00	40.00	40.00	40.00	Polypropylene	Black	1000	
51563	–	2	19.00	26.30	33.30	26.30	Natural	Natural	2000	
–	12660	2	24.00	29.40	29.30	21.90	LDPE	Natural	2000	
10180	–	2	28.00	44.30	45.20	27.00	LDPE	Natural	1000	
802802	–	2	28.00	44.30	45.20	27.00	LDPE	Black	2000	
10278	–	2	28.30	43.60	43.70	28.40	PPCP	Natural	1000	
51564	–	2	28.30	43.60	43.70	28.40	LDPE	Natural	1000	
800234	–	2	28.30	43.60	43.70	28.40	LDPE	Black	1000	
–	89395	2	35.80	48.40	64.70	45.83	LDPE	Natural	600	
–	803759	3	55.00	65.30	65.70	46.15	LDPE	Natural	1000	
–	12507	3	55.00	65.30	65.70	46.15	LLDPE	Natural	1000	
39856	–	4	25.40	–	–	–	LDPE	Black	50 x 1m	
–	10203	5	19.00	Overall Length = 132mm			HDPE	Blue	1000	



Tubes, Beakers, Lids, Caps and Vial Plugs

SR 1101

Flat-Bottomed Tubes

Tube: Crystal Polystyrene,
Cap: White LDPE,
Plug: Natural LDPE

- Ideal for packaging powders, liquids or small items



Round Tubes

Part Number	Item	Nominal Capacity	Internal Dia (mm)	Overall Length (mm)	Std Pack Qty
12503	Tube	2.5ml	9.0	44.0	5000
12504	Cap	–	–	–	5000
12453	Tube	4.0ml	12.7	38.0	2000
12454	Plug	–	–	–	2000
12455	Tube	7.0ml	12.7	60.0	2000
12454	Plug	–	–	–	2000
10305	Tube	8.0ml	14.5	53.5	2000
10171	Plug	–	–	–	2000
12508	Tube	8.0ml	12.6	76.0	2000
12454	Plug	–	–	–	2000
10400	Tube	9.0ml	22.5	27.0	1500
10401	Plug	–	–	–	1500
12457	Tube	10.0ml	15.0	63.0	1500
12458	Plug	–	–	–	1500
12459	Tube	12.5ml	17.0	63.0	1200
12460	Plug	–	–	–	1200
10925	Tube	30.0ml	25.0	70.0	500
10142	Plug	–	–	–	500

SR 1105

Measuring Beakers

High-Clarity Polypropylene

- Measuring increments clearly moulded into side of beakers
- Ideally suited to liquid measuring and dispensing
- Can be used in many industries for numerous applications



Part Number	Measuring Increments	Std Pack Qty
10299*	2.5, 5, 10 and 15ml	800
10341	5, 10, 15 and 20ml	1500
10149	10, 15, 20, 25, 30, 40, 50 and 60ml	1000

* Flared lip and fits standard ROPP metal caps.
Measuring increments for guidance only.

SR 1640

Slip Lids

Natural LDPE

- Ideal for cans, clear plastic tubing and composite containers



Part Number	Internal Diameter (mm)	To Fit Can Size	Std Pack Qty
12377	54.0	202	3000
12449	58.5	–	3000
10546	66.6	211	2200
12380	74.0	300	1700
12451	85.6	–	1500
12908	86.0	–	1500
12381	101.5	401	1200
12382	101.0	401A	1000
10340	114.0	410	800
10087	117.5	411	700
10872	129.2	502	800
12659	155.3	603	400
10236	178.0	700	400

SR 1690

Beer Kit Caps

White Polypropylene

- Purpose-made for wine and beer kits
- Room to house loose ingredient sachets



Part Number	Can Size	Height (mm)	Std Pack Qty
10868	401	13.0	–
10869	110279	28.0	300
10082	401	40.0	200

SR 1641

Finned Vial Plugs

Natural LDPE

- Will accommodate small variations in vial size
- Small fins provide leak-proof seal



Part Number	To Fit Tube Size (mm)	Std Pack Qty
80373	6.1	1500
10171	14.5	2000
10309	16.5	8000
80407	16.9	8000
10182	20.0	7000
10310	25.0	4000
10184	30.0	1500



Personalised Engraving Service

Personalise your measuring products with a company name, logo or message for a nominal charge.



Dispensing Closures, Scoops, Spoon and Sifters

SR 1630 Spouted Caps

White LDPE

- Tapered nozzle facilitates accurate application
- Ideal for liquids, creams or pastes



Part Number	Thread Size	Std Pack Qty
12594	20mm R4	1500
12595	22mm R4	1500
12596	24mm R4	1500
12968	28mm R4	1200

SR 1107 Measuring Scoops

Blue Polypropylene

- For powder or liquid
- Low cost



Part Number	Capacity (ml)	Std Pack Qty
10535	5.0	5000
12919	10.0	3000
12832	15.0	2500
10218	20.0	2000
10536	25.0	2000
10088	50.0	1000
10776	60.0	1000

Measuring increments for guidance only.

Detergent Cap

Red LDPE

- Supplied ready assembled



Part Number	To Fit Bottle Neck Diameter	Std Pack Qty
10788	18.0mm	3000

SR 1106 Measuring Spoon

White Polypropylene

- Cost-effective
- Suits large and small volume users
- Both 2.5ml and 5ml measures



Part Number	Measuring Increments	Std Pack Qty
10534	2.5 and 5ml	2500

Measuring increments for guidance only.

Dispensing Plugs

Natural LDPE

- Finned shank accommodates neck diameter variations
- Ideal for liquids or creams

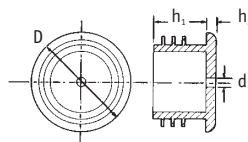

Part Number	Fits Bottle Neck Dia (mm)	Dimensions (mm)				Std Pack Qty
		D	h ₁	h ₂	d	
12313	12.0-13.5	16.0	12.5	1.0	2.0	5000
12314	13.5-15.0	18.0	12.5	1.0	2.0	4000
12315	15.0-16.5	19.5	12.5	1.0	2.0	4000
12316	16.4-18.0	21.0	12.5	1.0	2.0	10000
12317	17.9-19.4	23.0	12.5	1.0	2.0	5000
12319	20.6-22.1	24.8	12.5	1.0	2.0	3000
12320	22.0-23.5	24.5	12.5	1.0	3.0	2000
10279	27.2-29.0	31.5	12.0	1.5	2.0	3000

SR 1632 Dispensing Sifters

Shoulder: White Medium-Impact Polystyrene,
Disc: White MDPE

- Specially designed to dispense a wide variety of particle sizes and textures
- Incorporate sprinkle and pouring actions
- Supplied ready assembled



Part Number	To Fit Tube Size	Std Pack Qty
110003	1½"	1800
22014*	2"	600

* Shoulder is white polypropylene.



Containers, Suction Pads and Funnels

SR 1650

Containers

Container: White Polypropylene,
Cap: White LDPE

- Ideal for storage or point-of-sale
- For powders, pastes and small items
- Widely used in hair-care industries



Part Number	Item	Nominal Capacity (ml)	Internal Dimensions (mm)		Std Pack Qty
			Diameter	Height	
199262	Container	250.0	65.0	102.0	200
199167	Cap	-	-	-	1000
199171	Container	500.0	78.3	138.0	110
199245	Cap	-	-	-	660

SR 1651

Small Containers with Lids

Natural LDPE

- Snap-fit lids
- Ideal for small components and pastes

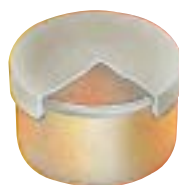

Part Number	Base	Lid	Nominal Capacity (ml)	Internal Dimensions (mm)		Std Pack Qty
				Diameter	Height	
10514	10513		2.0	21.0	6.4	3000
36219	36218		5.0	25.4	9.0	3000
36220	34923		10.0	33.3	10.7	3000
36221	34924		15.0	38.1	12.9	1500
36222	34925		17.5	42.0	13.0	1500
36223	34924		20.0	38.2	19.1	1500
36224	34925		22.5	41.8	17.5	1500
36225	34925		30.0	40.7	28.4	1500
36226	34926		30.0	51.5	14.5	2000
36227	34924		40.0	38.5	36.2	1500
36228	34926		40.0	50.8	19.5	1000
36229	34927		45.0	44.5	30.6	1000
36230	34926		50.0	51.0	24.6	1000
36231	34927		70.0	44.0	44.8	1000
36232	34928		75.0	63.5	24.4	1000
36234	34926		100.0	50.8	51.0	500
36281*	34929*		105.0	66.0	30.5	500

* Grey high-impact polystyrene with interference-fit lids.

SR 1691

Suction Pads

PVC

- Choice of colours
- Wide range of fixing styles and sizes
- Suitable for many applications across a wide range of industry types

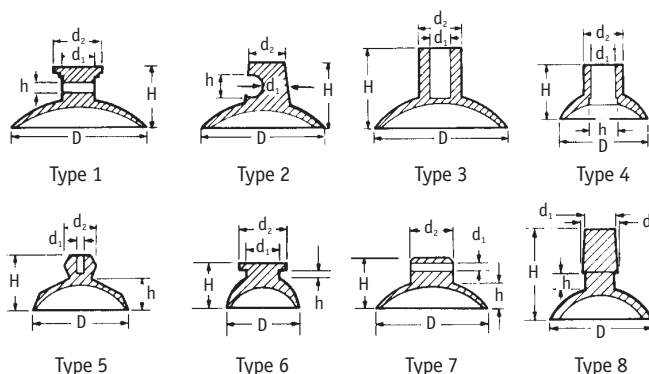

Part Number	Type	Colour	Dimensions (mm)					Std Pack Qty
			D	d ₁	d ₂	h	H	
10153	1	Crystal	46.0	12.0	15.0	4.0	20.0	1500
10165	2	Crystal	46.0	10.0	14.0	6.0	23.0	1500
60742	3	Red	25.4	6.4	7.9	-	17.5	5000
60453	3	Crystal	38.1	4.8	15.9	-	19.0	2000
12469	3	Crystal	46.0	6.4	12.7	-	23.8	1500
50001	3	Black	71.1	19.0	29.0	-	44.0	250
10775	4	Black	25.4	6.0	11.1	7.9	14.3	7000
51519	5	Crystal	25.4	3.2	7.9	7.9	17.5	5000
84477	5	Crystal	25.4	1.8	7.9	7.9	17.5	5000
10197	6	Crystal	12.7	6.4	9.5	1.6	9.5	10000
10115	6	Crystal	40.0	11.0	15.0	2.4	19.0	2500
50675	7	White	38.1	3.2	15.9	15.0	23.5	2000
12896	8	Black	16.0	5.0	5.7	3.0	14.5	10000

SR 1690

Funnels

Natural HDPE

- Ribbs prevent air locks and ensure free flow of liquids



Part Number	Diameter (mm)	Std Pack Qty
31020	75	525
31092	95	600
12916	120	40



Over 400 million parts in stock for a rapid response to your order