



Product Information Table



SR1992



SR1950



SR1951



SR1952



SR1971



SR1972



SR1973



SR1974



SR1975



SR1967

PRODUCT		SR1992	SR1950	SR1951	SR1952	SR1971	SR1972	SR1973	SR1974	SR1975	SR1967
2	4	•		•	•						•
2	5	•		•	•						•
2	6	•		•	•						•
2	8	•		•	•						•
2	10	•		•	•						•
2	12	•		•	•						•
2	16	•		•	•						•
2	20	•		•	•						•
2	25	•		•	•						•
2.5	3			•							
2.5	4	•	•				•				•
2.5	4.5				•						
2.5	5	•	•				•				•
2.5	6	•	•	•	•		•				•
2.5	8	•	•	•	•		•				•
2.5	9										
2.5	10	•	•	•	•		•				•
2.5	12	•	•	•	•		•				•
2.5	16	•	•	•	•		•				•
2.5	20	•	•	•	•		•				•
2.5	25	•	•	•	•		•				•
3	4	•	•	•	•			•			•
3	5	•	•	•	•			•			•
3	6	•	•	•	•			•			•
3	8	•	•	•	•			•			•
3	10	•	•	•	•			•			•
3	12	•	•	•	•			•			•
3	16	•	•	•	•			•			•
3	20	•	•	•	•			•			•
3	25	•	•	•	•			•			•
3	30	•	•	•	•			•			•
3	35	•	•	•	•			•			•
3	40	•	•	•	•			•			•
4	6	•	•	•	•	•	•	•		•	•
4	8	•	•	•	•	•	•	•		•	•
4	10	•	•	•	•	•	•	•		•	•
4	12	•	•	•	•	•	•	•		•	•
4	16	•	•	•	•	•	•	•		•	•
4	18	•	•	•	•					•	•
4	20	•	•	•	•	•	•	•		•	•
4	25	•	•	•	•					•	•
4	30	•	•	•	•					•	•
4	35	•	•	•	•					•	•
4	40	•	•	•	•		•			•	•
5	6	•	•	•	•					•	•
5	8	•	•	•	•	•	•	•		•	•
5	10	•	•	•	•	•	•	•		•	•
5	12	•	•	•	•	•	•	•		•	•
5	16	•	•	•	•	•	•	•		•	•
5	20	•	•	•	•	•	•	•		•	•
5	25	•	•	•	•	•	•	•		•	•
5	30	•	•	•	•	•	•	•		•	•
5	40	•	•	•	•	•	•	•		•	•
5	50	•		•	•	•	•				•
5	60			•	•						•
5	70			•	•						•
6	5	•		•	•						
6	6.5	•	•	•	•	•	•	•	•	•	•
6	8	•	•	•	•	•	•	•	•	•	•
6	10	•	•	•	•	•	•	•	•	•	•
6	12	•	•	•	•	•	•	•	•	•	•
6	16	•	•	•	•	•	•	•	•	•	•
6	20	•	•	•	•	•	•	•	•	•	•
6	22	•	•	•	•	•	•	•	•	•	•
6	25	•	•	•	•	•	•	•	•	•	•
6	30	•	•	•	•	•	•	•	•	•	•
6	40	•	•	•	•	•	•	•	•	•	•
6	45	•	•	•	•	•	•	•	•	•	•
6	50	•	•	•	•	•	•	•	•	•	•
6	60	•	•	•	•	•	•	•	•	•	•
6	65	•	•	•	•	•	•	•	•	•	•
6	70	•	•	•	•	•	•	•	•	•	•
6	80	•	•	•	•	•	•	•	•	•	•
8	8	•	•	•	•					•	
8	10	•	•	•	•	•	•	•	•	•	•
8	16	•	•	•	•	•	•	•	•	•	•
8	20	•	•	•	•	•	•	•	•	•	•
8	25	•	•	•	•	•	•	•	•	•	•
8	30	•	•	•	•	•	•	•	•	•	•
8	35	•	•	•	•	•	•	•	•	•	•
8	40	•	•	•	•	•	•	•	•	•	•
8	50	•	•	•	•	•	•	•	•	•	•
8	60	•	•	•	•	•	•	•	•	•	•
8	70	•	•	•	•	•	•	•	•	•	•
8	80	•	•	•	•	•	•	•	•	•	•
10	16	•	•	•	•		•		•		•
10	20	•	•	•	•		•		•		•
10	25	•	•	•	•		•		•		•
10	30	•	•	•	•		•		•		•
10	35	•	•	•	•		•		•		•
10	40	•	•	•	•		•		•		•
10	50	•	•	•	•		•		•	•	•
10	60	•	•	•	•		•		•	•	•
10	70	•	•	•	•		•		•	•	•
10	80	•	•	•	•		•		•	•	•
10	100	•	•	•	•		•		•	•	•
12	16	•									
12	20	•							•		
12	30	•							•		
12	40	•							•		
12	50	•		•					•		
12	60	•		•					•		
12	70	•		•					•		
12	80	•		•					•		
12	90	•		•					•		
12	100	•		•					•		
16	16	•									
16	20	•									
16	30	•									
16	40	•									
16	50	•		•							
16	60	•		•							
16	80	•		•							
16	100	•		•							
18	50	•									

Other sizes available; please contact our sales office.



SR 1992

Hexagonal Head Screws

new



Type 1 - Natural Nylon 6.6

- Conforms to dimensional tolerances of: ISO 4017, NF EN 24017, DIN 933

Type 2 - Natural Nylon 6.6

- Conforms to dimensional tolerance of DIN 931
- Unthreaded top section

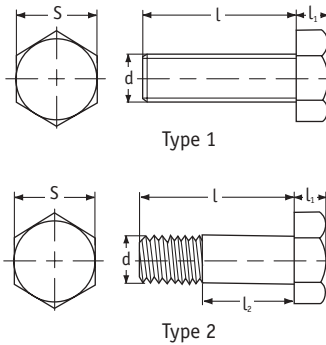

Type 1

Part Number	Dimensions (mm)				Std Pack Qty
	d	l	l ₁	S	
0020010000VR	M2 x 0.4	4.0	1.2	3.2	1000
0020020000VR	M2 x 0.4	5.0	1.2	3.2	1000
0020030000VR	M2 x 0.4	6.0	1.2	3.2	1000
0020040000VR	M2 x 0.4	8.0	1.2	3.2	1000
0021450000VR	M2 x 0.4	10.0	1.2	3.2	1000
0021380000VR	M2 x 0.4	12.0	1.2	3.2	1000
0021370000VR	M2 x 0.4	16.0	1.2	3.2	1000
0021320000VR	M2 x 0.4	20.0	1.2	3.2	1000
0021330000VR	M2 x 0.4	25.0	1.2	3.2	1000
0021340000VR	M2.5 x 0.45	4.0	1.3	4.0	1000
0021890000VR	M2.5 x 0.45	4.5	1.3	4.0	1000
0021410000VR	M2.5 x 0.45	5.0	1.3	4.0	1000
0021350000VR	M2.5 x 0.45	6.0	1.3	4.0	1000
0021500000VR	M2.5 x 0.45	8.0	1.3	4.0	1000
0021460000VR	M2.5 x 0.45	10.0	1.3	4.0	1000
0021640000VR	M2.5 x 0.45	12.0	1.3	4.0	1000
0021310000VR	M2.5 x 0.45	16.0	1.3	4.0	1000
0021430000VR	M2.5 x 0.45	20.0	1.3	4.0	1000
0021440000VR	M2.5 x 0.45	25.0	1.3	4.0	1000
0020060000VR	M3 x 0.5	4.0	2.0	5.5	1000
0021200000VR	M3 x 0.5	5.0	2.0	5.5	1000
0020070000VR	M3 x 0.5	6.0	2.0	5.5	1000
0020080000VR	M3 x 0.5	8.0	2.0	5.5	1000
0020090000VR	M3 x 0.5	10.0	2.0	5.5	1000
0020100000VR	M3 x 0.5	12.0	2.0	5.5	1000
0020120000VR	M3 x 0.5	16.0	2.0	5.5	1000
0020130000VR	M3 x 0.5	20.0	2.0	5.5	1000
0020140000VR	M3 x 0.5	25.0	2.0	5.5	1000
0020150000VR	M3 x 0.5	30.0	2.0	5.5	1000
0020160000VR	M4 x 0.7	6.0	2.8	7.0	1000
0020170000VR	M4 x 0.7	8.0	2.8	7.0	1000
0020180000VR	M4 x 0.7	10.0	2.8	7.0	1000
0020190000VR	M4 x 0.7	12.0	2.8	7.0	1000
0020210000VR	M4 x 0.7	16.0	2.8	7.0	1000
0021820000VR	M4 x 0.7	18.0	2.8	7.0	1000
0020220000VR	M4 x 0.7	20.0	2.8	7.0	1000
0020230000VR	M4 x 0.7	25.0	2.8	7.0	1000
0020240000VR	M4 x 0.7	30.0	2.8	7.0	1000
0020250000VR	M4 x 0.7	40.0	2.8	7.0	1000

Part Number	Dimensions (mm)				Std Pack Qty
	d	l	l ₁	S	
0020260000VR	M5 x 0.8	6.0	3.5	8.0	1000
0020270000VR	M5 x 0.8	8.0	3.5	8.0	1000
0020280000VR	M5 x 0.8	10.0	3.5	8.0	1000
0020290000VR	M5 x 0.8	12.0	3.5	8.0	1000
0020310000VR	M5 x 0.8	16.0	3.5	8.0	1000
0020330000VR	M5 x 0.8	20.0	3.5	8.0	1000
0020340000VR	M5 x 0.8	25.0	3.5	8.0	1000
0020350000VR	M5 x 0.8	30.0	3.5	8.0	1000
0020360000VR	M5 x 0.8	40.0	3.5	8.0	1000
0020370000VR	M5 x 0.8	50.0	3.5	8.0	1000
0021420000VR	M6 x 1.0	5.0	4.0	10.0	1000
0020390000VR	M6 x 1.0	6.5	4.0	10.0	1000
0020410000VR	M6 x 1.0	8.0	4.0	10.0	1000
0020420000VR	M6 x 1.0	10.0	4.0	10.0	1000
0020430000VR	M6 x 1.0	12.0	4.0	10.0	1000
0020450000VR	M6 x 1.0	16.0	4.0	10.0	1000
0020460000VR	M6 x 1.0	20.0	4.0	10.0	1000
0020470000VR	M6 x 1.0	22.0	4.0	10.0	1000
0020480000VR	M6 x 1.0	25.0	4.0	10.0	1000
0020500000VR	M6 x 1.0	30.0	4.0	10.0	1000
0020520000VR	M6 x 1.0	40.0	4.0	10.0	1000
0021400000VR	M6 x 1.0	45.0	4.0	10.0	1000
0020530000VR	M6 x 1.0	50.0	4.0	10.0	500
0020550000VR	M6 x 1.0	60.0	4.0	10.0	500
0021470000VR	M6 x 1.0	65.0	4.0	10.0	500
0021280000VR	M6 x 1.0	70.0	4.0	10.0	500
0020570000VR	M6 x 1.0	80.0	4.0	10.0	500
0020640000VR	M8 x 1.25	8.0	5.3	13.0	1000
0020650000VR	M8 x 1.25	10.0	5.3	13.0	1000
0020680000VR	M8 x 1.25	16.0	5.3	13.0	1000
0020690000VR	M8 x 1.25	20.0	5.3	13.0	1000
0020700000VR	M8 x 1.25	25.0	5.3	13.0	1000
0020710000VR	M8 x 1.25	30.0	5.3	13.0	1000
0020720000VR	M8 x 1.25	35.0	5.3	13.0	1000
0020730000VR	M8 x 1.25	40.0	5.3	13.0	1000
0020740000VR	M8 x 1.25	50.0	5.3	13.0	500
0020750000VR	M8 x 1.25	60.0	5.3	13.0	500
0021480000VR	M8 x 1.25	70.0	5.3	13.0	500
0020770000VR	M8 x 1.25	80.0	5.3	13.0	500
0021850000VR	M10 x 1.5	16.0	6.4	17.0	500
0020860000VR	M10 x 1.5	20.0	6.4	17.0	500
0021490000VR	M10 x 1.5	25.0	6.4	17.0	500
0020880000VR	M10 x 1.5	30.0	6.4	17.0	500
0021270000VR	M10 x 1.5	40.0	6.4	17.0	500
0020890000VR	M10 x 1.5	50.0	6.4	17.0	250
0020900000VR	M10 x 1.5	60.0	6.4	17.0	250
0020910000VR	M10 x 1.5	70.0	6.4	17.0	250
0020920000VR	M10 x 1.5	80.0	6.4	17.0	250
0021870000VR	M10 x 1.5	100.0	6.4	17.0	250
0021900000VR	M12 x 1.75	16.0	7.5	19.0	500
0021360000VR	M12 x 1.75	20.0	7.5	19.0	500
0021010000VR	M12 x 1.75	30.0	7.5	19.0	500
0021020000VR	M12 x 1.75	40.0	7.5	19.0	500
0021030000VR	M12 x 1.75	50.0	7.5	19.0	250
0021040000VR	M12 x 1.75	60.0	7.5	19.0	250
0021050000VR	M12 x 1.75	70.0	7.5	19.0	250
0021060000VR	M12 x 1.75	80.0	7.5	19.0	250
0021070000VR	M12 x 1.75	90.0	7.5	19.0	250
0021880000VR	M12 x 1.75	100.0	7.5	19.0	250
0021150000VR	M16 x 2.0	16.0	10.0	24.0	250
0021130000VR	M16 x 2.0	20.0	10.0	24.0	250
0021160000VR	M16 x 2.0	30.0	10.0	24.0	250
0021860000VR	M16 x 2.0	40.0	10.0	24.0	250
0021180000VR	M16 x 2.0	50.0	10.0	24.0	250
0021190000VR	M16 x 2.0	60.0	10.0	24.0	250
0021220000VR	M16 x 2.0	80.0	10.0	24.0	250
0021210000VR	M16 x 2.0	100.0	10.0	24.0	250
0021230000VR	M18 x 2.5	50.0	11.5	27.0	250

CONTINUED ON NEXT PAGE



Hexagonal Head Screws

Hexagonal Head Screws *CONTINUED*

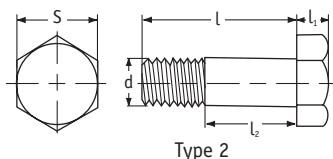

Type 2

Part Number	Dimensions (mm)					Std Pack Qty
	d	l	l ₁	S	l ₂	
0025370000VR	M5 x 0.8	50.0	3.5	0.8	34.0	1000
0025550000VR	M6 x 1.0	60.0	4.0	10.0	10.0	500
0025570000VR	M6 x 1.0	80.0	4.0	10.0	15.0	500
0025580000VR	M6 x 1.0	100.0	4.0	10.0	60.0	250
0325680000VR*	M6 x 1.0	100.0	4.0	10.0	60.0	500
0025770000VR	M8 x 1.25	80.0	5.3	13.0	20.0	500
0025780000VR	M8 x 1.25	85.0	5.3	13.0	50.0	250
0025790000VR	M8 x 1.25	100.0	5.3	13.0	50.0	250
0325790000VR*	M8 x 1.25	100.0	5.5	13.0	50.0	500
0025800000VR	M8 x 1.25	125.0	5.3	13.0	75.0	250
0325800000VR*	M8 x 1.25	125.0	5.5	13.0	75.0	500
0026270000VR	M10 x 1.5	40.0	6.4	17.0	8.0	500
0025900000VR	M10 x 1.5	60.0	6.4	17.0	10.0	250
0025910000VR	M10 x 1.5	70.0	6.4	17.0	10.0	250
0025920000VR	M10 x 1.5	80.0	6.4	17.0	20.0	250
0025940000VR	M10 x 1.5	125.0	6.4	17.0	65.0	250
0325940000VR*	M10 x 1.5	125.0	7.0	17.0	65.0	250
0025950000VR	M10 x 1.5	150.0	6.4	17.0	90.0	125
0325950000VR*	M10 x 1.5	150.0	7.0	17.0	90.0	250
0026020000VR	M12 x 1.75	40.0	7.5	19.0	10.0	500
0026040000VR	M12 x 1.75	60.0	7.5	19.0	10.0	250
0026050000VR	M12 x 1.75	70.0	7.5	19.0	20.0	250
0026060000VR	M12 x 1.75	80.0	7.5	19.0	30.0	250
0026090000VR	M12 x 1.75	125.0	7.5	19.0	90.0	250
0026180000VR	M16 x 2.0	50.0	10.0	24.0	12.0	250

* With slotted head.

SR 1950 Slotted Hexagonal Head Screws

Natural Nylon 6.6

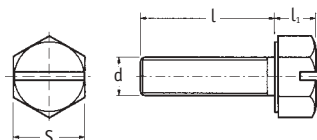

extended range

Part Number	Dimensions (mm)				Std Pack Qty
	d	l	l ₁	S	
0320040000VR	M2 x 0.4	8.0	1.15	3.2	1000
0321450000VR	M2 x 0.4	10.0	1.15	3.2	1000
0321380000VR	M2 x 0.4	12.0	1.15	3.2	1000
0321370000VR	M2 x 0.4	16.0	1.15	3.2	1000
0321320000VR	M2 x 0.4	20.0	1.15	3.2	1000
0321330000VR	M2 x 0.4	25.0	1.15	3.2	1000
0321340000VR	M2.5 x 0.45	4.0	1.3	4.0	1000
0321410000VR	M2.5 x 0.45	5.0	1.3	4.0	1000

Part Number	Dimensions (mm)				Std Pack Qty
	d	l	l ₁	S	
0321350000VR	M2.5 x 0.45	6.0	1.3	4.0	1000
0321500000VR	M2.5 x 0.45	8.0	1.3	4.0	1000
0321460000VR	M2.5 x 0.45	10.0	1.3	4.0	1000
0321640000VR	M2.5 x 0.45	12.0	1.3	4.0	1000
0321310000VR	M2.5 x 0.45	16.0	1.3	4.0	1000
0321430000VR	M2.5 x 0.45	20.0	1.3	4.0	1000
0321440000VR	M2.5 x 0.45	25.0	1.3	4.0	1000
0320060000VR	M3 x 0.5	4.0	2.0	5.5	1000
0321200000VR	M3 x 0.5	5.0	2.0	5.5	1000
0320070000VR	M3 x 0.5	6.0	2.0	5.5	1000
0320080000VR	M3 x 0.5	8.0	2.0	5.5	1000
0320090000VR	M3 x 0.5	10.0	2.0	5.5	1000
0320100000VR	M3 x 0.5	12.0	2.0	5.5	1000
0320120000VR	M3 x 0.5	16.0	2.0	5.5	1000
0320130000VR	M3 x 0.5	20.0	2.0	5.5	1000
0320140000VR	M3 x 0.5	25.0	2.0	5.5	1000
0320150000VR	M3 x 0.5	30.0	2.0	5.5	1000
0320160000VR	M4 x 0.7	6.0	2.8	7.0	1000
0320170000VR	M4 x 0.7	8.0	2.8	7.0	1000
0320180000VR	M4 x 0.7	10.0	2.8	7.0	1000
0320190000VR	M4 x 0.7	12.0	2.8	7.0	1000
0320210000VR	M4 x 0.7	16.0	2.8	7.0	1000
0320220000VR	M4 x 0.7	20.0	2.8	7.0	1000
0320230000VR	M4 x 0.7	25.0	2.8	7.0	1000
0320240000VR	M4 x 0.7	30.0	2.8	7.0	1000
0320250000VR	M4 x 0.7	40.0	2.8	7.0	1000
0320260000VR	M5 x 0.8	6.0	3.5	8.0	1000
0320270000VR	M5 x 0.8	8.0	3.5	8.0	1000
0320280000VR	M5 x 0.8	10.0	3.5	8.0	1000
0020290000VR	M5 x 0.8	12.0	3.5	8.0	1000
0320310000VR	M5 x 0.8	16.0	3.5	8.0	1000
0320330000VR	M5 x 0.8	20.0	3.5	8.0	1000
0320340000VR	M5 x 0.8	25.0	3.5	8.0	1000
0320350000VR	M5 x 0.8	30.0	3.5	8.0	1000
0320360000VR	M5 x 0.8	40.0	3.5	8.0	1000
0320390000VR	M6 x 1.0	6.5	4.0	10.0	1000
0320410000VR	M6 x 1.0	8.0	4.0	10.0	1000
0320420000VR	M6 x 1.0	10.0	4.0	10.0	1000
0320430000VR	M6 x 1.0	12.0	4.0	10.0	1000
0320450000VR	M6 x 1.0	16.0	4.0	10.0	1000
0320460000VR	M6 x 1.0	20.0	4.0	10.0	1000
0320480000VR	M6 x 1.0	25.0	4.0	10.0	1000
0320500000VR	M6 x 1.0	30.0	4.0	10.0	1000
0320520000VR	M6 x 1.0	40.0	4.0	10.0	1000
0321400000VR	M6 x 1.0	45.0	4.0	10.0	1000
0320530000VR	M6 x 1.0	50.0	4.0	10.0	500
0320550000VR	M6 x 1.0	60.0	4.0	10.0	500
0321280000VR	M6 x 1.0	70.0	4.0	10.0	500
0320570000VR	M6 x 1.0	80.0	4.0	10.0	500
0320640000VR	M8 x 1.25	8.0	5.3	13.0	1000
0320650000VR	M8 x 1.25	10.0	5.3	13.0	1000
0320680000VR	M8 x 1.25	16.0	5.3	13.0	1000
0320690000VR	M8 x 1.25	20.0	5.3	13.0	1000
0320700000VR	M8 x 1.25	25.0	5.3	13.0	1000
0320710000VR	M8 x 1.25	30.0	5.3	13.0	1000
0320720000VR	M8 x 1.25	35.0	5.3	13.0	1000
0320730000VR	M8 x 1.25	40.0	5.5	13.0	1000
0320740000VR	M8 x 1.25	50.0	5.5	13.0	500
0320750000VR	M8 x 1.25	60.0	5.5	13.0	500
0321480000VR	M8 x 1.25	70.0	5.5	13.0	500
0320770000VR	M8 x 1.25	80.0	5.5	13.0	500
0320850000VR	M10 x 1.5	16.0	6.7	17.0	500
0320860000VR	M10 x 1.5	20.0	6.7	17.0	500
0320880000VR	M10 x 1.5	30.0	6.7	17.0	500
0321270000VR	M10 x 1.5	40.0	7.0	17.0	500
0320890000VR	M10 x 1.5	50.0	7.0	17.0	250
0320900000VR	M10 x 1.5	60.0	7.0	17.0	250
0320910000VR	M10 x 1.5	70.0	7.0	17.0	250
0320920000VR	M10 x 1.5	80.0	7.0	17.0	250



SR 1951 Slotted Cheese Head Screws

Natural Nylon 6.6

- Conform to dimensional tolerances of: ISO 1207, NF E 25-127, DIN 84

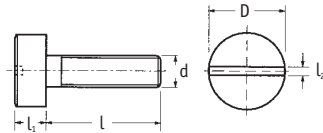

**extended
range**

Part Number	Dimensions (mm)					Std Pack Qty
	d	l	D	l ₁	l ₂	
0010010000VR	M2 x 0.4	4.0	3.8	1.3	0.5	1000
0010020000VR	M2 x 0.4	5.0	3.8	1.3	0.5	1000
0010030000VR	M2 x 0.4	6.0	3.8	1.3	0.5	1000
0010040000VR	M2 x 0.4	8.0	3.8	1.3	0.5	1000
0011450000VR	M2 x 0.4	10.0	3.8	1.3	0.5	1000
0011380000VR	M2 x 0.4	12.0	3.8	1.3	0.7	1000
0011370000VR	M2 x 0.4	16.0	3.8	1.3	0.7	1000
0011320000VR	M2 x 0.4	20.0	3.8	1.3	0.7	1000
0011330000VR	M2 x 0.4	25.0	3.8	1.3	0.7	1000
0011060000VR	M2.5 x 0.45	3.0	4.5	1.6	0.6	1000
0011350000VR	M2.5 x 0.45	6.0	4.5	1.6	0.6	1000
0011500000VR	M2.5 x 0.45	8.0	4.5	1.6	0.6	1000
0011460000VR	M2.5 x 0.45	10.0	4.5	1.6	0.6	1000
0011640000VR	M2.5 x 0.45	12.0	4.5	1.6	0.6	1000
0011310000VR	M2.5 x 0.45	16.0	4.5	1.6	0.6	1000
0011430000VR	M2.5 x 0.45	20.0	4.5	1.6	0.8	1000
0011440000VR	M2.5 x 0.45	25.0	4.5	1.6	0.8	1000
0010060000VR	M3 x 0.5	4.0	5.5	2.0	0.8	1000
0011390000VR	M3 x 0.5	5.0	5.5	2.0	0.8	1000
0010070000VR	M3 x 0.5	6.0	5.5	2.0	0.8	1000
0010080000VR	M3 x 0.5	8.0	5.5	2.0	0.8	1000
0010090000VR	M3 x 0.5	10.0	5.5	2.0	0.8	1000
0010100000VR	M3 x 0.5	12.0	5.5	2.0	0.8	1000
0010120000VR	M3 x 0.5	16.0	5.5	2.0	0.8	1000
0010130000VR	M3 x 0.5	20.0	5.5	2.0	0.8	1000
0010140000VR	M3 x 0.5	25.0	5.5	2.0	0.8	1000
0010150000VR	M3 x 0.5	30.0	5.5	2.0	0.8	1000
0011780000VR	M3 x 0.5	35.0	6.0	2.4	1.0	1000
0011790000VR	M3 x 0.5	40.0	6.0	2.4	1.0	1000
0010160000VR	M4 x 0.7	6.0	7.0	2.6	1.2	1000
0010170000VR	M4 x 0.7	8.0	7.0	2.6	1.2	1000
0010180000VR	M4 x 0.7	10.0	7.0	2.6	1.2	1000
0010190000VR	M4 x 0.7	12.0	7.0	2.6	1.2	1000
0010210000VR	M4 x 0.7	16.0	7.0	2.6	1.2	1000
0010220000VR	M4 x 0.7	20.0	7.0	2.6	1.2	1000
0010230000VR	M4 x 0.7	25.0	7.0	2.6	1.2	1000
0010240000VR	M4 x 0.7	30.0	7.0	2.6	1.2	1000
0010250000VR	M4 x 0.7	40.0	7.0	2.6	1.2	1000
0010260000VR	M5 x 0.8	6.0	8.5	3.3	1.2	1000
0010270000VR	M5 x 0.8	8.0	8.5	3.3	1.2	1000
0010280000VR	M5 x 0.8	10.0	8.5	3.3	1.2	1000
0010290000VR	M5 x 0.8	12.0	8.5	3.3	1.2	1000
0010310000VR	M5 x 0.8	16.0	8.5	3.3	1.2	1000
0010330000VR	M5 x 0.8	20.0	8.5	3.3	1.2	1000
0010340000VR	M5 x 0.8	25.0	8.5	3.3	1.2	1000
0010350000VR	M5 x 0.8	30.0	8.5	3.3	1.2	1000
0010360000VR	M5 x 0.8	40.0	8.5	3.3	1.2	1000
0010370000VR	M5 x 0.8	50.0	8.5	3.3	1.2	1000
0011800000VR	M5 x 0.8	60.0	8.5	3.3	1.2	1000
0010380000VR	M5 x 0.8	70.0	8.5	3.3	1.2	1000
0010390000VR	M6 x 1.0	6.5	10.0	3.9	1.6	1000
0010410000VR	M6 x 1.0	8.0	10.0	3.9	1.6	1000
0010420000VR	M6 x 1.0	10.0	10.0	3.9	1.6	1000
0010430000VR	M6 x 1.0	12.0	10.0	3.9	1.6	1000
0010450000VR	M6 x 1.0	16.0	10.0	3.9	1.6	1000
0010460000VR	M6 x 1.0	20.0	10.0	3.9	1.6	1000
0010470000VR	M6 x 1.0	22.0	10.0	3.9	1.6	1000
0010480000VR	M6 x 1.0	25.0	10.0	3.9	1.6	1000

Part Number	Dimensions (mm)					Std Pack Qty
	d	l	D	l ₁	l ₂	
0010500000VR	M6 x 1.0	30.0	10.0	3.9	1.6	1000
0010520000VR	M6 x 1.0	40.0	10.0	3.9	1.6	1000
0010530000VR	M6 x 1.0	50.0	10.0	3.9	1.6	500
0010550000VR	M6 x 1.0	60.0	10.0	3.9	1.6	500
0011280000VR	M6 x 1.0	70.0	10.0	3.9	1.6	500
0010570000VR	M6 x 1.0	80.0	10.0	3.9	1.6	500
0010640000VR	M8 x 1.25	8.0	13.0	5.0	2.0	1000
0010650000VR	M8 x 1.25	10.0	13.0	5.0	2.0	1000
0010680000VR	M8 x 1.25	16.0	13.0	5.0	2.0	1000
0010690000VR	M8 x 1.25	20.0	13.0	5.0	2.0	1000
0010700000VR	M8 x 1.25	25.0	13.0	5.0	2.0	1000
0010710000VR	M8 x 1.25	30.0	13.0	5.0	2.0	1000
0010720000VR	M8 x 1.25	35.0	13.0	5.0	2.0	1000
0010730000VR	M8 x 1.25	40.0	13.0	5.0	2.0	1000
0010740000VR	M8 x 1.25	50.0	13.0	5.0	2.0	500
0010750000VR	M8 x 1.25	60.0	13.0	5.0	2.0	500
0011480000VR	M8 x 1.25	70.0	13.0	5.0	2.0	500
0010770000VR	M8 x 1.25	80.0	13.0	5.0	2.0	500
0011850000VR	M10 x 1.5	16.0	16.0	6.0	2.5	500
0010860000VR	M10 x 1.5	20.0	16.0	6.0	2.5	500
0010880000VR	M10 x 1.5	30.0	16.0	6.0	2.5	500
0010890000VR	M10 x 1.5	40.0	16.0	6.0	2.5	500
0010900000VR	M10 x 1.5	50.0	16.0	6.0	2.5	250
0010910000VR	M10 x 1.5	60.0	16.0	6.0	2.5	250
0010920000VR	M10 x 1.5	70.0	16.0	6.0	2.5	250
0010930000VR	M10 x 1.5	80.0	16.0	6.0	2.5	250
0011020000VR	M12 x 1.75	40.0	19.0	8.0	2.5	500
0011030000VR	M12 x 1.75	50.0	19.0	8.0	2.5	250
0011040000VR	M12 x 1.75	60.0	19.0	8.0	2.5	250
0011050000VR	M12 x 1.75	70.0	19.0	8.0	2.5	250
0011860000VR	M16 x 2.0	40.0	23.0	9.5	4.5	250
0011180000VR	M16 x 2.0	50.0	23.0	9.5	4.5	250
0011190000VR	M16 x 2.0	60.0	23.0	9.5	4.5	250

plastivis

*New to the Moss range
of fasteners and fixings.*





Slotted Pan and Round Head Screws

SR 1952 Slotted Pan Head Screws

Natural Nylon 6.6

- Conform to dimensional tolerances of: ISO 1580, NF E 25-128, DIN ISO 1580, DIN 85

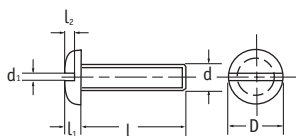

Part Number	Dimensions (mm)						Std Pack Qty
	d	l	D	l ₁	d ₁	l ₂	
0121750000VR	M2 x 0.4	4.0	3.8	1.3	0.6	0.6	1000
0120010000VR	M2 x 0.4	5.0	4.0	1.3	0.5	0.5	1000
0121760000VR	M2 x 0.4	6.0	3.8	1.3	0.6	0.6	1000
0121770000VR	M2 x 0.4	8.0	3.8	1.3	0.6	0.6	1000
0121450000VR	M2 x 0.4	10.0	3.8	1.3	0.6	0.6	1000
0121380000VR	M2 x 0.4	12.0	3.8	1.3	0.6	0.6	1000
0120030000VR	M2 x 0.4	16.0	4.0	1.3	0.5	0.5	1000
0121320000VR	M2 x 0.4	20.0	3.8	1.3	0.6	0.6	1000
0121330000VR	M2 x 0.4	25.0	3.8	1.3	0.6	0.6	1000
0120040000VR	M2.5 x 0.45	4.5	5.0	1.5	0.6	0.6	1000
0121350000VR	M2.5 x 0.45	6.0	4.5	1.6	0.7	0.8	1000
0121500000VR	M2.5 x 0.45	8.0	4.5	1.6	0.7	0.8	1000
0121460000VR	M2.5 x 0.45	10.0	4.5	1.6	0.7	0.8	1000
0121640000VR	M2.5 x 0.45	12.0	4.5	1.6	0.7	0.8	1000
0121310000VR	M2.5 x 0.45	16.0	4.5	1.6	0.7	0.8	1000
0121430000VR	M2.5 x 0.45	20.0	4.5	1.6	0.7	0.8	1000
0121440000VR	M2.5 x 0.45	25.0	4.5	1.6	0.7	0.8	1000
0120060000VR	M3 x 0.5	4.0	5.6	1.8	0.8	0.7	1000
0121100000VR	M3 x 0.5	5.0	5.6	1.8	0.8	0.7	1000
0120070000VR	M3 x 0.5	6.0	5.6	1.8	0.8	0.7	1000
0120080000VR	M3 x 0.5	8.0	5.6	1.8	0.8	0.7	1000
0120090000VR	M3 x 0.5	10.0	5.6	1.8	0.8	0.7	1000
0120100000VR	M3 x 0.5	12.0	5.6	1.8	0.8	0.7	1000
0120120000VR	M3 x 0.5	16.0	5.6	1.8	0.8	0.7	1000
0120130000VR	M3 x 0.5	20.0	5.6	1.8	0.8	0.7	1000
0120140000VR	M3 x 0.5	25.0	5.6	1.8	0.8	0.7	1000
0120150000VR	M3 x 0.5	30.0	5.5	2.0	0.9	0.8	1000
0121780000VR	M3 x 0.5	35.0	5.5	2.0	0.9	0.8	1000
0121790000VR	M3 x 0.5	40.0	5.5	2.0	0.9	0.8	1000
0120160000VR	M4 x 0.7	6.0	8.0	2.4	1.2	1.0	1000
0120170000VR	M4 x 0.7	8.0	8.0	2.4	1.2	1.0	1000
0120180000VR	M4 x 0.7	10.0	8.0	2.4	1.2	1.0	1000
0120190000VR	M4 x 0.7	12.0	8.0	2.4	1.2	1.0	1000
0120210000VR	M4 x 0.7	16.0	8.0	2.4	1.2	1.0	1000
0120220000VR	M4 x 0.7	20.0	8.0	2.4	1.2	1.0	1000
0120230000VR	M4 x 0.7	25.0	8.0	2.4	1.2	1.0	1000
0120240000VR	M4 x 0.7	30.0	8.0	2.4	1.2	1.0	1000
0120250000VR	M4 x 0.7	40.0	8.0	2.4	1.2	1.0	1000
0120260000VR	M5 x 0.8	6.0	9.5	3.0	1.2	1.2	1000
0120270000VR	M5 x 0.8	8.0	9.5	3.0	1.2	1.2	1000
0120280000VR	M5 x 0.8	10.0	9.5	3.0	1.2	1.2	1000
0120290000VR	M5 x 0.8	12.0	9.5	3.0	1.2	1.2	1000
0120310000VR	M5 x 0.8	16.0	9.5	3.0	1.2	1.2	1000
0120330000VR	M5 x 0.8	20.0	9.5	3.0	1.2	1.2	1000
0120340000VR	M5 x 0.8	25.0	9.5	3.0	1.2	1.2	1000
0120350000VR	M5 x 0.8	30.0	9.5	3.0	1.2	1.2	1000
0120360000VR	M5 x 0.8	40.0	9.5	3.0	1.2	1.2	1000
0121420000VR	M6 x 1.0	5.0	12.0	3.6	1.6	1.4	1000
0120390000VR	M6 x 1.0	6.5	12.0	3.6	1.6	1.4	1000
0120410000VR	M6 x 1.0	8.0	12.0	3.6	1.6	1.4	1000
0120420000VR	M6 x 1.0	10.0	12.0	3.6	1.6	1.4	1000
0120430000VR	M6 x 1.0	12.0	12.0	3.6	1.6	1.4	1000
0120450000VR	M6 x 1.0	16.0	12.0	3.6	1.6	1.4	1000
0120460000VR	M6 x 1.0	20.0	12.0	3.6	1.6	1.4	1000
0120470000VR	M6 x 1.0	22.0	12.0	3.6	1.6	1.4	1000
0120480000VR	M6 x 1.0	25.0	12.0	3.6	1.6	1.4	1000
0120500000VR	M6 x 1.0	30.0	12.0	3.6	1.6	1.4	1000
0120520000VR	M6 x 1.0	40.0	12.0	3.6	1.6	1.4	1000

Part Number	Dimensions (mm)						Std Pack Qty
	d	l	D	l ₁	d ₁	l ₂	
0120530000VR	M6 x 1.0	50.0	12.0	3.6	1.6	1.4	500
0120550000VR	M6 x 1.0	60.0	12.0	3.6	1.6	1.4	500
0120570000VR	M6 x 1.0	70.0	12.0	3.6	1.6	1.4	500
0120590000VR	M6 x 1.0	80.0	12.0	3.6	1.6	1.4	500
0120650000VR	M8 x 1.25	10.0	16.0	4.8	2.0	1.9	1000
0120680000VR	M8 x 1.25	16.0	16.0	4.8	2.0	1.9	1000
0120690000VR	M8 x 1.25	20.0	16.0	4.8	2.0	1.9	1000
0120700000VR	M8 x 1.25	25.0	16.0	4.8	2.0	1.9	1000
0120710000VR	M8 x 1.25	30.0	16.0	4.8	2.0	1.9	1000
0120720000VR	M8 x 1.25	35.0	16.0	4.8	2.0	1.9	1000
0120730000VR	M8 x 1.25	40.0	16.0	4.8	2.0	1.9	1000
0120740000VR	M8 x 1.25	50.0	16.0	4.8	2.0	1.9	500
0120750000VR	M8 x 1.25	60.0	16.0	4.8	2.0	1.9	500
0120760000VR	M8 x 1.25	80.0	16.0	4.8	2.0	1.9	500
0121850000VR	M10 x 1.5	16.0	20.0	6.0	2.5	2.4	500
0120860000VR	M10 x 1.5	20.0	20.0	6.0	2.5	2.4	500
0120880000VR	M10 x 1.5	30.0	20.0	6.0	2.5	2.4	500
0120890000VR	M10 x 1.5	40.0	20.0	6.0	2.5	2.4	500
0120900000VR	M10 x 1.5	50.0	20.0	6.0	2.5	2.4	250
0120910000VR	M10 x 1.5	60.0	20.0	6.0	2.5	2.4	250
0120920000VR	M10 x 1.5	70.0	20.0	6.0	2.5	2.4	250
0120930000VR	M10 x 1.5	80.0	20.0	6.0	2.5	2.4	250

SR 1973 Slotted Round Head Screws

Natural Nylon 6.6

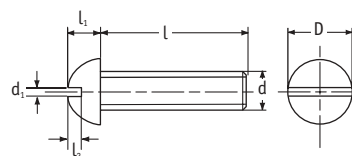

Part Number	Dimensions (mm)						Std Pack Qty
	d	l	D	l ₁	d ₁	l ₂	
0130060000VR	M3 x 0.5	4.0	5.5	2.7	0.8	0.9	1000
0130050000VR	M3 x 0.5	5.0	5.5	2.7	0.8	0.9	1000
0130070000VR	M3 x 0.5	6.0	5.5	2.7	0.8	0.9	1000
0130080000VR	M3 x 0.5	8.0	5.5	2.7	0.8	0.9	1000
0130090000VR	M3 x 0.5	10.0	5.5	2.7	0.8	0.9	1000
0130100000VR	M3 x 0.5	12.0	5.5	2.7	0.8	0.9	1000
0130120000VR	M3 x 0.5	16.0	5.5	2.7	0.8	0.9	1000
0130130000VR	M3 x 0.5	20.0	5.5	2.7	0.8	0.9	1000
0130140000VR	M3 x 0.5	25.0	5.5	2.7	0.8	0.9	1000
0130160000VR	M4 x 0.7	6.0	7.0	3.5	1.0	1.3	1000
0130170000VR	M4 x 0.7	8.0	7.0	3.5	1.0	1.3	1000
0130180000VR	M4 x 0.7	10.0	7.0	3.5	1.0	1.3	1000
0130190000VR	M4 x 0.7	12.0	7.0	3.5	1.0	1.3	1000
0130210000VR	M4 x 0.7	16.0	7.0	3.5	1.0	1.3	1000
0130220000VR	M4 x 0.7	20.0	7.0	3.5	1.0	1.3	1000
0130270000VR	M5 x 0.8	8.0	9.0	4.5	1.1	1.4	1000
0130280000VR	M5 x 0.8	10.0	9.0	4.5	1.1	1.4	1000
0130290000VR	M5 x 0.8	12.0	9.0	4.5	1.1	1.4	1000
0130310000VR	M5 x 0.8	16.0	9.0	4.5	1.1	1.4	1000
0130330000VR	M5 x 0.8	20.0	9.0	4.5	1.1	1.4	1000
0130390000VR	M6 x 1.0	6.5	10.0	5.0	1.6	1.6	1000
0130410000VR	M6 x 1.0	8.0	10.0	5.0	1.6	1.6	1000
0130420000VR	M6 x 1.0	10.0	10.0	5.0	1.6	1.6	1000
0130430000VR	M6 x 1.0	12.0	10.0	5.0	1.6	1.6	1000
0130450000VR	M6 x 1.0	16.0	10.0	5.0	1.6	1.6	1000
0130460000VR	M6 x 1.0	20.0	10.0	5.0	1.6	1.6	1000
0130470000VR	M6 x 1.0	22.0	10.0	5.0	1.6	1.6	1000
0130480000VR	M6 x 1.0	25.0	10.0	5.0	1.6	1.6	1000
0130500000VR	M6 x 1.0	30.0	10.0	5.0	1.6	1.6	1000



Slotted Countersunk and Mushroom Head Screws

SR 1967

Slotted Countersunk Screws

Natural Nylon 6.6

- Conform to dimensional tolerances of: ISO 2009, NF E 25-123, DIN 963

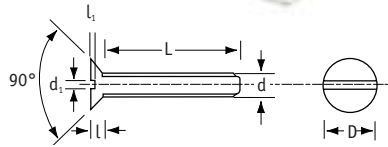

Part Number	Dimensions (mm)						Std Pack Qty
	d	L	D	l	d ₁	l ₁	
0100470000VR	M2 x 0.4	4.0	4.0	1.2	0.6	0.5	1000
0100380000VR	M2 x 0.4	5.0	4.0	1.2	0.6	0.5	1000
0100390000VR	M2 x 0.4	6.0	4.0	1.2	0.6	0.5	1000
0100750000VR	M2 x 0.4	8.0	4.0	1.2	0.6	0.5	1000
0100400000VR	M2 x 0.4	10.0	4.0	1.2	0.6	0.5	1000
0100550000VR	M2 x 0.4	12.0	4.0	1.2	0.6	0.5	1000
0100560000VR	M2 x 0.4	16.0	4.0	1.2	0.6	0.5	1000
0100570000VR	M2 x 0.4	25.0	4.0	1.2	0.6	0.5	1000
0100580000VR	M2.5 x 0.45	4.0	4.7	1.5	0.7	0.6	1000
0100590000VR	M2.5 x 0.45	5.0	4.7	1.5	0.7	0.6	1000
0100040000VR	M2.5 x 0.45	6.0	4.7	1.5	0.7	0.6	1000
0100600000VR	M2.5 x 0.45	8.0	4.7	1.5	0.7	0.6	1000
0100050000VR	M2.5 x 0.45	10.0	4.7	1.5	0.7	0.6	1000
0100610000VR	M2.5 x 0.45	12.0	4.7	1.5	0.7	0.6	1000
0100620000VR	M2.5 x 0.45	16.0	4.7	1.5	0.7	0.6	1000
0100630000VR	M2.5 x 0.45	20.0	4.7	1.5	0.7	0.6	1000
0100640000VR	M2.5 x 0.45	25.0	4.7	1.5	0.7	0.6	1000
0100060000VR	M3 x 0.5	4.0	6.3	1.7	0.8	0.9	1000
0100070000VR	M3 x 0.5	6.0	6.3	1.7	0.8	0.9	1000
0100080000VR	M3 x 0.5	8.0	6.3	1.7	0.8	0.9	1000
0100090000VR	M3 x 0.5	10.0	6.3	1.7	0.8	0.9	1000
0100100000VR	M3 x 0.5	12.0	6.3	1.7	0.8	0.9	1000
0100120000VR	M3 x 0.5	16.0	6.3	1.7	0.8	0.9	1000
0100130000VR	M3 x 0.5	20.0	6.3	1.7	0.8	0.9	1000
0100140000VR	M3 x 0.5	25.0	6.3	1.7	0.8	0.9	1000
0100650000VR	M3 x 0.5	30.0	5.6	1.7	0.9	0.7	1000
0100660000VR	M3 x 0.5	40.0	5.6	1.7	0.9	0.7	1000
0100160000VR	M4 x 0.7	6.0	9.4	2.7	1.2	1.3	1000
0100170000VR	M4 x 0.7	8.0	9.4	2.7	1.2	1.3	1000
0100180000VR	M4 x 0.7	10.0	9.4	2.7	1.2	1.3	1000
0100190000VR	M4 x 0.7	12.0	9.4	2.7	1.2	1.3	1000
0100210000VR	M4 x 0.7	16.0	9.4	2.7	1.2	1.3	1000
0100900000VR	M4 x 0.7	18.0	9.4	2.7	1.2	1.3	1000
0100220000VR	M4 x 0.7	20.0	9.4	2.7	1.2	1.3	1000
0100230000VR	M4 x 0.7	25.0	9.4	2.7	1.2	1.3	1000
0100240000VR	M4 x 0.7	30.0	9.4	2.7	1.2	1.3	1000
0100790000VR	M4 x 0.7	35.0	9.4	2.7	1.2	1.3	1000
0100250000VR	M4 x 0.7	40.0	9.4	2.7	1.2	1.3	1000
0100800000VR	M5 x 0.8	6.0	9.2	2.5	1.4	1.2	1000
0100810000VR	M5 x 0.8	8.0	9.2	2.5	1.4	1.2	1000
0100280000VR	M5 x 0.8	10.0	10.4	2.7	1.2	1.4	1000
0100290000VR	M5 x 0.8	12.0	10.4	2.7	1.2	1.4	1000
0100310000VR	M5 x 0.8	16.0	10.4	2.7	1.2	1.4	1000
0100320000VR	M5 x 0.8	18.0	10.4	2.7	1.2	1.4	1000
0100330000VR	M5 x 0.8	20.0	10.4	2.7	1.2	1.4	1000
0100340000VR	M5 x 0.8	25.0	10.4	2.7	1.2	1.4	1000
0100350000VR	M5 x 0.8	30.0	10.4	2.7	1.2	1.4	1000
0100370000VR	M5 x 0.8	35.0	10.4	2.7	1.2	1.4	1000
0100360000VR	M5 x 0.8	40.0	10.4	2.7	1.2	1.4	1000
0101810000VR	M5 x 0.8	50.0	10.4	2.7	1.2	1.4	1000
0100870000VR	M5 x 0.8	60.0	10.4	2.7	1.2	1.4	500
0100410000VR	M6 x 1.0	8.0	12.6	3.3	1.6	1.6	1000
0100420000VR	M6 x 1.0	10.0	12.6	3.3	1.6	1.6	1000
0100430000VR	M6 x 1.0	12.0	12.6	3.3	1.6	1.6	1000
0100450000VR	M6 x 1.0	16.0	12.6	3.3	1.6	1.6	1000
0100460000VR	M6 x 1.0	20.0	12.6	3.3	1.6	1.6	1000
0100480000VR	M6 x 1.0	25.0	12.6	3.3	1.6	1.6	1000
0100500000VR	M6 x 1.0	30.0	12.6	3.3	1.6	1.6	1000
0100520000VR	M6 x 1.0	40.0	12.6	3.3	1.6	1.6	1000

Part Number	Dimensions (mm)						Std Pack Qty
	d	L	D	l	d ₁	l ₁	
0100530000VR	M6 x 1.0	50.0	12.6	3.3	1.6	1.6	500
0100540000VR	M6 x 1.0	60.0	12.6	3.3	1.6	1.6	500
0100680000VR	M8 x 1.25	16.0	17.3	4.7	2.0	2.3	1000
0100690000VR	M8 x 1.25	20.0	17.3	4.7	2.0	2.3	1000
0100700000VR	M8 x 1.25	25.0	17.3	4.7	2.0	2.3	1000
0100710000VR	M8 x 1.25	30.0	17.3	4.7	2.0	2.3	1000
0100730000VR	M8 x 1.25	40.0	17.3	4.7	2.0	2.3	1000
0100740000VR	M8 x 1.25	50.0	17.3	4.7	2.0	2.3	500
0100760000VR	M8 x 1.25	60.0	17.3	4.7	2.0	2.3	500
0100820000VR	M10 x 1.5	20.0	18.0	5.0	2.6	2.3	500
0100830000VR	M10 x 1.5	25.0	18.0	5.0	2.6	2.3	500
0100840000VR	M10 x 1.5	30.0	18.0	5.0	2.6	2.3	500
0100780000VR	M10 x 1.5	35.0	18.0	5.0	2.6	2.3	500
0100770000VR	M10 x 1.5	40.0	18.0	5.0	2.6	2.3	500
0100850000VR	M10 x 1.5	50.0	18.0	5.0	2.6	2.3	500
0100860000VR	M10 x 1.5	60.0	18.0	5.0	2.6	2.3	250

SR 1971

Slotted Mushroom Head Screws

Natural Nylon 6.6

- Conform to dimensional tolerances of: NF E 25-129

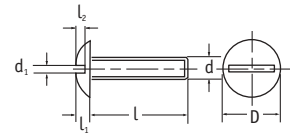

Part Number	Dimensions (mm)						Std Pack Qty
	d	l	D	l ₁	d ₁	l ₂	
0170160000VR	M4 x 0.7	6.0	10.0	2.2	1.2	1.0	1000
0170170000VR	M4 x 0.7	8.0	10.0	2.2	1.2	1.0	1000
0170180000VR	M4 x 0.7	10.0	10.0	2.2	1.2	1.0	1000
0170190000VR	M4 x 0.7	12.0	10.0	2.2	1.2	1.0	1000
0170210000VR	M4 x 0.7	16.0	10.0	2.2	1.2	1.0	1000
0170220000VR	M4 x 0.7	20.0	10.0	2.2	1.2	1.0	1000
0170270000VR	M5 x 0.8	8.0	12.5	2.7	1.2	1.2	1000
0170280000VR	M5 x 0.8	10.0	12.5	2.7	1.2	1.2	1000
0170290000VR	M5 x 0.8	12.0	12.5	2.7	1.2	1.2	1000
0170310000VR	M5 x 0.8	16.0	12.5	2.7	1.2	1.2	1000
0170330000VR	M5 x 0.8	20.0	12.5	2.7	1.2	1.2	1000
0170340000VR	M5 x 0.8	25.0	12.5	2.7	1.2	1.2	1000
0170350000VR	M5 x 0.8	30.0	12.5	2.7	1.2	1.2	1000
0170360000VR	M5 x 0.8	40.0	12.5	2.7	1.2	1.2	1000
0170390000VR	M6 x 1.0	6.5	15.0	3.3	1.6	1.5	1000
0170410000VR	M6 x 1.0	8.0	15.0	3.3	1.6	1.5	1000
0170420000VR	M6 x 1.0	10.0	15.0	3.3	1.6	1.5	1000
0170430000VR	M6 x 1.0	12.0	15.0	3.3	1.6	1.5	1000
0170450000VR	M6 x 1.0	16.0	15.0	3.3	1.6	1.5	1000
0170460000VR	M6 x 1.0	20.0	15.0	3.3	1.6	1.5	1000
0170470000VR	M6 x 1.0	22.0	15.0	3.3	1.6	1.5	1000
0170480000VR	M6 x 1.0	25.0	15.0	3.3	1.6	1.5	1000
0170500000VR	M6 x 1.0	30.0	15.0	3.3	1.6	1.5	1000
0170520000VR	M6 x 1.0	40.0	15.0	3.3	1.6	1.5	1000
0170530000VR	M6 x 1.0	50.0	15.0	3.3	1.6	1.5	500
0170540000VR	M6 x 1.0	60.0	15.0	3.3	1.6	1.5	500
0170550000VR	M6 x 1.0	65.0	15.0	3.3	1.6	1.5	500
0170560000VR	M6 x 1.0	80.0	15.0	3.3	1.6	1.5	500
0170650000VR	M8 x 1.25	10.0	20.0	4.4	2.0	2.0	1000
0170680000VR	M8 x 1.25	16.0	20.0	4.4	2.0	2.0	1000
0170690000VR	M8 x 1.25	20.0	20.0	4.4	2.0	2.0	1000
0170700000VR	M8 x 1.25	25.0	20.0	4.4	2.0	2.0	1000
0170710000VR	M8 x 1.25	30.0	20.0	4.4	2.0	2.0	1000
0170720000VR	M8 x 1.25	35.0	20.0	4.4	2.0	2.0	1000



Crossed Pan Head and Internal Star Drive Screws

SR 1972

Crossed Pan Head Screws

Natural Nylon 6.6

- Conform to dimensional tolerances of: N FE 25-121

new

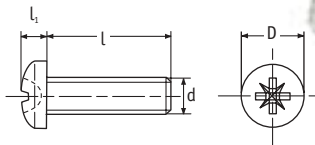

Part Number	Dimensions (mm)				Std Pack Qty
	d	l	D	l ₁	
0082010000VR	M2 x 0.4	4.0	3.8	1.3	1000
0082020000VR	M2 x 0.4	5.0	3.8	1.3	1000
0082030000VR	M2 x 0.4	6.0	3.8	1.3	1000
0082040000VR	M2 x 0.4	8.0	3.8	1.3	1000
0082050000VR	M2 x 0.4	10.0	3.8	1.3	1000
0082060000VR	M2 x 0.4	12.0	3.8	1.3	1000
0082070000VR	M2 x 0.4	16.0	3.8	1.3	1000
0082080000VR	M2 x 0.4	20.0	3.8	1.3	1000
0082090000VR	M2 x 0.4	25.0	3.8	1.3	1000
0082100000VR	M2.5 x 0.45	4.0	4.5	1.6	1000
0082110000VR	M2.5 x 0.45	5.0	4.5	1.6	1000
0082120000VR	M2.5 x 0.45	6.0	4.5	1.6	1000
0082130000VR	M2.5 x 0.45	8.0	4.5	1.6	1000
0082140000VR	M2.5 x 0.45	10.0	4.5	1.6	1000
0082150000VR	M2.5 x 0.45	12.0	4.5	1.6	1000
0082160000VR	M2.5 x 0.45	16.0	4.5	1.6	1000
0082170000VR	M2.5 x 0.45	20.0	4.5	1.6	1000
0082180000VR	M2.5 x 0.45	25.0	4.5	1.6	1000
0080060000VR	M3 x 0.5	4.0	5.6	2.4	1000
0081200000VR	M3 x 0.5	5.0	5.6	2.4	1000
0080070000VR	M3 x 0.5	6.0	5.6	2.4	1000
0080080000VR	M3 x 0.5	8.0	5.6	2.4	1000
0080090000VR	M3 x 0.5	10.0	5.6	2.4	1000
0080100000VR	M3 x 0.5	12.0	5.6	2.4	1000
0080120000VR	M3 x 0.5	16.0	5.6	2.4	1000
0080130000VR	M3 x 0.5	20.0	5.6	2.4	1000
0080140000VR	M3 x 0.5	25.0	5.6	2.4	1000
0080150000VR	M3 x 0.5	30.0	5.6	2.4	1000
0080160000VR	M4 x 0.7	6.0	8.0	3.1	1000
0080170000VR	M4 x 0.7	8.0	8.0	3.1	1000
0080180000VR	M4 x 0.7	10.0	8.0	3.1	1000
0080190000VR	M4 x 0.7	12.0	8.0	3.1	1000
0080200000VR	M4 x 0.7	16.0	8.0	3.1	1000
0080220000VR	M4 x 0.7	18.0	8.0	3.1	1000
0080220000VR	M4 x 0.7	20.0	8.0	3.1	1000
0080230000VR	M4 x 0.7	25.0	8.0	3.1	1000
0080240000VR	M4 x 0.7	30.0	8.0	3.1	1000
0080250000VR	M4 x 0.7	40.0	8.0	3.1	1000
0080260000VR	M5 x 0.8	6.0	9.5	3.7	1000
0080270000VR	M5 x 0.8	8.0	9.5	3.7	1000
0080280000VR	M5 x 0.8	10.0	9.5	3.7	1000
0080290000VR	M5 x 0.8	12.0	9.5	3.7	1000
0080310000VR	M5 x 0.8	16.0	9.5	3.7	1000
0080330000VR	M5 x 0.8	20.0	9.5	3.7	1000
0080340000VR	M5 x 0.8	25.0	9.5	3.7	1000
0080350000VR	M5 x 0.8	30.0	9.5	3.7	1000
0080360000VR	M5 x 0.8	40.0	9.5	3.7	1000
0080370000VR	M5 x 0.8	50.0	9.5	3.7	1000
0080400000VR	M6 x 1.0	6.0	12.0	4.6	1000
0080390000VR	M6 x 1.0	6.5	12.0	4.6	1000
0080410000VR	M6 x 1.0	8.0	12.0	4.6	1000
0080420000VR	M6 x 1.0	10.0	12.0	4.6	1000
0080430000VR	M6 x 1.0	12.0	12.0	4.6	1000
0080450000VR	M6 x 1.0	16.0	12.0	4.6	1000
0080460000VR	M6 x 1.0	20.0	12.0	4.6	1000
0080480000VR	M6 x 1.0	25.0	12.0	4.6	1000
0080500000VR	M6 x 1.0	30.0	12.0	4.6	1000
0080520000VR	M6 x 1.0	40.0	12.0	4.6	1000

Part Number	Dimensions (mm)				Std Pack Qty
	d	l	D	l ₁	
0080530000VR	M6 x 1.0	50.0	12.0	4.6	500
0080550000VR	M6 x 1.0	60.0	12.0	4.6	500
0080650000VR	M8 x 1.25	10.0	16.0	6.0	1000
0080680000VR	M8 x 1.25	16.0	16.0	6.0	1000
0080690000VR	M8 x 1.25	20.0	16.0	6.0	1000
0080700000VR	M8 x 1.25	25.0	16.0	6.0	1000
0080710000VR	M8 x 1.25	30.0	16.0	6.0	1000
0080720000VR	M8 x 1.25	35.0	16.0	6.0	1000
0080730000VR	M8 x 1.25	40.0	16.0	6.0	1000
0080740000VR	M8 x 1.25	50.0	16.0	6.0	500
0080750000VR	M8 x 1.25	60.0	16.0	6.0	500
0081850000VR	M10 x 1.5	16.0	20.0	7.5	500
0080860000VR	M10 x 1.5	20.0	20.0	7.5	500
0080880000VR	M10 x 1.5	30.0	20.0	7.5	500
0081270000VR	M10 x 1.5	40.0	20.0	7.5	500
0080890000VR	M10 x 1.5	50.0	20.0	7.5	250
0080900000VR	M10 x 1.5	60.0	20.0	7.5	250

SR 1975

Flanged Hexagonal Screws with Internal Star Drive

Natural Nylon 6.6

new

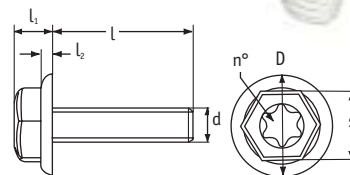

Part Number	Dimensions (mm)							Std Pack Qty
	d	l	l ₁	l ₂	D	s	n°	
0070160000VR	M4 x 0.7	6.0	5.8	2.0	11.5	8.0	20	1000
0070170000VR	M4 x 0.7	8.0	5.8	2.0	11.5	8.0	20	1000
0070180000VR	M4 x 0.7	10.0	5.8	2.0	11.5	8.0	20	1000
0070190000VR	M4 x 0.7	12.0	5.8	2.0	11.5	8.0	20	1000
0070210000VR	M4 x 0.7	16.0	5.8	2.0	11.5	8.0	20	1000
0071820000VR	M4 x 0.7	18.0	5.8	2.0	11.5	8.0	20	1000
0070220000VR	M4 x 0.7	20.0	5.8	2.0	11.5	8.0	20	1000
0070260000VR	M5 x 0.8	6.0	5.8	2.0	11.5	8.0	20	1000
0070270000VR	M5 x 0.8	8.0	5.8	2.0	11.5	8.0	20	1000
0070280000VR	M5 x 0.8	10.0	5.8	2.0	11.5	8.0	20	1000
0070290000VR	M5 x 0.8	12.0	5.8	2.0	11.5	8.0	20	1000
0070310000VR	M5 x 0.8	16.0	5.8	2.0	11.5	8.0	20	1000
0070330000VR	M5 x 0.8	20.0	5.8	2.0	11.5	8.0	20	1000
0070390000VR	M6 x 1.0	6.5	6.6	2.4	14.0	10.0	30	1000
0070410000VR	M6 x 1.0	8.0	6.6	2.4	14.0	10.0	30	1000
0070420000VR	M6 x 1.0	10.0	6.6	2.4	14.0	10.0	30	1000
0070430000VR	M6 x 1.0	12.0	6.6	2.4	14.0	10.0	30	1000
0070450000VR	M6 x 1.0	16.0	6.6	2.4	14.0	10.0	30	1000
0070460000VR	M6 x 1.0	20.0	6.6	2.4	14.0	10.0	30	1000
0070480000VR	M6 x 1.0	25.0	6.6	2.4	14.0	10.0	30	1000
0070500000VR	M6 x 1.0	30.0	6.6	2.4	14.0	10.0	30	1000
0070640000VR	M8 x 1.25	8.0	8.1	2.7	18.0	13.0	40	1000
0070650000VR	M8 x 1.25	10.0	8.1	2.7	18.0	13.0	40	1000
0070680000VR	M8 x 1.25	16.0	8.1	2.7	18.0	13.0	40	1000
0070690000VR	M8 x 1.25	20.0	8.1	2.7	18.0	13.0	40	1000
0070700000VR	M8 x 1.25	25.0	8.1	2.7	18.0	13.0	40	1000
0070710000VR	M8 x 1.25	30.0	8.1	2.7	18.0	13.0	40	1000
0071270000VR	M10 x 1.5	40.0	10.4	3.5	22.0	16.0	50	1000
0070890000VR	M10 x 1.5	50.0	10.4	3.5	22.0	16.0	50	1000
0070900000VR	M10 x 1.5	60.0	10.4	3.5	22.0	16.0	50	1000
0070910000VR	M10 x 1.5	70.0	10.4	3.5	22.0	16.0	50	1000
0070920000VR	M10 x 1.5	80.0	10.4	3.5	22.0	16.0	50	1000



SR 1974

Socket Head Screws

Natural Nylon 6.6

- Conform to dimensional tolerances of:
NF E 25-125, DIN 912

new

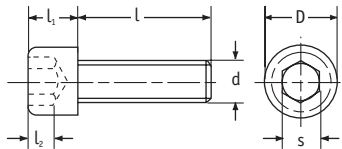

Part Number	Dimensions (mm)						Std Pack Qty
	d	l	D	l ₁	s	l ₂	
016050000VR	M6 x 1.0	6.5	10.0	6.0	5.0	3.0	1000
016049000VR	M6 x 1.0	8.0	10.0	6.0	5.0	3.0	1000
016051000VR	M6 x 1.0	10.0	10.0	6.0	5.0	3.0	1000
016052000VR	M6 x 1.0	12.0	10.0	6.0	5.0	3.0	1000
016054000VR	M6 x 1.0	16.0	10.0	6.0	5.0	3.0	1000
016055000VR	M6 x 1.0	20.0	10.0	6.0	5.0	3.0	1000
016058000VR	M6 x 1.0	22.0	10.0	6.0	5.0	3.0	1000
016056000VR	M6 x 1.0	25.0	10.0	6.0	5.0	3.0	1000
016057000VR	M6 x 1.0	30.0	10.0	6.0	5.0	3.0	1000
016059000VR	M6 x 1.0	40.0	10.0	6.0	5.0	3.0	1000
016060000VR	M6 x 1.0	50.0	10.0	6.0	5.0	3.0	500
016061000VR	M6 x 1.0	60.0	10.0	6.0	5.0	3.0	500
016066000VR	M8 x 1.25	10.0	13.0	8.0	6.0	4.0	1000
016068000VR	M8 x 1.25	16.0	13.0	8.0	6.0	4.0	1000
016070000VR	M8 x 1.25	20.0	13.0	8.0	6.0	4.0	1000
016078000VR	M8 x 1.25	25.0	13.0	8.0	6.0	4.0	1000
016071000VR	M8 x 1.25	30.0	13.0	8.0	6.0	4.0	1000
016072000VR	M8 x 1.25	40.0	13.0	8.0	6.0	4.0	1000
016074000VR	M8 x 1.25	50.0	13.0	8.0	6.0	4.0	500
016075000VR	M8 x 1.25	60.0	13.0	8.0	6.0	4.0	500
016076000VR	M8 x 1.25	70.0	13.0	8.0	6.0	4.0	500
016077000VR	M8 x 1.25	80.0	13.0	8.0	6.0	4.0	500
016185000VR	M10 x 1.5	16.0	16.0	10.0	8.0	5.0	500
016086000VR	M10 x 1.5	20.0	16.0	10.0	8.0	5.0	500
016088000VR	M10 x 1.5	30.0	16.0	10.0	8.0	5.0	500
016087000VR	M10 x 1.5	40.0	16.0	10.0	8.0	5.0	500
016089000VR	M10 x 1.5	50.0	16.0	10.0	8.0	5.0	250
016090000VR	M10 x 1.5	60.0	16.0	10.0	8.0	5.0	250
016091000VR	M10 x 1.5	70.0	16.0	10.0	8.0	5.0	250
016092000VR	M10 x 1.5	80.0	16.0	10.0	8.0	5.0	250
016130000VR	M12 x 1.75	20.0	18.0	12.0	10.0	6.0	250
016101000VR	M12 x 1.75	30.0	18.0	12.0	10.0	6.0	250
016102000VR	M12 x 1.75	40.0	18.0	12.0	10.0	6.0	250
016103000VR	M12 x 1.75	50.0	18.0	12.0	10.0	6.0	250
016104000VR	M12 x 1.75	60.0	18.0	12.0	10.0	6.0	250
016105000VR	M12 x 1.75	70.0	18.0	12.0	10.0	6.0	250
016106000VR	M12 x 1.75	80.0	18.0	12.0	10.0	6.0	250

SR 1976

Thumb Screws

Natural Nylon 6.6

new

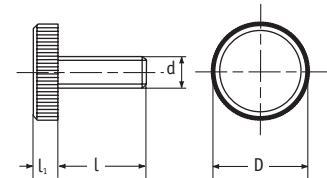

Part Number	Dimensions (mm)				Std Pack Qty
	d	D	l	l ₁	
014023000VR	M4 x 0.7	16.0	25.0	3.4	1000
014024000VR	M4 x 0.7	16.0	30.0	3.4	1000
014025000VR	M4 x 0.7	16.0	40.0	3.4	1000
014032000VR	M5 x 0.8	16.0	15.0	3.4	1000
014033000VR	M5 x 0.8	16.0	20.0	3.4	1000
014034000VR	M5 x 0.8	16.0	25.0	3.4	1000
014035000VR	M5 x 0.8	16.0	30.0	3.4	1000
014036000VR	M5 x 0.8	16.0	40.0	3.4	1000
014039000VR	M6 x 1.0	16.0	6.5	3.4	1000
014041000VR	M6 x 1.0	16.0	8.0	3.4	1000
014042000VR	M6 x 1.0	16.0	10.0	3.4	1000
014043000VR	M6 x 1.0	16.0	12.0	3.4	1000
014045000VR	M6 x 1.0	16.0	16.0	3.4	1000
014046000VR	M6 x 1.0	16.0	20.0	3.4	1000
014047000VR	M6 x 1.0	16.0	22.0	3.4	1000
014048000VR	M6 x 1.0	16.0	25.0	3.4	1000
014050000VR	M6 x 1.0	16.0	30.0	3.4	1000
014065000VR	M8 x 1.25	16.0	10.0	3.4	1000
014068000VR	M8 x 1.25	16.0	16.0	3.4	1000
014069000VR	M8 x 1.25	16.0	20.0	3.4	1000
014070000VR	M8 x 1.25	16.0	25.0	3.4	1000
014071000VR	M8 x 1.25	16.0	30.0	3.4	1000
014072000VR	M8 x 1.25	16.0	35.0	3.4	1000
014185000VR	M10 x 1.5	16.0	16.0	3.4	500
014086000VR	M10 x 1.5	16.0	20.0	3.4	500
014088000VR	M10 x 1.5	16.0	30.0	3.4	500



**We also offer
Allen Keys and Allen
Screw Caps.**

**See page 73 in
our finishing
components
and hardware
section.**



**Please request a free
sample to evaluate
the suitability of
a product for your
application.**



Thumb Screws

SR 1977 Slotted Thumb Screws

Natural Nylon 6.6

new

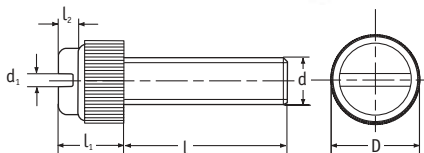

Part Number	Dimensions (mm)						Std Pack Qty
	d	l	D	l ₁	d ₁	l ₂	
033000000VR	M3 x 0.5	4.0	8.1	5.5	1.0	1.1	1000
033001000VR	M3 x 0.5	5.0	8.1	5.5	1.0	1.1	1000
033002000VR	M3 x 0.5	6.0	8.1	5.5	1.0	1.1	1000
033003000VR	M3 x 0.5	8.0	8.1	5.5	1.0	1.1	1000
033004000VR	M3 x 0.5	10.0	8.1	5.5	1.0	1.1	1000
033005000VR	M3 x 0.5	12.0	8.1	5.5	1.0	1.1	1000
033006000VR	M3 x 0.5	16.0	8.1	5.5	1.0	1.1	1000
033007000VR	M3 x 0.5	20.0	8.1	5.5	1.0	1.1	1000
033008000VR	M3 x 0.5	25.0	8.1	5.5	1.0	1.1	1000
033009000VR	M3 x 0.5	30.0	8.1	5.5	1.0	1.1	1000
033013000VR	M4 x 0.7	6.0	10.5	8.1	1.4	1.7	1000
033014000VR	M4 x 0.7	8.0	10.5	8.1	1.4	1.7	1000
033015000VR	M4 x 0.7	10.0	10.5	8.1	1.4	1.7	1000
033016000VR	M4 x 0.7	12.0	10.5	8.1	1.4	1.7	1000
033017000VR	M4 x 0.7	16.0	10.5	8.1	1.4	1.7	1000
033018000VR	M4 x 0.7	20.0	10.5	8.1	1.4	1.7	1000
033019000VR	M4 x 0.7	25.0	10.5	8.1	1.4	1.7	1000
033020000VR	M4 x 0.7	30.0	10.5	8.1	1.4	1.7	1000
033021000VR	M4 x 0.7	35.0	10.5	8.1	1.4	1.7	1000
033022000VR	M4 x 0.7	40.0	10.5	8.1	1.4	1.7	1000
033023000VR	M5 x 0.8	6.0	10.5	8.1	1.4	1.7	1000
033024000VR	M5 x 0.8	8.0	10.5	8.1	1.4	1.7	1000
033025000VR	M5 x 0.8	10.0	10.5	8.1	1.4	1.7	1000
033026000VR	M5 x 0.8	12.0	10.5	8.1	1.4	1.7	1000
033027000VR	M5 x 0.8	16.0	10.5	8.1	1.4	1.7	1000
033028000VR	M5 x 0.8	20.0	10.5	8.1	1.4	1.7	1000
033029000VR	M5 x 0.8	25.0	10.5	8.1	1.4	1.7	1000
033030000VR	M5 x 0.8	30.0	10.5	8.1	1.4	1.7	1000
033031000VR	M5 x 0.8	40.0	10.5	8.1	1.4	1.7	1000
033033000VR	M6 x 1.0	8.0	12.3	8.3	1.5	2.2	1000
033034000VR	M6 x 1.0	10.0	12.3	8.3	1.5	2.2	1000
033035000VR	M6 x 1.0	12.0	12.3	8.3	1.5	2.2	1000
033036000VR	M6 x 1.0	16.0	12.3	8.3	1.5	2.2	1000
033037000VR	M6 x 1.0	20.0	12.3	8.3	1.5	2.2	1000
033039000VR	M6 x 1.0	25.0	12.3	8.3	1.5	2.2	1000
033050000VR	M6 x 1.0	30.0	12.3	8.3	1.5	2.2	1000
033051000VR	M6 x 1.0	40.0	12.3	8.3	1.5	2.2	1000
033041000VR	M6 x 1.0	45.0	12.3	8.3	1.5	2.2	1000
033042000VR	M6 x 1.0	50.0	12.3	8.3	1.5	2.2	500
033043000VR	M6 x 1.0	60.0	12.3	8.3	1.5	2.2	500

SR 1978 Thumb Screws with Internal Socket

Natural Nylon 6.6

new

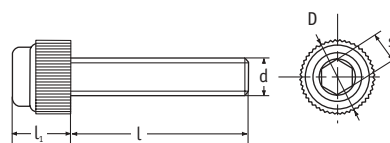

Part Number	Dimensions (mm)					Std Pack Qty
	d	l	D	l ₁	s	
042006000VR	M3 x 0.5	4.0	10.5	5.5	4	1000
042120000VR	M3 x 0.5	5.0	10.5	5.5	4	1000
042007000VR	M3 x 0.5	6.0	10.5	5.5	4	1000
042008000VR	M3 x 0.5	8.0	10.5	5.5	4	1000
042009000VR	M3 x 0.5	10.0	10.5	5.5	4	1000
042010000VR	M3 x 0.5	12.0	10.5	5.5	4	1000
042012000VR	M3 x 0.5	16.0	10.5	5.5	4	1000
042013000VR	M3 x 0.5	20.0	10.5	5.5	4	1000
042014000VR	M3 x 0.5	25.0	10.5	5.5	4	1000
042016000VR	M4 x 0.7	6.0	10.5	8.1	4	1000
042017000VR	M4 x 0.7	8.0	10.5	8.1	4	1000
042018000VR	M4 x 0.7	10.0	10.5	8.1	4	1000
042019000VR	M4 x 0.7	12.0	10.5	8.1	4	1000
042020000VR	M4 x 0.7	15.0	10.5	8.1	4	1000
042022000VR	M4 x 0.7	20.0	10.5	8.1	4	1000
042023000VR	M4 x 0.7	25.0	10.5	8.1	4	1000
042024000VR	M4 x 0.7	30.0	10.5	8.1	4	1000
042025000VR	M4 x 0.7	40.0	10.5	8.1	4	1000
042026000VR	M5 x 0.8	6.0	10.5	8.1	4	1000
042027000VR	M5 x 0.8	8.0	10.5	8.1	4	1000
042028000VR	M5 x 0.8	10.0	10.5	8.1	4	1000
042029000VR	M5 x 0.8	12.0	10.5	8.1	4	1000
042030000VR	M5 x 0.8	15.0	10.5	8.1	4	1000
042031000VR	M5 x 0.8	20.0	10.5	8.1	4	1000
042034000VR	M5 x 0.8	25.0	10.5	8.1	4	1000
042035000VR	M5 x 0.8	30.0	10.5	8.1	4	1000
042036000VR	M5 x 0.8	40.0	10.5	8.1	4	1000
042039000VR	M6 x 1.0	6.5	12.3	8.3	5	1000
042041000VR	M6 x 1.0	8.0	12.3	8.3	5	1000
042042000VR	M6 x 1.0	10.0	12.3	8.3	5	1000
042043000VR	M6 x 1.0	12.0	12.3	8.3	5	1000
042045000VR	M6 x 1.0	16.0	12.3	8.3	5	1000
042046000VR	M6 x 1.0	20.0	12.3	8.3	5	1000
042048000VR	M6 x 1.0	25.0	12.3	8.3	5	1000
042050000VR	M6 x 1.0	30.0	12.3	8.3	5	1000



SR 1979

Wing Screws with Washer

Natural Nylon 6.6

new

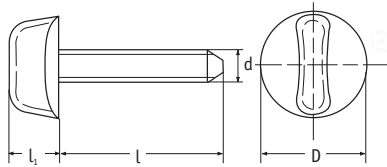

Part Number	Dimensions (mm)				Std Pack Qty
	d	l	D	l ₁	
0270450000VR	M4 x 0.7	6.0	16.0	10.0	1000
0270460000VR	M4 x 0.7	8.0	16.0	10.0	1000
0270470000VR	M4 x 0.7	10.0	16.0	10.0	1000
0270480000VR	M4 x 0.7	12.0	16.0	10.0	1000
0270490000VR	M4 x 0.7	15.0	16.0	10.0	1000
0270520000VR	M4 x 0.7	20.0	16.0	10.0	1000
0270540000VR	M4 x 0.7	25.0	16.0	10.0	1000
0270550000VR	M4 x 0.7	30.0	16.0	10.0	1000
0270560000VR	M4 x 0.7	40.0	16.0	10.0	1000
0270570000VR	M5 x 0.8	6.0	16.0	10.0	1000
0270580000VR	M5 x 0.8	8.0	16.0	10.0	1000
0270210000VR	M5 x 0.8	10.0	16.0	10.0	1000
0270590000VR	M5 x 0.8	15.0	16.0	10.0	1000
0270230000VR	M5 x 0.8	20.0	16.0	10.0	1000
0270240000VR	M5 x 0.8	25.0	16.0	10.0	1000
0270250000VR	M5 x 0.8	30.0	16.0	10.0	1000
0270260000VR	M5 x 0.8	40.0	16.0	10.0	1000
0270610000VR	M6 x 1.0	8.0	25.0	12.0	1000
0270010000VR	M6 x 1.0	10.0	25.0	12.0	1000
0270020000VR	M6 x 1.0	12.0	25.0	12.0	1000
0270620000VR	M6 x 1.0	15.0	25.0	12.0	1000
0270040000VR	M6 x 1.0	20.0	25.0	12.0	1000
0270060000VR	M6 x 1.0	25.0	25.0	12.0	1000
0270070000VR	M6 x 1.0	30.0	25.0	12.0	1000
0270630000VR	M6 x 1.0	40.0	25.0	12.0	1000
0270650000VR	M6 x 1.0	50.0	25.0	12.0	500
0270660000VR	M6 x 1.0	60.0	25.0	12.0	500
0270680000VR	M6 x 1.0	80.0	25.0	12.0	500
0270200000VR	M8 x 1.25	8.0	25.0	12.0	1000
0270080000VR	M8 x 1.25	10.0	25.0	12.0	1000
0270090000VR	M8 x 1.25	16.0	25.0	12.0	1000
0270100000VR	M8 x 1.25	20.0	25.0	12.0	1000
0270110000VR	M8 x 1.25	25.0	25.0	12.0	1000
0270120000VR	M8 x 1.25	30.0	25.0	12.0	1000
0270130000VR	M8 x 1.25	35.0	25.0	12.0	1000
0270140000VR	M8 x 1.25	40.0	25.0	12.0	1000
0270280000VR	M8 x 1.25	50.0	25.0	12.0	500
0270290000VR	M8 x 1.25	60.0	25.0	12.0	500
0270300000VR	M8 x 1.25	70.0	25.0	12.0	500
0270310000VR	M8 x 1.25	80.0	25.0	12.0	500
0270270000VR	M10 x 1.5	16.0	25.0	12.0	500
0270160000VR	M10 x 1.5	20.0	25.0	12.0	500
0270170000VR	M10 x 1.5	30.0	25.0	12.0	500
0270320000VR	M10 x 1.5	40.0	25.0	12.0	500
0270330000VR	M10 x 1.5	50.0	25.0	12.0	250
0270340000VR	M10 x 1.5	60.0	25.0	12.0	250
0270350000VR	M10 x 1.5	70.0	25.0	12.0	250
0270360000VR	M10 x 1.5	80.0	25.0	12.0	250
0270370000VR	M12 x 1.5	16.0	25.0	12.0	500
0270380000VR	M12 x 1.5	20.0	25.0	12.0	500
0270390000VR	M12 x 1.5	30.0	25.0	12.0	500
0270400000VR	M12 x 1.5	40.0	25.0	12.0	500
0270410000VR	M12 x 1.5	50.0	25.0	12.0	250
0270420000VR	M12 x 1.5	60.0	25.0	12.0	250
0270430000VR	M12 x 1.5	70.0	25.0	12.0	250
0270440000VR	M12 x 1.5	80.0	25.0	12.0	250

SR 1980

Square Head Screws

Natural Nylon 6.6

new

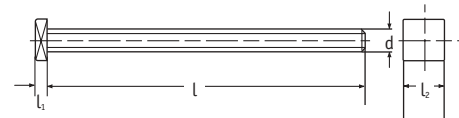

Part Number	Dimensions (mm)				Std Pack Qty
	d	l	l ₁	l ₂	
0900530000VR	M6 x 1.0	40.0	3.0	10 x 10	1000
0900540000VR	M6 x 1.0	50.0	3.0	10 x 10	500
0900550000VR	M6 x 1.0	60.0	3.0	10 x 10	500
0900570000VR	M6 x 1.0	80.0	3.0	10 x 10	500
0900580000VR	M6 x 1.0	100.0	3.0	10 x 10	250
0900600000VR	M8 x 1.25	40.0	3.0	10 x 10	1000
0900610000VR	M8 x 1.25	50.0	3.0	10 x 10	500

SR 1985

Threaded Rod

Natural Nylon 6.6

new

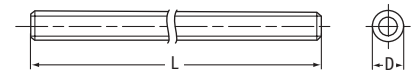

Part Number	Dimensions (mm)		Std Pack Qty
	D	L	
0060010000VR	M3 x 0.5	1000	10
0060020000VR	M4 x 0.7	1000	10
0060030000VR	M5 x 0.8	1000	10
0060040000VR	M6 x 1.0	1000	10
0060050000VR	M8 x 1.25	1000	10
0060060000VR	M10 x 1.5	1000	5
0060070000VR	M12 x 1.75	1000	5
0060080000VR	M14 x 2.0	1000	5
0060090000VR	M16 x 2.0	1000	5
0060100000VR	M18 x 2.5	1000	5
0060110000VR	M20 x 2.5	1000	5
0060120000VR	M24 x 3.0	1000	5

Supplied in one-metre lengths.



Self-Locking, Hexagonal, Dome and Washer Nuts

SR 1954

Hexagonal Nuts

Natural Nylon 6.6

- Conform to dimensional tolerances of:
NF E 2403, ISO 4032, DIN 555, DIN 934

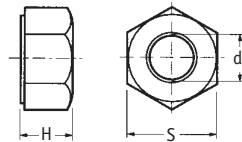

extended range

Part Number	Dimensions (mm)			Std Pack Qty
	d	H	S	
0030140000VR	M2 x 0.4	1.6	4.0	1000
0030160000VR	M2.5 x 0.45	2.0	5.0	1000
0030010000VR	M3 x 0.5	2.4	5.5	1000
0030020000VR	M4 x 0.7	3.2	7.0	1000
0030030000VR	M5 x 0.8	4.2	8.0	1000
0030040000VR	M6 x 1.0	5.0	10.0	1000
0030050000VR	M8 x 1.25	6.5	13.0	1000
0030060000VR	M10 x 1.5	8.0	17.0	1000
0030070000VR	M12 x 1.75	10.8	18.0	500
0030080000VR	M14 x 2.0	12.8	21.0	500
0030090000VR	M16 x 2.0	14.8	24.0	250
0030110000VR	M20 x 2.5	18.0	30.0	250
0030120000VR	M24 x 3.0	21.5	36.0	250

SR 1987

Self-Locking Nuts

Natural Nylon 6.6

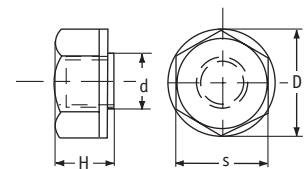

extended range

Part Number	d	Dimensions (mm)			Std Pack Qty
		D	H	s	
0600010000VR	M3 x 0.5	6.9	4.7	6.0	1000
0600020000VR	M4 x 0.7	8.3	5.5	7.0	1000
0600030000VR	M5 x 0.8	9.5	6.5	8.0	1000
0600040000VR	M6 x 1.0	11.4	7.3	10.0	1000
0600050000VR	M8 x 1.25	16.2	9.0	14.0	1000

SR 1955

Dome Nuts

Natural Nylon 6.6

- Conform to dimensional tolerances of:
NF E 27-453, DIN 1587

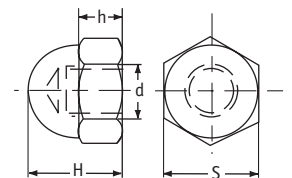

extended range

Part Number	d	Dimensions (mm)			Std Pack Qty
		H	h	S	
0550010000VR	M3 x 0.5	6.0	3.0	5.5	1000
0550020000VR	M4 x 0.7	8.0	3.2	7.0	1000
0550030000VR	M5 x 0.8	10.0	4.0	8.0	1000
0550040000VR	M6 x 1.0	12.0	5.0	10.0	1000
0550050000VR	M8 x 1.25	15.0	6.5	13.0	1000
0550060000VR	M10 x 1.5	18.0	8.0	17.0	1000
0550070000VR	M12 x 1.75	22.0	10.0	19.0	500

SR 1966

Washer Nuts

Natural Nylon 6.6

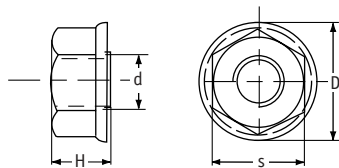

extended range

Part Number	Dimensions (mm)				Std Pack Qty
	d	D	H	s	
43534	M3 x 0.5	6.6	3.1	5.5	1000
43535	M4 x 0.7	8.8	3.8	7.0	1000
43536	M5 x 0.8	9.8	5.0	8.0	1000
43537	M6 x 1.0	13.0	6.0	10.0	1000
43538	M8 x 1.25	17.0	8.0	13.0	1000
43539	M10 x 1.5	22.0	9.5	17.0	1000
0590070000	M12 x 1.75	28.0	14.4	18.7	1000
0590090000	M16 x 2.0	36.0	15.8	23.7	1000

**Can't find the part you are looking for?
Thousands of other products are available –
contact our sales office on 01865 844572.**



SR 1989 Knurled Nuts

new



- Type 1 - conical
- Type 2 - standard

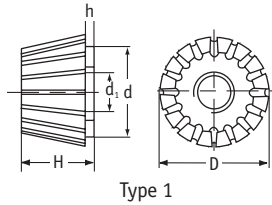
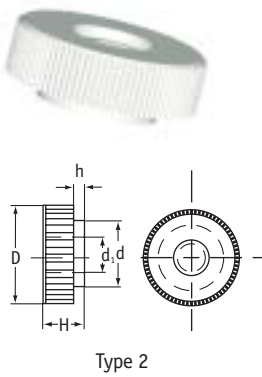

Type 1

Part Number	Dimensions (mm)					Std Pack Qty
	d	D	d ₁	H	h	
0580020000VR	M4 x 0.7	16.0	14.0	12.0	1.0	1000
0580030000VR	M5 x 0.8	16.0	14.0	12.0	1.0	1000
0580040000VR	M6 x 1.0	16.0	14.0	12.0	1.0	1000
0580050000VR	M8 x 1.25	16.0	14.0	12.0	1.0	1000

Type 2

Part Number	Dimensions (mm)					Std Pack Qty
	d	D	d ₁	H	h	
0660010000VR	M3 x 0.5	16.0	10.0	6.0	1.4	1000
0660020000VR	M4 x 0.7	16.0	10.0	6.0	1.4	1000
0660030000VR	M5 x 0.8	16.0	10.0	6.0	1.4	1000
0660040000VR	M6 x 1.0	16.0	10.0	6.0	1.4	1000

SR 1988 Fly Nuts

new

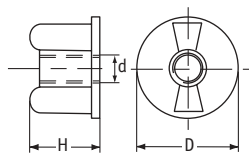

Part Number	Dimensions (mm)			Std Pack Qty
	d	D	H	
0680020000VR	M4 x 0.7	22.0	13.0	1000
0680030000VR	M5 x 0.8	22.0	13.0	1000
0680100000VR	M6 x 1.0	22.0	13.0	1000

SR 1956 Wing Nuts

new



- Type 1 - small head
- Type 2 - larger wings for ease of turning
- Type 3 - includes washer

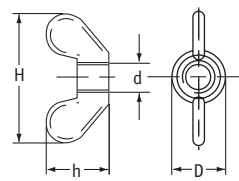

Type 1

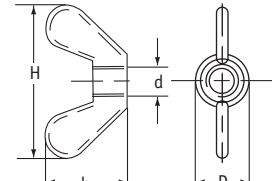

Type 2

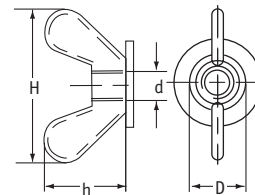

Type 3

Part Number	Type	Dimensions (mm)				Std Pack Qty
		d	D	H	h	
0480510000VR	1	M3 x 0.5	10.0	25.0	12.0	1000
0480520000VR	1	M4 x 0.7	10.0	25.0	12.0	1000
0480530000VR	1	M5 x 0.8	10.0	25.0	12.0	1000
0480540000VR	1	M6 x 1.0	10.0	25.0	12.0	1000
0500020000VR	2	M4 x 0.7	14.0	35.0	22.0	1000
0500030000VR	2	M5 x 0.8	14.0	35.0	22.0	1000
0500040000VR	2	M6 x 1.0	14.0	35.0	22.0	1000
0500050000VR	2	M8 x 1.25	14.0	35.0	22.0	1000
0500060000VR	2	M10 x 1.5	17.0	41.0	25.0	1000
0510020000VR	3	M4 x 0.7	24.0	35.0	24.0	1000
0510030000VR	3	M5 x 0.8	24.0	35.0	24.0	1000
0510040000VR	3	M6 x 1.0	24.0	35.0	24.0	1000
0510050000VR	3	M8 x 1.25	24.0	35.0	24.0	1000

Urgent Deliveries

We can arrange special deliveries to suit your very urgent needs. Just call us.





Tapping Screws

SR 1981

Hexagonal Tapping Screws

Black Polyphthalamide 45% Glass Filled

- Conform to dimensional tolerances of: NF E 25-662

new

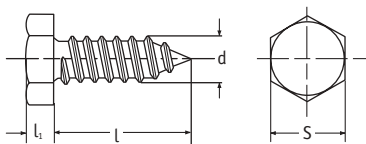

Part Number	Dimensions (mm)				Std Pack Qty
	d	l	l ₁	S	
6220111301VR	3.5	6.5	2.8	7.0	1000
6220121301VR	3.5	9.5	2.8	7.0	1000
6220131301VR	3.5	13.0	2.8	7.0	1000
6220141301VR	3.5	16.0	2.8	7.0	1000
6220181301VR	4.2	9.5	2.8	7.0	1000
6220191301VR	4.2	13.0	2.8	7.0	1000
6220201301VR	4.2	16.0	2.8	7.0	1000
6220251301VR	4.8	9.5	3.5	8.0	1000
6220261301VR	4.8	13.0	3.5	8.0	1000
6220271301VR	4.8	16.0	3.5	8.0	1000
6220281301VR	4.8	19.0	3.5	8.0	1000
6220291301VR	4.8	22.0	3.5	8.0	1000
6220321301VR	4.8	38.0	3.5	8.0	1000
6220331301VR	5.5	13.0	3.5	8.0	1000
6220351301VR	5.5	19.0	3.5	8.0	1000
6220411301VR	6.3	16.0	4.0	10.0	1000
6220421301VR	6.3	19.0	4.0	10.0	1000
6220441301VR	6.3	25.0	4.0	10.0	1000
6220551301VR	8.0	50.0	5.3	13.0	500
6220701301VR	9.5	60.0	6.4	17.0	500

Other sizes available; please contact our sales office for more details.

SR 1982

Slotted Pan Head Tapping Screws

Black Polyphthalamide 45% Glass Filled

- Conform to dimensional tolerances of: NF E 25-663

new

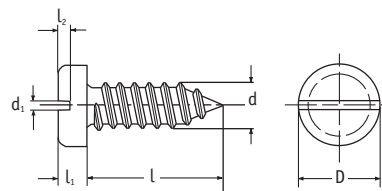

Part Number	Dimensions (mm)						Std Pack Qty
	d	l	l ₁	D	d ₁	l ₂	
6630111301VR	3.5	6.5	1.8	5.6	0.8	0.7	1000
6630121301VR	3.5	9.5	1.8	5.6	0.8	0.7	1000
6630131301VR	3.5	13.0	1.8	5.6	0.8	0.7	1000
6630141301VR	3.5	16.0	1.8	5.6	0.8	0.7	1000
6630181301VR	4.2	9.5	2.4	8.0	1.2	1.0	1000
6630191301VR	4.2	13.0	2.4	8.0	1.2	1.0	1000
6630201301VR	4.2	16.0	2.4	8.0	1.2	1.0	1000
6630251301VR	4.8	9.5	3.0	9.5	1.2	1.2	1000
6630261301VR	4.8	13.0	3.0	9.5	1.2	1.2	1000
6630271301VR	4.8	16.0	3.0	9.5	1.2	1.2	1000
6630281301VR	4.8	19.0	3.0	9.5	1.2	1.2	1000
6630291301VR	4.8	22.0	3.0	9.5	1.2	1.2	1000
6630321301VR	4.8	38.0	3.0	9.5	1.2	1.2	1000
6630331301VR	5.5	13.0	3.0	9.5	1.2	1.2	1000
6630351301VR	5.5	19.0	3.0	9.5	1.2	1.2	1000
6630411301VR	6.3	16.0	3.6	12.0	1.6	1.4	1000
6630421301VR	6.3	19.0	3.6	12.0	1.6	1.4	1000
6630441301VR	6.3	25.0	3.6	12.0	1.6	1.4	1000
6630551301VR	8.0	50.0	4.8	16.0	2.0	1.9	500
6630701301VR	9.5	60.0	6.0	20.0	2.5	2.4	500

Other sizes available; please contact our sales office for more details.

SR 1983

Crossed Pan Head Tapping Screws

Black Polyphthalamide 45% Glass Filled

- Conform to dimensional tolerances of: NF E 25-658

new

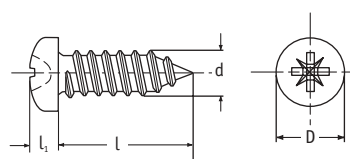

Part Number	Dimensions (mm)				Std Pack Qty
	d	l	D	l ₁	
6580111301VR	3.5	6.5	8.0	3.1	1000
6580121301VR	3.5	9.5	8.0	3.1	1000
6580131301VR	3.5	13.0	8.0	3.1	1000
6580141301VR	3.5	16.0	8.0	3.1	1000
6580181301VR	4.2	9.5	8.0	3.1	1000
6580191301VR	4.2	13.0	8.0	3.1	1000
6580201301VR	4.2	16.0	8.0	3.1	1000
6580251301VR	4.8	9.5	9.5	3.7	1000
6580261301VR	4.8	13.0	9.5	3.7	1000
6580271301VR	4.8	16.0	9.5	3.7	1000
6580281301VR	4.8	19.0	9.5	3.7	1000
6580291301VR	4.8	22.0	9.5	3.7	1000
6580321301VR	4.8	38.0	9.5	3.7	1000
6580331301VR	5.5	13.0	9.5	3.7	1000
6580351301VR	5.5	19.0	9.5	3.7	1000
6580411301VR	6.3	16.0	12.0	4.6	1000
6580421301VR	6.3	19.0	12.0	4.6	1000
6580441301VR	6.3	25.0	12.0	4.6	1000
6580551301VR	8.0	50.0	16.0	6.0	500
6580701301VR	9.5	60.0	20.0	7.5	500

Other sizes available; please contact our sales office for more details.



SR 1984

Flanged Hexagon Tapping Screw with Internal Star Drive

Black Polyphthalamide 45% Glass Filled

new

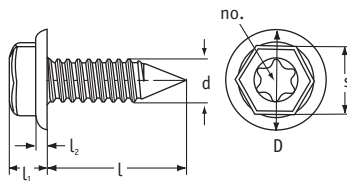

Part Number	Dimensions (mm)							Std Pack Qty
	d	l	l ₁	D	l ₂	s	no.	
6640111301VR	3.5	6.5	5.8	11.5	2.0	8.0	20	1000
6640121301VR	3.5	9.5	5.8	11.5	2.0	8.0	20	1000
6640131301VR	3.5	13.0	5.8	11.5	2.0	8.0	20	1000
6640141301VR	3.5	16.0	5.8	11.5	2.0	8.0	20	1000
6640181301VR	4.2	9.5	5.8	11.5	2.0	8.0	20	1000
6640191301VR	4.2	13.0	5.8	11.5	2.0	8.0	20	1000
6640201301VR	4.2	16.0	5.8	11.5	2.0	8.0	20	1000
6640251301VR	4.8	9.5	5.8	11.5	2.0	8.0	20	1000
6640261301VR	4.8	13.0	5.8	11.5	2.0	8.0	20	1000
6640271301VR	4.8	16.0	5.8	11.5	2.0	8.0	20	1000
6640281301VR	4.8	19.0	5.8	11.5	2.0	8.0	20	1000
6640291301VR	4.8	22.0	5.8	11.5	2.0	8.0	20	1000
6640321301VR	4.8	38.0	5.8	11.5	2.0	8.0	20	1000
6640331301VR	5.5	13.0	6.6	14.0	2.4	10.0	30	1000
6640351301VR	5.5	19.0	6.6	14.0	2.4	10.0	30	1000
6640411301VR	6.3	16.0	6.6	14.0	2.4	10.0	30	1000
6640421301VR	6.3	19.0	6.6	14.0	2.4	10.0	30	1000
6640441301VR	6.3	25.0	6.6	14.0	2.4	10.0	30	1000
6640551301VR	8.0	50.0	8.1	18.0	2.7	13.0	40	500
6640701301VR	9.5	60.0	10.4	22.0	3.5	16.0	50	500

SR 1948

Insulation Sleeves

Natural Nylon 6

- Prevent contact with conducting materials
- Help prevent parts vibrating loose
- Accurately locate and space assemblies

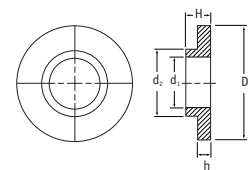

Part Number	Dimensions (mm)					Std Pack Qty
	d ₁	d ₂	D	H	h	
S36573	2.6	3.9	10.0	3.0	1.3	1000
S36575	3.1	3.9	10.0	3.0	1.3	1000
S36576	3.1	4.9	10.0	3.0	1.3	1000
S36578	3.1	5.9	10.0	3.0	1.3	1000
36640	3.1	6.9	15.0	3.5	1.5	1000
36641	3.1	7.9	15.0	3.5	1.5	1000
36642	3.1	8.9	15.0	3.5	1.5	1000
36643	3.1	9.9	15.0	3.5	1.5	1000
34913	4.2	4.9	10.0	3.0	1.3	1000
S36645	4.2	5.9	10.0	3.0	1.3	1000
S36646	4.2	6.9	15.0	3.0	1.5	1000
36647	4.2	7.9	15.0	3.5	1.5	1000
36648	4.2	8.9	15.0	3.5	1.5	1000
S36649	4.2	9.9	15.0	3.5	1.5	1000
36651	4.2	11.9	18.0	3.5	1.5	1000
S34914	5.2	5.9	10.0	3.0	1.3	1000
S36652	5.2	6.9	15.0	3.5	1.5	1000
S36653	5.2	7.9	15.0	3.5	1.5	1000
36654	5.2	8.9	15.0	3.5	1.5	1000
36555	5.2	9.9	15.0	3.5	1.5	1000
S36656	5.2	10.9	18.0	3.5	1.5	1000
36662	5.2	11.9	18.0	3.5	1.5	1000
34915	6.2	6.9	15.0	3.5	1.5	1000
S36658	6.2	7.9	15.0	3.5	1.5	1000
S36659	6.2	8.9	15.0	3.5	1.5	1000
36660	6.2	9.9	15.0	3.5	1.5	1000
36657	6.2	11.9	18.0	3.5	1.5	1000
S36663	8.2	8.9	15.0	3.5	1.5	1000
S36664	8.2	9.9	15.0	3.5	1.5	1000
S36665	8.2	10.9	18.0	3.5	1.5	1000
S36666	8.2	11.9	18.0	3.5	1.5	1000
S34916	10.2	10.9	18.0	3.5	1.5	1000
S36667	10.2	11.9	18.0	3.5	1.5	1000
43755	12.2	13.8	25.0	4.0	2.0	1000
43756	12.2	14.8	25.0	4.0	2.0	1000
43757	12.2	15.8	25.0	4.0	2.0	1000
43758	12.2	17.8	25.0	4.0	2.0	1000
43759	14.2	15.8	25.0	4.0	2.0	1000
43760	14.2	17.8	25.0	4.0	2.0	1000
43761	16.2	17.8	25.0	4.0	2.0	1000

40 stock sizes, others available; please contact our sales office for more details.

Over 400 million parts in stock for a rapid response to your order





DIN and NF E Washers

SR 1940 Washers, NF E 25-513/25-514

Natural Nylon 6.6

- Conform to dimensional tolerances of standard

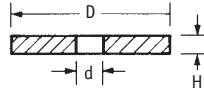

Part Number	Size	Dimensions (mm)			Std Pack Qty
		d	D	H	
0040020000VR	M2	2.2	5.5	0.5	1000
0040040000VR	M2.5	2.7	7.0	0.5	1000
0040060000VR	M3	3.2	8.0	0.8	1000
0040120000VR	M4	4.3	10.0	0.8	1000
0040220000VR	M5	5.3	12.0	1.0	1000
0040290000VR	M6	6.4	14.0	1.2	1000
0040390000VR	M8	8.4	18.0	1.5	1000
0040450000VR	M10	10.5	22.0	2.0	1000
0040530000VR	M12	13.0	27.0	2.5	500
0040550000VR	M14	15.0	30.0	2.5	500
0040640000VR	M16	17.0	32.0	3.0	250
0040650000VR	M18	19.0	36.0	3.0	250
0040700000VR	M20	21.0	40.0	3.0	250
0040750000VR	M24	25.0	50.0	4.0	250
0040800000VR	M30	31.0	60.0	4.0	250

SR 1940 Washers, DIN 125

Natural Nylon 6.6

- Conform to dimensional tolerances of standard



Part Number	Size	Dimensions (mm)			Std Pack Qty
		d	D	H	
0050010000VR	M2	2.2	5.0	0.3	1000
0050780000VR	M2.5	2.7	6.0	0.5	1000
0050040000VR	M3	3.2	7.0	0.5	1000
0050920000VR	M3.5	3.7	8.0	0.5	1000
0050150000VR	M4	4.3	9.0	0.8	1000
0050230000VR	M5	5.3	10.0	1.0	1000
0050320000VR	M6	6.4	12.0	1.6	1000
0050410000VR	M8	8.4	16.0	1.6	1000
0050470000VR	M10	10.5	20.0	2.0	1000
0050550000VR	M12	13.0	24.0	2.5	500
0050610000VR	M14	15.0	30.0	3.0	500
0050650000VR	M16	17.0	30.0	3.0	250
0050700000VR	M18	19.0	34.0	3.0	250
0051010000VR	M20	21.0	37.0	3.0	250
0051030000VR	M24	25.0	44.0	4.0	250
0051270000VR	M27	28.0	50.0	4.0	250
0051300000VR	M30	31.0	56.0	4.0	250
0051360000VR	M36	37.0	66.0	5.0	250
0051390000VR	M39	40.0	72.0	6.0	250

SR 1940 Washers, DIN 433

Natural Nylon 6.6

- Conform to dimensional tolerances of standard



Part Number	Size	Dimensions (mm)			Std Pack Qty
		d	D	H	
1010050000VR	M3	3.2	6.0	0.5	1000
1010140000VR	M4	4.3	8.0	0.5	1000
1010260000VR	M5	5.3	9.0	1.0	1000
1010310000VR	M6	6.4	11.0	1.6	1000
1010360000VR	M8	8.4	15.0	1.6	1000
1010460000VR	M10	10.5	18.0	1.6	1000
1010540000VR	M12	13.0	20.0	2.0	500
1010640000VR	M14	15.0	24.0	2.5	500
1010700000VR	M16	17.0	28.0	2.5	250
1010750000VR	M20	21.0	34.0	3.0	250
1010780000VR	M24	25.0	39.0	4.0	250
1010800000VR	M30	31.0	50.0	4.0	250

SR 1940 Washers, DIN 9021

Natural Nylon 6.6

- Conform to dimensional tolerances of standard



Part Number	Size	Dimensions (mm)			Std Pack Qty
		d	D	H	
1020070000VR	M3	3.2	9.0	0.8	1000
1020160000VR	M4	4.3	12.0	1.0	1000
1020250000VR	M5	5.3	15.0	1.2	1000
1020340000VR	M6	6.4	18.0	1.6	1000
1020420000VR	M8	8.4	24.0	2.0	1000
1020480000VR	M10	10.5	30.0	2.5	1000
1020580000VR	M12	13.0	37.0	3.0	500
1020630000VR	M16	17.0	50.0	3.0	250
1020650000VR	M18	20.0	56.0	4.0	250
1020680000VR	M20	22.0	60.0	4.0	250
1020700000VR	M24	26.0	72.0	5.0	250



SR 1940

Washers

Natural Nylon 6.6

- Insulate against moisture and electricity
- Resist corrosion, abrasion and most chemicals
- Provide full insulation, cushioning and spacing

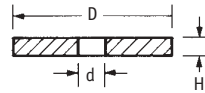

Part Number	Dimensions (mm)			Std Pack Qty
	d	D	H	
8042560000VR	2.2	5.0	0.5	1000
8042780000VR	2.2	5.0	1.0	1000
8042690000VR	2.3	4.8	0.5	1000
1006440000VR	2.5	8.0	1.0	1000
1110210400VR	2.6	5.0	2.0	1000
1110220400VR	2.6	5.0	3.0	1000
1006450000VR	2.7	5.0	1.0	1000
1001080000VR	2.7	9.0	1.0	1000
1008360000VR	2.7	10.0	1.0	1000
1008370000VR	2.7	12.0	1.0	1000
1007870000VR	3.0	7.0	1.0	1000
1007880000VR	3.0	8.0	2.5	1000
1009920000VR	3.0	10.0	2.0	1000
1110300400VR	3.1	5.0	2.0	1000
1110310400VR	3.1	5.0	3.0	1000
1006020000VR	3.1	6.0	1.0	1000
1112130000VR	3.1	8.0	3.0	1000
1005190000VR	3.2	6.0	2.0	1000
1006500000VR	3.2	7.0	1.4	1000
8042400000VR	3.2	7.2	1.0	1000
1001120000VR	3.2	8.1	1.5	1000
1000080000VR	3.2	10.0	0.8	1000
1008010000VR	3.2	12.8	0.8	1000
1006530000VR	3.3	8.0	1.0	1000
1008330000VR	3.5	7.0	1.0	1000
1001130000VR	3.6	6.0	2.5	1000
1005220000VR	3.6	8.0	0.8	1000
1008020000VR	3.7	7.0	0.5	1000
1009930000VR	4.0	7.0	2.0	1000
1000630000VR	4.0	17.5	3.2	1000
1006540000VR	4.1	10.0	1.0	1000
1001170000VR	4.2	8.0	1.2	1000
1001180000VR	4.2	8.0	2.0	1000
1110560000VR	4.2	8.0	3.0	1000
1009790000VR	4.2	9.0	2.5	1000
0040080000VR	4.2	10.0	0.8	1000
1001200000VR	4.2	10.0	1.0	1000
1001210000VR	4.2	10.0	1.2	1000
1007900000VR	4.2	10.0	1.5	1000
1000130000VR	4.2	10.0	2.0	1000
1008030000VR	4.3	7.0	0.5	1000
1006550000VR	4.3	7.0	2.0	1000
1008040000VR	4.3	8.0	0.8	1000
1006570000VR	4.3	9.0	1.4	1000
1008130000VR	4.3	10.0	1.0	1000
1008050000VR	4.3	12.8	0.8	1000
1000750000VR	4.3	18.0	1.5	1000
1006590000VR	4.3	18.0	2.0	1000
1004710000VR	4.4	12.0	2.0	1000
1005090000VR	4.5	26.0	2.0	1000
1008060000VR	4.9	8.0	0.8	1000
1008070000VR	4.9	9.0	0.8	1000

Part Number	Dimensions (mm)			Std Pack Qty
	d	D	H	
1008080000VR	4.9	10.0	0.8	1000
1006610000VR	4.9	12.7	1.4	1000
1006620000VR	4.9	12.7	3.2	1000
1008280000VR	4.9	12.8	0.8	1000
1006630000VR	4.9	15.9	2.5	1000
1006640000VR	4.9	22.2	1.0	1000
1007910000VR	5.0	12.0	1.0	1000
1005030000VR	5.1	11.1	2.4	1000
1008660000VR	5.2	8.0	2.0	1000
1008380000VR	5.2	9.0	1.0	1000
1000210000VR	5.2	10.0	1.0	1000
1001240000VR	5.2	10.0	3.0	1000
0040100000VR	5.2	12.0	1.0	1000
1006070000VR	5.2	12.0	2.0	1000
1000310000VR	5.3	10.1	1.0	1000
1007090000VR	5.3	12.0	1.6	1000
1007100000VR	5.3	12.5	1.6	1000
1020180000VR	5.3	15.0	1.5	1000
1020260000VR	5.3	15.0	1.6	1000
1007110000VR	5.3	17.0	1.6	1000
1007080000VR	5.3	18.0	1.5	1000
1006100000VR	5.3	20.0	3.0	1000
1008090000VR	5.5	8.0	0.8	1000
1001890000VR	5.5	9.0	0.8	1000
1008100000VR	5.5	10.0	0.8	1000
1008110000VR	5.5	12.8	0.8	1000
1008300000VR	5.7	9.0	2.3	1000
1005320000VR	5.8	10.0	0.8	1000
1002530000VR	6.0	12.0	1.0	1000
1000260000VR	6.1	10.0	1.0	1000
1000270000VR	6.1	11.0	1.0	1000
1000280000VR	6.1	16.0	1.0	1000
1008680000VR	6.2	10.0	1.0	1000
1001310000VR	6.2	12.0	1.0	1000
1001320000VR	6.2	12.0	2.0	1000
1001330000VR	6.2	12.0	3.0	1000
0040140000VR	6.2	14.0	1.2	1000
1008700000VR	6.2	16.0	1.0	1000
1004570000VR	6.2	22.0	2.0	1000
1007920000VR	6.3	14.0	1.0	1000
1006670000VR	6.4	10.0	2.5	1000
0050300000VR	6.4	12.5	1.6	1000
1002300000VR	6.4	14.0	1.5	1000
1007510000VR	6.4	15.0	1.5	1000
1008200000VR	6.4	15.0	1.6	1000
1008210000VR	6.4	16.0	1.6	1000
1000330000VR	6.4	17.0	1.6	1000
1020200000VR	6.4	18.0	1.5	1000
1007050000VR	6.4	18.0	2.0	1000
1007190000VR	6.4	20.0	2.0	1000
1007230000VR	6.4	21.0	2.0	1000
1007280000VR	6.4	22.0	2.0	1000
1007320000VR	6.4	24.0	2.0	1000
8041690000VR	6.4	25.0	1.6	1000
1006680000VR	6.4	30.0	3.0	1000
1002380000VR	6.5	15.9	0.5	1000
8042220000VR	6.5	16.5	2.5	1000
1002470000VR	6.6	9.0	1.0	1000
1007130000VR	7.5	18.0	1.5	1000
1007140000VR	7.5	18.0	2.0	1000
1009800000VR	7.5	20.0	2.0	1000
1007240000VR	7.5	21.0	2.0	1000
1009750000VR	7.5	22.0	1.5	1000
1005890000VR	7.5	22.0	2.0	1000
1009810000VR	7.5	24.0	2.0	1000
1007300000VR	7.7	12.0	2.0	1000
1006710000VR	8.1	14.0	1.0	1000
8041120000VR	8.1	14.0	2.0	1000
1007930000VR	8.1	14.0	3.0	1000
1000360000VR	8.1	15.0	3.0	1000
1000370000VR	8.1	16.0	1.0	1000
1008730000VR	8.2	12.0	1.0	1000
1008740000VR	8.2	12.0	2.0	1000

CONTINUED ON NEXT PAGE



Washers

Washers *CONTINUED*

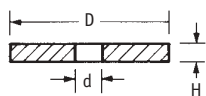

Part Number	Dimensions (mm)			Std Pack Qty
	d	D	H	
1111580000VR	8.2	12.0	3.0	1000
8041340000VR	8.2	14.0	1.0	1000
1007060000VR	8.2	15.0	1.5	1000
1001400000VR	8.2	16.0	1.0	1000
1001410000VR	8.2	16.0	1.5	1000
1001420000VR	8.2	16.0	2.0	1000
1001430000VR	8.2	16.0	3.0	1000
0040160000VR	8.2	18.0	1.5	1000
1008780000VR	8.2	25.0	1.0	1000
1008810000VR	8.2	30.0	1.0	1000
1008820000VR	8.2	30.0	2.0	1000
1001450000VR	8.2	30.0	3.0	1000
1008220000VR	8.4	12.0	1.6	1000
1008120000VR	8.4	12.5	1.6	1000
1006720000VR	8.4	13.0	2.5	1000
1006730000VR	8.4	15.0	1.5	1000
0050350000VR	8.4	17.0	1.6	1000
1001470000VR	8.4	20.0	2.0	1000
1007250000VR	8.4	21.0	2.0	1000
1008140000VR	8.4	22.0	2.0	1000
1008140000VR	8.4	22.0	2.0	1000
1020220000VR	8.4	25.0	2.0	1000
1006740000VR	8.4	40.0	3.0	1000
1001480000VR	8.5	25.0	2.5	1000
1008310000VR	9.0	14.4	3.0	1000
1007040000VR	9.0	18.0	2.0	1000
1007200000VR	9.0	20.0	2.0	1000
1007260000VR	9.0	21.0	2.0	1000
1007290000VR	9.0	22.0	2.0	1000
1007330000VR	9.0	24.0	2.0	1000
1005120000VR	9.2	14.5	2.0	1000
1007520000VR	9.2	16.0	1.6	1000
1006750000VR	9.6	18.0	1.2	1000
1006760000VR	10.2	17.0	2.0	1000
1001530000VR	10.2	20.0	1.0	1000
0040180000VR	10.2	22.0	2.0	1000
1008860000VR	10.2	25.0	1.0	1000
1008870000VR	10.2	25.0	2.0	1000
1008880000VR	10.2	25.0	3.0	1000
8041590000VR	10.5	16.0	2.0	1000
1010470000VR	10.5	18.0	1.5	1000
1007160000VR	10.5	18.0	2.0	1000
0050400000VR	10.5	21.0	2.0	1000
1008150000VR	10.5	24.0	2.0	1000
1008160000VR	10.5	24.0	2.5	1000
1008170000VR	10.5	27.0	2.5	1000
1008320000VR	10.5	30.0	3.0	1000
1007350000VR	10.5	34.0	3.0	1000
1007360000VR	10.5	36.0	3.0	1000
1005100000VR	10.5	37.0	3.0	1000
1007370000VR	10.5	40.0	3.0	1000
1006320000VR	10.5	50.0	3.0	1000
1000990000VR	11.0	27.0	2.5	1000
1006770000VR	11.2	18.0	1.2	1000
1007170000VR	12.0	18.0	2.0	1000
1007210000VR	12.0	20.0	2.0	1000
1007030000VR	12.0	21.0	2.0	1000
1007310000VR	12.0	22.0	2.0	1000
1007340000VR	12.0	24.0	2.0	1000
1006780000VR	12.2	24.0	1.3	1000
1000520000VR	12.5	24.0	2.5	1000
0040200000VR	12.5	27.0	2.5	1000
1112000000VR	12.8	18.0	3.0	1000
1007180000VR	13.0	18.0	2.0	1000
1001620000VR	13.0	20.0	1.0	1000
1007270000VR	13.0	21.0	2.0	1000

Part Number	Dimensions (mm)			Std Pack Qty
	d	D	H	
1008340000VR	13.0	22.0	2.0	1000
1008350000VR	13.0	24.0	2.0	1000
1008180000VR	13.0	30.0	2.5	1000
1008390000VR	13.0	30.0	3.0	1000
1007380000VR	13.0	34.0	3.0	1000
1007390000VR	13.0	36.0	3.0	1000
1020570000VR	13.0	40.0	3.0	1000
1007400000VR	13.0	50.0	3.0	1000
1007020000VR	13.3	18.0	1.5	1000
1007120000VR	13.3	22.0	1.5	1000
1007950000VR	14.0	20.0	1.0	1000
1001650000VR	14.5	25.0	3.0	1000
1007960000VR	14.5	28.0	1.0	1000
1001670000VR	14.5	30.0	2.5	1000
1006010000VR	14.5	32.0	3.0	1000
1008230000VR	15.0	26.0	2.0	1000
1008240000VR	15.0	27.0	2.5	1000
1007420000VR	15.0	36.0	3.0	1000
1008410000VR	15.0	37.0	3.0	1000
1008410000VR	15.0	37.0	3.0	1000
1008420000VR	15.0	40.0	3.0	1000
1007430000VR	15.0	50.0	3.0	1000
1009690000VR	16.0	22.0	3.0	1000
1008260000VR	16.0	27.0	2.0	1000
1009350000VR	16.2	25.0	3.0	1000
1009380000VR	16.2	30.0	3.0	1000
0040240000VR	16.5	32.0	3.0	1000
1006390000VR	17.0	23.0	3.0	1000
8041080000VR	17.0	28.0	2.0	1000
1007440000VR	17.0	34.0	3.0	1000
1007450000VR	17.0	36.0	3.0	1000
1008430000VR	17.0	37.0	3.0	1000
1008440000VR	17.0	40.0	3.0	1000
1008270000VR	17.5	27.0	2.0	1000
1001710000VR	18.5	36.0	3.0	1000
1007460000VR	19.0	30.0	3.0	1000
1005110000VR	19.0	37.0	3.0	1000
1007470000VR	19.0	40.0	3.0	1000
1007480000VR	19.0	50.0	3.0	1000
1009540000VR	20.2	30.0	1.0	500
1008450000VR	21.0	30.0	3.0	500
1007490000VR	21.0	36.0	3.0	500
1007500000VR	21.0	50.0	3.0	500
1006840000VR	22.2	34.0	1.5	500
1001770000VR	23.0	40.0	2.5	500
1006860000VR	25.2	40.0	1.7	500
1005230000VR	26.0	35.0	1.0	500
1009720000VR	38.0	41.8	3.0	500



Let us help you
Call 01865 844572



TPR, Anti-Loss and Finishing Washers

SR 1986 Washers

Black TPR

- Conform to dimensional tolerances of: DIN 125, DIN 9021

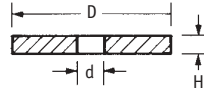

Part Number	Size	Dimensions (mm)			Std Pack Qty
		d	D	H	
0050042001VR	M3	3.2	7.0	0.5	1000
0040062001VR	M3	3.2	8.0	0.8	1000
1020072001VR	M3	3.2	9.0	0.8	1000
0050152001VR	M4	4.3	9.0	0.8	1000
0040122001VR	M4	4.3	10.0	0.8	1000
1020162001VR	M4	4.3	12.0	1.0	1000
0050232001VR	M5	5.3	10.0	1.0	1000
0040222001VR	M5	5.3	12.0	1.0	1000
1020252001VR	M5	5.3	15.0	1.2	1000
0050322001VR	M6	6.4	12.0	1.6	1000
0040292001VR	M6	6.4	14.0	1.2	1000
1020342001VR	M6	6.4	18.0	1.6	1000
0050412001VR	M8	8.4	16.0	1.6	1000
0040392001VR	M8	8.4	18.0	1.5	1000
1020422001VR	M8	8.4	24.0	2.0	1000
0050472001VR	M10	10.5	20.0	2.0	1000
0040452001VR	M10	10.5	22.0	2.0	1000
1020482001VR	M10	10.5	30.0	2.5	1000
0050522001VR	M12	13.0	24.0	2.5	500
0040532001VR	M12	13.0	27.0	2.5	500
1020582001VR	M12	13.0	37.0	3.0	500
0050612001VR	M14	15.0	30.0	3.0	500
0050652001VR	M16	17.0	30.0	3.0	250
1020632001VR	M16	17.0	50.0	3.0	250
0050702001VR	M18	19.0	34.0	3.0	250
0051012001VR	M20	21.0	37.0	3.0	250

SR 1946 Finishing Washers

Black Nylon 6.6

- Good insulation properties
- High-quality finish
- Excellent protection against damage

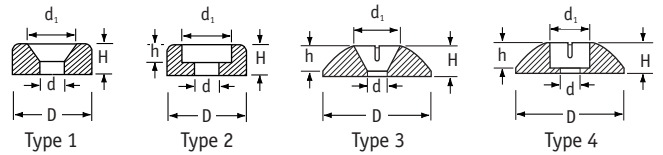

Part Number	Type	Size	Dimensions (mm)					Std Pack Qty
			d	d ₁	D	H	h	
S39183*	1	M2.5	2.7	5.0	6.8	2.0	-	1000
S39184*	1	M3	3.2	6.0	8.5	2.2	-	1000
S39185*	1	M4	4.3	8.0	10.5	2.8	-	1000
S39186*	1	M5	5.3	10.0	12.7	3.4	-	1000
1075050001VR	2	M6	6.4	12.0	15.0	4.0	1.3	1000
31658†	2	M2.5	2.7	5.0	6.8	2.0	1.0	1000
460114	2	M3	3.2	5.5	6.5	2.0	1.1	1000
T31659†	2	M3	3.2	6.0	8.5	2.2	1.2	1000
T31660†	2	M4	4.3	8.0	10.5	2.8	1.7	1000
T31661†	2	M5	5.3	10.0	12.7	3.4	2.2	1000
460115	2	M6	6.4	10.0	12.7	3.4	2.1	1000
T31662†	2	M6	6.4	12.0	15.0	4.0	2.7	1000
31663†	2	M8	8.4	16.0	20.0	5.0	3.5	1000
1070050001VR	3	M5	5.3	18.0	14.0	3.5	-	1000
460111	3	M5	5.3	11.0	18.0	3.8	-	1000
460112	4	M5	5.3	8.5	18.0	4.0	2.7	1000
460113	4	M6	6.4	10.0	22.0	4.9	3.5	1000

* DIN 95, 97, 963, 964, 965, 966, 7963, 7972, 7982, 7983, 7991, 7995, 7997

† DIN 85, 96, 7971, 7981, 7985, 7996

Available in white nylon; please contact our sales office for more information.

SR 1945 Anti-Loss Washers

Natural HDPE

- Hold screws and bolts in place during assembly

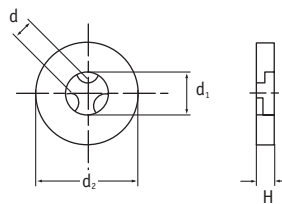

Part Number	Size	Dimensions (mm)				Std Pack Qty
		d	d ₁	d ₂	H	
1040040900VR	M3	2.5	3.2	8.0	0.8	1000
1040160900VR	M3	2.5	3.2	9.0	0.8	1000
1040170900VR	M3	2.5	3.2	10.0	0.8	1000
1040180900VR	M3	2.5	3.2	12.8	0.8	1000
1040190900VR	M3.5	2.9	3.7	7.0	0.5	1000
1040050900VR	M3.5	2.9	3.7	8.0	0.5	1000
1040200900VR	M4	3.3	4.3	8.0	0.8	1000
1040180900VR	M4	3.3	4.3	9.0	0.8	1000
1040070900VR	M4	3.3	4.3	10.0	0.8	1000
1040220900VR	M4	3.3	4.3	12.8	0.8	1000
1040230900VR	M5	4.2	5.3	10.0	1.0	1000
1040080900VR	M5	4.2	5.3	12.0	1.0	1000
1040320900VR	M5	4.2	5.3	20.0	1.0	1000
1040350900VR	M6	4.6	6.2	9.5	1.0	1000
1040340900VR	M6	5.2	6.4	12.0	1.2	1000

Part Number	Size	Dimensions (mm)				Std Pack Qty
		d	d ₁	d ₂	H	
1040060900VR	M6	5.2	6.4	12.0	1.6	1000
1040240900VR	M6	5.2	6.4	12.5	1.6	1000
1040090900VR	M6	5.2	6.4	14.0	1.2	1000
1040250900VR	M6	5.2	6.4	15.0	1.6	1000
1040260900VR	M6	5.2	6.4	16.0	1.6	1000
1040270900VR	M6	5.2	6.4	17.0	1.6	1000
1040360900VR	M8	6.6	8.4	12.0	1.6	1000
1040100900VR	M8	6.6	8.4	18.0	1.5	1000
1040280900VR	M10	8.2	10.5	20.0	2.0	1000
1040110900VR	M10	8.2	10.5	22.0	2.0	1000
1040290900VR	M10	8.2	10.5	24.0	2.0	1000
1040140900VR	M12	10.7	13.0	24.0	2.5	500
1040120900VR	M12	10.7	13.0	27.0	2.5	500
1040300900VR	M12	10.7	13.0	30.0	2.5	500
1040130900VR	M16	13.6	17.0	32.0	3.0	250



Spacers

SR 1941

Spacers

Natural Nylon 6.6

- Cost-effective alternative to metal
- Absorb shock and vibration
- Range covers most diameters

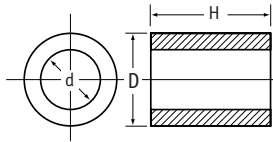

Part Number	Dimensions (mm)			Std Pack Qty
	d	D	H	
111590000VR	2.5	4.0	13.5	1000
111343000VR	2.5	5.0	8.0	1000
111014040VR*	2.6	4.0	5.0	1000
111015040VR*	2.6	4.0	7.5	1000
111016040VR*	2.6	4.0	10.0	1000
111017040VR*	2.6	4.0	15.0	1000
111018040VR*	2.6	4.0	20.0	1000
111019040VR*	2.6	4.0	25.0	1000
111020040VR*	2.6	4.0	30.0	1000
111023040VR*	2.6	5.0	5.0	1000
111084040VR*	2.6	5.0	7.5	1000
111025040VR*	2.6	5.0	10.0	1000
111026040VR*	2.6	5.0	15.0	1000
111027040VR*	2.6	5.0	20.0	1000
111028040VR	2.6	5.0	25.0	1000
111029040VR	2.6	5.0	30.0	1000
111076000VR	3.1	6.0	5.0	1000
111077000VR	3.1	6.0	7.5	1000
111223000VR	3.1	6.0	10.0	1000
111078000VR	3.1	6.0	15.0	1000
111224000VR	3.1	6.0	20.0	1000
111232000VR	3.1	6.0	25.0	1000
111212000VR	3.1	6.0	30.0	1000
111039000VR	3.5	6.0	5.0	1000
111117000VR	3.6	6.0	10.0	1000
111095000VR	3.6	6.0	15.0	1000
111096000VR	3.6	6.0	20.0	1000
111098000VR	3.6	6.0	30.0	1000
111600000VR	4.0	8.0	8.0	1000
111595000VR	4.15	8.0	8.0	1000
111416000VR	4.2	8.0	4.0	1000
111057000VR	4.2	8.0	5.0	1000
111101000VR	4.2	8.0	6.0	1000
111417000VR	4.2	8.0	7.0	1000
111058000VR	4.2	8.0	7.5	1000
111102000VR	4.2	8.0	8.0	1000
111418000VR	4.2	8.0	9.0	1000
111059000VR	4.2	8.0	10.0	1000
111419000VR	4.2	8.0	11.0	1000
111104000VR	4.2	8.0	12.0	1000
111420000VR	4.2	8.0	13.0	1000
111421000VR	4.2	8.0	14.0	1000
111061000VR	4.2	8.0	15.0	1000
111651000VR	4.2	8.0	16.0	1000
111652000VR	4.2	8.0	17.0	1000
111653000VR	4.2	8.0	18.0	1000
111654000VR	4.2	8.0	19.0	1000
111062000VR	4.2	8.0	20.0	1000
111063000VR	4.2	8.0	25.0	1000
111064000VR	4.2	8.0	30.0	1000
111439000VR	5.2	10.0	4.0	1000
111066000VR	5.2	10.0	5.0	1000
111120000VR	5.2	10.0	6.0	1000
111440000VR	5.2	10.0	7.0	1000
111067000VR	5.2	10.0	7.5	1000
111121000VR	5.2	10.0	8.0	1000

Part Number	Dimensions (mm)			Std Pack Qty
	d	D	H	
111441000VR	5.2	10.0	9.0	1000
111068000VR	5.2	10.0	10.0	1000
111442000VR	5.2	10.0	11.0	1000
111123000VR	5.2	10.0	12.0	1000
111443000VR	5.2	10.0	13.0	1000
111444000VR	5.2	10.0	14.0	1000
111069000VR	5.2	10.0	15.0	1000
111445000VR	5.2	10.0	16.0	1000
111446000VR	5.2	10.0	17.0	1000
111448000VR	5.2	10.0	18.0	1000
111449000VR	5.2	10.0	19.0	1000
111070000VR	5.2	10.0	20.0	1000
111071000VR	5.2	10.0	25.0	1000
111072000VR	5.2	10.0	30.0	1000
114054000VR	6.1	8.0	4.2	1000
114055000VR	6.1	8.0	6.0	1000
111450000VR	6.2	10.0	4.0	1000
111135000VR	6.2	10.0	5.0	1000
111451000VR	6.2	10.0	6.0	1000
111452000VR	6.2	10.0	7.0	1000
111136000VR	6.2	10.0	7.5	1000
111453000VR	6.2	10.0	8.0	1000
111454000VR	6.2	10.0	9.0	1000
111075000VR	6.2	10.0	10.0	1000
111455000VR	6.2	10.0	11.0	1000
111456000VR	6.2	10.0	12.0	1000
111457000VR	6.2	10.0	13.0	1000
111458000VR	6.2	10.0	14.0	1000
111138000VR	6.2	10.0	15.0	1000
111459000VR	6.2	10.0	16.0	1000
111460000VR	6.2	10.0	17.0	1000
111461000VR	6.2	10.0	18.0	1000
111462000VR	6.2	10.0	19.0	1000
111082000VR	6.2	10.0	20.0	1000
111140000VR	6.2	10.0	25.0	1000
111141000VR	6.2	10.0	30.0	1000
111589000VR	6.2	12.0	25.0	1000
111144000VR	6.3	15.0	7.5	1000
111145000VR	6.3	15.0	10.0	1000
111146000VR	6.3	15.0	15.0	1000
111091000VR	6.3	15.0	20.0	1000
111148000VR	6.3	15.0	25.0	1000
111160000VR	8.2	12.0	7.5	1000
111089000VR	8.2	12.0	10.0	1000
111162000VR	8.2	12.0	15.0	1000
111163000VR	8.2	12.0	20.0	1000
111164000VR	8.2	12.0	25.0	1000
111165000VR	8.2	12.0	30.0	1000
100144000VR	8.2	16.0	4.0	1000
111086000VR	8.2	16.0	5.0	1000
111092000VR	8.2	16.0	6.0	1000
111503000VR	8.2	16.0	7.0	1000
111153000VR	8.2	16.0	8.0	1000
111504000VR	8.2	16.0	9.0	1000
111154000VR	8.2	16.0	10.0	1000
111505000VR	8.2	16.0	11.0	1000
111155000VR	8.2	16.0	12.0	1000
111506000VR	8.2	16.0	13.0	1000
111507000VR	8.2	16.0	14.0	1000
111156000VR	8.2	16.0	15.0	1000
111508000VR	8.2	16.0	16.0	1000
111509000VR	8.2	16.0	17.0	1000
111510000VR	8.2	16.0	18.0	1000
111511000VR	8.2	16.0	19.0	1000
111157000VR	8.2	16.0	20.0	1000
111788000VR	8.2	16.0	21.0	1000
111789000VR	8.2	16.0	22.0	1000
111790000VR	8.2	16.0	23.0	1000
111791000VR	8.2	16.0	24.0	1000
111792000VR	8.2	16.0	25.0	1000
111793000VR	8.2	16.0	26.0	1000
111794000VR	8.2	16.0	27.0	1000
111795000VR	8.2	16.0	28.0	1000
111796000VR	8.2	16.0	29.0	1000

CONTINUED ON NEXT PAGE



CONTINUED FROM PREVIOUS PAGE

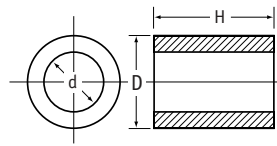

Part Number	Dimensions (mm)			Std Pack Qty
	d	D	H	
1117970000VR	8.2	16.0	30.0	1000
1116100000VR	10.0	12.0	6.0	1000
1140740000VR	10.0	21.0	17.0	1000
1001560000VR	10.2	20.0	4.0	1000
1115940000VR	10.2	20.0	4.5	1000
1111750000VR	10.2	20.0	5.0	1000
1111760000VR	10.2	20.0	6.0	1000
1115200000VR	10.2	20.0	7.0	1000
1115210000VR	10.2	20.0	8.0	1000
1115220000VR	10.2	20.0	9.0	1000
1111780000VR	10.2	20.0	10.0	1000
1115230000VR	10.2	20.0	11.0	1000
1111790000VR	10.2	20.0	12.0	1000
1115240000VR	10.2	20.0	13.0	1000
1115250000VR	10.2	20.0	14.0	1000
1111800000VR	10.2	20.0	15.0	1000
1115260000VR	10.2	20.0	16.0	1000
1115270000VR	10.2	20.0	17.0	1000
1115280000VR	10.2	20.0	18.0	1000
1115290000VR	10.2	20.0	19.0	1000
1111810000VR	10.2	20.0	20.0	1000
1118440000VR	10.2	20.0	21.0	1000
1118450000VR	10.2	20.0	22.0	1000
1118460000VR	10.2	20.0	23.0	1000
1118470000VR	10.2	20.0	24.0	1000
1118480000VR	10.2	20.0	25.0	1000
1118490000VR	10.2	20.0	26.0	1000
1118500000VR	10.2	20.0	27.0	1000
1118510000VR	10.2	20.0	28.0	1000
1118520000VR	10.2	20.0	29.0	1000
1118530000VR	10.2	20.0	30.0	1000
1112430000VR	12.0	23.0	4.0	1000
1115870000VR	12.0	30.0	7.0	1000
1112260000VR	12.6	25.0	25.0	1000
1112280000VR	12.6	25.0	35.0	1000
1112310000VR	12.6	25.0	50.0	1000
1112020000VR	12.8	18.0	7.5	1000
1112030000VR	12.8	18.0	10.0	1000
1112040000VR	12.8	18.0	15.0	1000
1112050000VR	12.8	18.0	20.0	1000
1112060000VR	12.8	18.0	25.0	1000
1112070000VR	12.8	18.0	30.0	1000
1115880000VR	16.0	30.0	7.0	1000
1112420000VR	20.0	32.0	4.0	500
1115970000VR	20.0	39.0	4.0	500
1113450000VR	20.0	44.0	4.0	500
1115960000VR	22.0	25.0	4.0	500
1115990000VR	25.0	32.0	4.0	500

* Manufactured in POM.

SR 1942 Bushes

Natural Nylon 6.6

- Self-lubricating
- Low coefficient of friction
- Ideal for anything that pivots or rotates
- Impervious to moisture, dirt and most chemicals

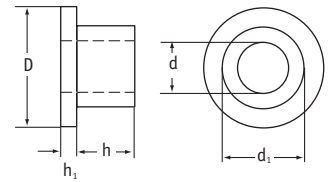

Part Number	Dimensions (mm)					Std Pack Qty
	d	d ₁	D	h ₁	h	
1090090000VR	2.3	3.0	4.7	0.8	0.4	1000
1090620000VR	3.1	3.6	5.8	0.4	1.2	1000
1090700000VR	3.1	4.0	6.2	1.0	7.0	1000
1091090000VR	3.1	4.0	6.2	1.0	6.0	1000
1095830000VR	3.1	4.0	6.2	1.0	10.0	1000
1080030000VR	3.1	6.1	8.1	1.2	0.8	1000
1090580000VR	4.1	6.0	8.2	1.5	3.0	1000
1095010000VR	4.1	6.0	8.2	1.5	5.0	1000
1095200000VR	4.2	4.9	10.0	1.3	1.7	1000
1091330000VR	4.2	6.3	12.7	3.2	11.1	1000
1080170000VR	4.3	6.5	12.0	1.5	1.1	1000
1091280000VR	4.9	9.6	16.3	1.6	1.6	1000
1080200000VR	5.0	9.0	12.0	2.0	2.9	1000
1095290000VR	5.2	6.9	15.0	1.5	2.0	1000
1095300000VR	5.2	7.9	15.0	1.5	2.0	1000
1091810000VR	6.1	8.0	12.2	2.0	4.0	1000
1095360000VR	6.2	7.9	15.0	1.5	2.0	1000
1095370000VR	6.2	8.9	15.0	1.5	2.0	1000
1095400000VR	6.2	11.9	18.0	1.5	2.0	1000
1091960000VR	6.4	9.5	16.0	1.6	4.8	1000
1080350000VR	6.5	9.6	15.8	1.6	2.8	1000
1092140000VR	6.6	8.3	16.0	1.6	3.2	1000
1092270000VR	8.0	11.0	16.0	2.0	11.0	1000
1092280000VR	8.0	12.0	16.0	2.0	4.0	1000
1091100000VR	8.1	10.0	14.2	2.5	4.0	1000
1092320000VR	8.1	10.0	14.2	2.5	8.0	1000
1092330000VR	8.1	10.0	14.2	2.5	10.0	1000
1090380000VR	8.1	14.2	20.0	2.6	9.3	1000
1092470000VR	9.6	12.7	15.9	1.6	7.9	1000
1092530000VR	10.0	12.0	16.0	2.0	4.0	1000
1092540000VR	10.0	14.0	20.0	2.0	8.0	1000
1092550000VR	10.0	16.0	21.0	2.0	8.0	1000
1090440000VR	10.1	14.9	19.8	2.6	9.2	1000
1094670000VR	10.1	16.0	20.0	3.0	7.0	1000
1094140000VR	10.4	13.0	19.0	2.0	5.0	1000
1092600000VR	11.2	16.0	22.2	3.2	9.5	1000
1095760000VR	12.1	14.0	20.0	2.0	4.0	1000
1090510000VR	12.1	17.7	23.9	2.6	13.0	1000
1095480000VR	12.2	13.8	25.0	2.0	2.0	1000
1095840000VR	12.5	14.0	17.5	1.0	8.0	1000
1092750000VR	14.0	18.0	28.0	3.0	18.0	1000
1090630000VR	16.1	21.7	27.7	3.1	16.6	1000
1095750000VR	16.2	17.8	32.0	3.0	6.0	1000
1092880000VR	20.0	24.0	30.0	2.0	13.0	500
1090680000VR	20.1	26.7	31.9	3.1	20.8	500
1095820000VR	24.5	33.0	50.0	6.0	7.5	500
1092940000VR	25.0	30.0	37.0	2.5	27.5	500
1095810000VR	50.0	57.0	98.0	3.0	7.0	100

Please request a free sample to evaluate the suitability of a product for your application.



Rivets, Buttons and Latches

SR 1963

Push Rivets

Natural Nylon 6.6

- Fast, economical, permanent
- Rivet expands for secure tight fit
- Good electrical insulation
- Vibration, abrasion and corrosion resistant
- Installation tool available for faster fixing

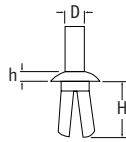
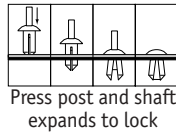

Binder-Head Type

Flat platformed head with a concave underside

Part Number	Nominal Panel Hole Size (mm)	Dimensions (mm)				Installation Tool Number	Std Pack Qty
		Panel Thickness	H	h	D		
460468	6.35	8.89-12.70	15.75	2.03	3.81	461015	1000
460443	3.96	4.75-6.35	7.92	1.27	2.36	461014	1000
460444	3.96	5.54-9.73	10.69	1.27	2.36	461014	1000
460453	4.75	1.98-9.53	11.43	1.57	3.18	461014	1000
460457	4.75	7.92-11.18	13.59	1.91	3.18	461014	1000
460459	4.75	9.53-12.70	15.88	2.03	3.18	461014	1000
460466	6.35	2.36-7.92	12.70	2.03	3.81	461015	1000
460467	6.35	3.96-8.38	9.53	2.03	3.94	461015	1000
460470	6.99	2.36-8.89	12.19	2.77	3.81	461015	1000

Round-Head Type

Domed-head style

Part Number	Nominal Panel Hole Size (mm)	Dimensions (mm)				Installation Tool Number	Std Pack Qty
		Panel Thickness	H	h	D		
460442	3.18	0.79-3.56	5.72	1.52	1.91	461013	1000
460445	4.06	1.57-4.57	5.84	1.27	2.36	461014	1000
460446	4.06	5.54-7.92	8.89	1.27	2.36	461014	1000
460447	4.75	0.79-5.08	7.49	1.91	3.18	461014	1000
460449	4.75	1.57-4.75	7.49	1.91	3.18	461014	1000
460451	4.75	1.57-4.75	7.49	2.03	3.18	461014	1000
460452	4.75	1.98-9.53	11.43	1.19	3.18	461014	1000
460456	4.75	3.96-7.14	9.65	2.03	3.18	461014	1000
460458	4.75	7.92-11.18	13.59	2.77	3.18	461014	1000
460460	4.75	9.53-19.05	21.59	2.77	3.18	-	1000
460461	5.54	0.79-1.57	4.32	5.66	3.18	461014	1000
460462	5.54	2.36-9.53	11.43	2.03	3.05	461014	1000
460465	6.35	1.57-3.18	5.54	2.03	3.18	461014	1000
460469	6.99	1.57-15.24	16.26	2.03	3.81	461015	1000

Truss-Head Type

Provides a larger and flatter flange than round style

Part Number	Nominal Panel Hole Size (mm)	Dimensions (mm)				Installation Tool Number	Std Pack Qty
		Panel Thickness	H	h	D		
460448	4.75	1.57-4.75	7.52	1.27	3.18	461014	1000
460450	4.75	1.57-4.75	7.49	1.91	3.18	461014	1000
460454	4.75	3.96-7.14	9.65	1.91	3.18	461014	1000
460455	4.75	3.96-7.14	9.65	1.91	3.18	461014	1000
460463	5.54	4.75-6.35	8.71	2.03	3.05	461014	1000
460464	5.74	3.18-7.92	11.43	1.91	3.18	461014	1000
460471	7.11	1.57-8.89	11.89	1.91	4.75	-	1000

SR 1964

Mounting Buttons

Natural Nylon 6.6

- Easy to install
- Ideal to fasten thin gauge material, or mount lightweight components
- Suitable for front panel mounting

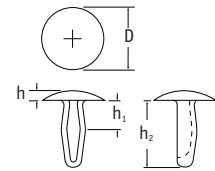

Part Number	Hole Size	Dimensions (mm)				Std Pack Qty
		h ₁	h	D	h ₂	
43525	3.1-3.2	2.0-2.5	1.0	6.9	8.4	1000
43526	3.3-3.6	2.9-4.0	1.7	10.3	11.1	1000
43527	4.6-4.9	2.5-4.0	2.2	12.7	10.9	1000
43528	6.3-6.4	2.4-5.6	2.2	12.7	16.0	1000

SR 1993

new

Snap Latches

Plunger: Nylon 6

Grommet: Polycarbonate

- Allow repeated release and fixing for maintenance work to be carried out
- Snap into panel or hole with easy push action

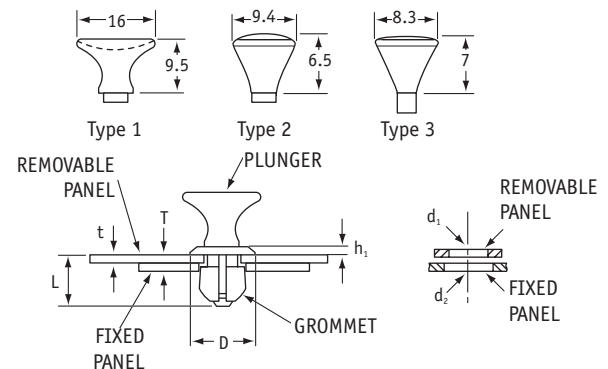

Plunger

Part Number		Type	Panel Thickness T	Hole Size d ₁	Std Pack Qty	Use Grommet Part Number	
Black	White					Black	Natural
462794	462804	1	1.9-4.2	7.6	1000	462800	462810
462795	462805	2	1.9-4.2	7.6	1000	462800	462810
462797	462807	1	3.0-5.2	7.6	1000	462801	462811
462798	462808	3	1.9-4.2	6.0	1000	462802	462812
462799	462809	3	3.0-5.2	6.0	1000	462803	462813

Grommet

Part Number		Panel Thickness t	Hole Size d ₂	Dimensions (mm)			Std Pack Qty
Black	White			D	h ₁	L	
462800	462810	1.5	8.0	10.8	2.0	9.8	1000
462801	462811	2.5	8.0	10.8	2.0	10.9	1000
462802	462812	1.5	6.4	8.5	1.8	6.8	1000
462803	462813	2.5	6.4	8.5	1.8	6.8	1000

All dimensions shown in millimetres.



SR 1811 Snap Rivets

Black or White Nylon

- Press neatly into position

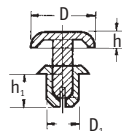

Round Head

Part Number		Dimensions (mm)					Panel Thickness	Std Pack Qty
Black	White	D	h	h ₁	D ₁			
463202	463215	4.2	1.2	2.4	2.0	0.6-1.2	1000	
463203	463216	4.2	1.2	3.2	2.0	1.3-2.0	1000	
463204	463217	4.2	1.2	4.0	2.0	2.1-2.8	1000	
463205	463218	4.2	1.2	4.8	2.0	2.9-3.6	1000	
32507	39143	5.0	1.4	3.2	2.6	1.0-2.0	1000	
32506	39144	5.0	1.4	4.2	2.6	2.1-3.0	1000	
463206	463219	5.0	1.4	4.8	2.6	2.7-3.6	1000	
32507	39145	5.0	1.4	5.5	2.6	3.4-4.3	1000	
32508	39103	6.4	1.6	3.5	3.0	1.0-2.0	1000	
32509	39125	6.4	1.6	4.5	3.0	2.0-3.0	1000	
32510	39126	6.4	1.6	5.5	3.0	3.0-4.0	1000	
32511	34024	6.4	1.6	6.5	3.0	4.0-5.0	1000	
463207	463220	6.4	1.6	7.5	3.0	5.0-6.0	1000	
32512	39147	6.4	1.6	8.0	3.0	5.5-6.5	1000	
463208	463221	6.4	1.6	9.0	3.0	6.5-7.5	1000	
463209	463222	6.4	1.6	10.0	3.0	7.5-8.5	1000	
463210	463223	6.4	1.6	3.5	3.5	1.2-2.1	1000	
32513	39148	6.4	1.6	4.5	3.5	2.2-3.1	1000	
463211	463224	6.4	1.6	5.0	3.5	2.7-3.6	1000	
32514	39150	6.4	1.6	5.5	3.5	3.2-4.1	1000	
463212	463225	6.4	1.6	6.0	3.5	3.7-4.6	1000	
32515	31644	6.4	1.6	7.0	3.5	4.5-5.5	1000	
463213	463226	6.4	1.6	8.0	3.5	5.7-6.6	1000	
32516	39151	8.0	1.8	5.0	4.0	2.5-3.5	1000	
32517	39158	8.0	1.8	6.0	4.0	3.5-4.5	1000	
32518	32704	8.0	1.8	7.0	4.0	4.5-5.5	1000	
32519	39152	8.0	1.8	8.0	4.0	5.5-6.5	1000	
32520	34718	8.0	1.8	10.0	4.0	7.5-8.5	1000	
32521	39153	9.0	2.2	4.5	5.0	1.5-2.5	1000	
32522	39154	9.0	2.2	5.5	5.0	2.5-3.5	1000	
32523	39155	9.0	2.2	6.5	5.0	3.5-4.5	1000	
32524	32707	9.0	2.2	7.5	5.0	4.5-5.5	1000	
32525	39156	9.0	2.2	8.5	5.0	5.5-6.5	1000	
32526	39157	9.0	2.2	9.5	5.0	6.5-7.5	1000	
32527	31741	9.0	2.2	10.5	5.0	7.5-8.5	1000	
32528	36422	12.0	2.5	6.0	6.0	2.5-4.0	1000	
463214	463227	12.0	3.0	8.0	6.0	4.0-5.5	1000	

Add 0.1mm to D₁ dimension for recommended hole size.

Countersunk Head, Black Nylon

- Ideal for flush fit

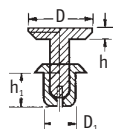

Part Number	Dimensions (mm)					Panel Thickness	Std Pack Qty
	D	h	h ₁	D ₁			
39135	6.4	1.1	3.5	3.0	1.0-2.0	1000	
39136	6.4	1.1	4.5	3.0	2.0-3.0	1000	
39137	6.4	1.1	5.5	3.0	3.0-4.0	1000	
39138	6.4	1.1	6.5	3.0	4.0-5.0	1000	
39139	6.4	1.1	8.0	3.0	5.0-6.5	1000	
39140	6.4	1.1	4.5	3.5	2.0-3.0	1000	
39141	6.4	1.1	5.5	3.5	3.0-4.0	1000	
39142	6.1	1.1	7.0	3.5	4.5-5.0	1000	

SR 1994 Releasable Rivets

new

Plunger: Black Nylon 6

- Easy application and release mechanism
- Ideal for applications requiring regular maintenance

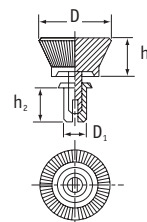

Part Number		Dimensions (mm)					Panel Thickness	Std Pack Qty
Black	White	D	h ₁	D ₁	h ₂			
462620	462633	10.0	8.0	3.5	3.0	1.0-2.0	1000	
462621	462634	10.0	8.0	4.5	2.0	2.0-3.0	1000	
462622	462635	10.0	8.0	5.5	2.0	3.0-4.0	1000	
462623	462636	10.0	8.0	6.5	2.0	4.0-5.0	1000	
462624	462637	10.0	8.0	8.0	2.6	5.5-6.5	1000	
462625	462638	10.0	8.0	4.5	3.0	2.0-3.0	1000	
462626	462639	10.0	8.0	5.5	3.0	3.0-3.7	1000	
462627	462640	10.0	8.0	7.0	3.5	3.8-5.2	1000	
462628	462641	12.0	8.0	5.0	3.5	2.5-3.5	1000	
462629	462642	12.0	8.0	6.0	3.5	3.5-4.5	1000	
462630	462643	12.0	8.0	7.0	3.5	4.5-5.5	1000	
462631	462644	12.0	8.0	8.0	3.5	5.5-6.5	1000	
462632	462645	12.0	8.0	10.0	6.0	7.5-8.5	1000	

SR 1969 Arrow Clips

- Easy push-fit into pre-punched hole
- Good electrical insulation
- Vibration, abrasion and corrosion resistant

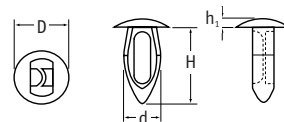

Part Number	Panel Hole Diameter	Panel Thickness	Dimensions (mm)				Std Pack Qty
			D	h ₁	H	d	
460387	2.16-2.29	0.81-2.72	3.18	0.76	4.75	2.72	1000
460388	3.00-3.10	1.57-3.18	7.11	1.52	9.91	3.71	1000
460389	3.02-3.43	1.58-3.18	6.86	1.01	8.38	3.56	1000
460390	3.84-4.09	1.57-3.18	7.11	1.02	9.91	4.98	1000
460391	3.84-4.09	1.57-3.68	7.11	2.03	10.16	4.57	1000
460392	4.06-4.19	0.81-3.18	7.11	2.03	10.16	4.72	1000
460393	4.62-4.88	1.57-3.18	9.14	1.52	10.16	5.72	1000
460394	4.62-4.88	4.19-4.70	9.53	1.52	13.33	5.23	1000
460395	4.62-4.88	7.87-8.38	9.4	1.52	13.72	5.72	1000
460396	5.41-5.66	1.57-3.18	9.4	1.52	11.43	5.72	1000
460397	5.41-5.66	3.18-4.75	9.4	1.52	13.72	6.30	1000
460398	6.35-6.57	3.18-6.35	12.7	1.27	16.0	7.12	1000
460399	6.35-6.60	9.14-9.65	15.62	1.65	20.57	7.26	1000
460400	8.38-8.64	3.18-8.88	17.45	0.75	22.74	9.4	1000
460401	8.51-8.76	1.57-3.56	22.0	1.27	11.43	9.22	1000



Fasteners and Clips

SR 1968 Push-In Fasteners Natural Nylon 6.6

- Lock into pre-punched panels
- Vibration, abrasion and corrosion resistant

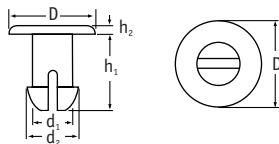
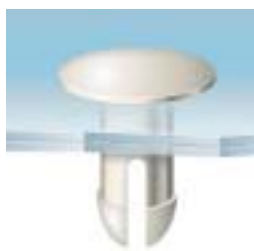

extended range

Part Number	Hole Diameter (mm)	Max Panel Thickness	Dimensions (mm)					Std Pack Qty
			d ₁	d ₂	D	h ₂	h ₁	
2010360000VR	2.3 - 2.4	1.7	2.3	2.7	4.7	1.0	3.6	1000
2010060000VR	2.3 - 3.0	3.1	2.3	3.7	8.0	1.0	5.2	1000
2010590000VR	2.3 - 2.4	3.7	2.3	2.7	4.8	1.1	5.4	1000
2010070000VR	2.4 - 2.5	1.6	2.4	2.7	7.1	1.0	3.5	1000
2010080000VR	2.4 - 2.5	2.4	2.4	2.7	7.0	1.0	4.2	1000
2010090000VR	2.4 - 3.0	2.9	2.4	3.7	6.4	1.0	5.1	1000
2010560000VR	2.4 - 2.8	8.0	2.4	3.4	3.6	1.5	10.0	1000
2010100000VR	3.0 - 3.2	3.1	3.0	3.7	5.2	1.0	6.2	1000
2010110000VR	3.0 - 3.1	3.5	3.0	3.6	5.2	1.0	6.8	1000
2010120000VR	3.0 - 3.1	4.0	3.0	3.6	5.2	0.3	7.4	1000
2010130000VR	3.0 - 3.1	6.0	3.2	3.5	5.2	1.0	7.8	1000
2010460000VR	3.0 - 3.2	6.4	3.0	3.7	5.2	0.3	9.7	1000
2010770000VR	3.0 - 3.2	8.1	3.0	3.7	6.0	0.8	10.2	1000
2010750000VR	3.0 - 3.2	14.0	3.0	3.7	6.4	1.5	17.5	1000
2010150000VR	3.3 - 3.8	4.8	3.3	4.6	5.2	1.0	7.1	1000
2010950000VR	3.7 - 4.5	3.3	3.7	5.2	15.0	1.3	6.5	1000
2010160000VR	3.8 - 4.6	8.0	3.8	5.3	9.9	1.5	10.9	1000
2010490000VR	4.1 - 4.4	11.4	4.1	5.1	8.7	1.8	15.5	1000
2010170000VR	4.2 - 4.4	1.7	4.2	5.1	8.7	3.0	5.3	1000
2010180000VR	4.2 - 4.4	3.4	4.2	5.1	8.7	1.0	6.8	1000
2010990000VR	4.4 - 4.7	4.6	4.5	5.6	10.0	1.4	8.6	1000
2010190000VR	4.4 - 4.8	6.3	4.4	5.7	8.7	1.7	10.8	1000
2010200000VR	4.6 - 4.8	14.1	4.6	5.7	8.7	1.8	18.0	1000
2010370000VR	4.6 - 4.8	16.2	4.6	5.6	9.5	1.5	20.0	1000
2010760000VR	5.0 - 5.3	3.3	5.0	6.0	12.0	3.0	7.1	1000
2010210000VR	5.1 - 5.2	3.1	5.1	6.0	12.0	1.3	6.9	1000
2010220000VR	5.1 - 5.2	4.0	5.1	5.8	12.0	1.3	7.7	1000
2010230000VR	5.2 - 5.3	9.5	5.2	6.0	8.7	1.0	13.0	1000
2010040000VR	5.5 - 5.9	3.5	5.5	7.0	14.0	3.0	7.0	1000
2010240000VR	5.8 - 6.5	44.0	5.8	7.5	10.0	1.8	49.2	1000
2010850000VR	6.1 - 6.4	3.2	6.1	7.1	12.7	1.4	7.8	1000
2010860000VR	6.1 - 6.4	4.0	6.1	7.1	12.7	1.4	8.5	1000
2010870000VR	6.1 - 6.4	4.8	6.1	7.1	12.7	1.5	9.3	1000
2010880000VR	6.1 - 6.3	5.6	6.1	7.0	12.7	1.5	10.5	1000
2010890000VR	6.1 - 6.4	6.3	6.1	7.2	12.7	1.6	10.8	1000
2010250000VR	6.1 - 6.5	7.0	6.1	7.5	11.5	1.0	11.8	1000
2010260000VR	6.1 - 6.5	7.6	6.1	7.5	11.5	1.5	12.4	1000
2010910000VR	6.1 - 6.4	8.0	6.1	7.1	12.7	1.5	12.4	1000
2010280000VR	6.1 - 6.5	8.4	6.1	7.5	11.5	1.6	13.1	1000
2010920000VR	6.1 - 6.4	8.8	6.1	7.1	12.7	1.5	13.2	1000
2010930000VR	6.1 - 6.4	9.5	6.1	7.1	12.7	0.7	14.8	1000
2010980000VR	6.1 - 6.4	11.1	6.1	7.1	12.7	1.5	15.6	1000
2010960000VR	6.1 - 6.4	11.8	6.1	7.1	12.7	1.4	16.4	1000
2010970000VR	6.1 - 6.4	12.7	6.1	7.1	12.7	1.5	17.1	1000
2010830000VR	6.2 - 6.4	1.6	6.2	7.1	12.7	1.5	5.9	1000
2010840000VR	6.2 - 6.4	2.5	6.2	7.1	12.7	1.5	6.9	1000
2010270000VR	6.2 - 6.6	6.3	6.2	7.6	15.0	1.5	11.1	1000
2010290000VR	6.2 - 6.6	9.5	6.2	7.6	15.0	1.5	14.3	1000
2010940000VR	6.2 - 6.4	10.3	6.2	7.2	12.7	1.5	14.7	1000
2010300000VR	6.2 - 6.6	12.2	6.2	7.6	15.0	1.4	16.9	1000
2010540000VR	6.5 - 6.7	5.0	6.5	7.5	8.7	0.8	9.7	1000
2010320000VR	6.6 - 6.8	4.3	6.6	7.6	12.7	1.5	9.1	1000
2010340000VR	7.0 - 7.2	10.3	7.0	8.0	15.0	1.4	14.4	1000
2010570000VR	7.7 - 8.7	3.0	7.7	9.6	11.1	1.9	9.5	1000

SR 1970 Keyhole Clips Natural Nylon 6.6

- Easy finger-pressure assembly
- Good electrical insulation
- Vibration, abrasion and corrosion resistant

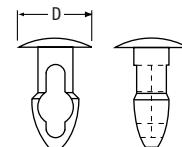

Part Number	Dimensions (mm)			Std Pack Qty
	Hole Diameter	Max Panel Thickness	D	
460402	3.18	2.36	6.35	1000
460403	3.18	3.18	6.35	1000
460404	3.18	3.96	6.35	1000
460405	3.18	4.78	6.35	1000
460406	3.18	5.56	6.35	1000
460407	3.18	6.35	6.35	1000
460408	3.96	2.36	7.94	1000
460409	3.96	3.18	7.94	1000
460410	3.96	3.96	7.94	1000
460411	3.96	4.75	7.94	1000
460412	3.96	5.54	7.94	1000
460413	3.96	6.35	7.94	1000
460414	3.96	7.14	7.94	1000
460415	3.96	7.92	7.94	1000
460416	3.96	8.71	7.94	1000
460417	3.96	9.53	7.94	1000
460418	5.56	2.36	8.73	1000
460419	5.56	3.18	8.73	1000
460420	5.56	3.96	8.73	1000
460421	5.56	4.78	8.73	1000
460422	5.56	5.56	8.73	1000
460423	5.56	6.35	8.73	1000
460424	5.56	7.14	8.73	1000
460425	5.56	7.92	8.73	1000
460426	6.35	2.36	12.70	1000
460427	6.35	3.18	12.70	1000
460428	6.35	3.96	12.70	1000
460429	6.35	4.75	12.70	1000
460430	6.35	5.56	12.70	1000
460431	6.35	6.35	12.70	1000
460432	6.35	7.14	12.70	1000
460433	6.35	7.92	12.70	1000
460434	6.35	8.71	12.70	1000
460435	6.35	9.53	12.70	1000

SR 1965 Barbed Push Fasteners Black Nylon 6.6

- Ideal for threaded, drilled or punched holes

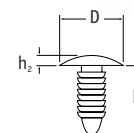

Part Number	Dimensions (mm)					Std Pack Qty
	Hole Diameter	Panel Thickness	D	h ₁	h ₂	
460436	4.75	0.64-9.27	9.53	12.70	1.78	1000
460437	4.75	0.76-8.38	11.05	14.27	1.73	1000
460439	6.35	2.67-7.62	17.78	11.10	2.54	1000
460440	6.35	3.81-13.51	17.78	18.88	2.71	1000
460441	7.13	2.36-12.70	15.87	22.61	2.79	1000



SR 1990

new

Snap Fasteners

Natural Polyethylene

Female Washer

Male Clip

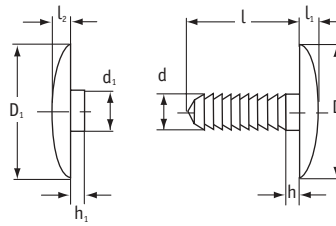

30mm Head Diameter

Part Number		Hole Diameter	Male Clip Dimensions (mm)					Female Washer Dimensions (mm)				Std Pack Qty	
Black	White		Panel Thickness	d	l	h	D	l ₁	h ₁	d ₁	D ₁		l ₂
8502160901VR	8502160908VR	8 - 20	6 - 10	6	12	-	30	3	6	8	30	3	1000
8502260901VR	8502260908VR	8 - 20	6 - 22	6	26	4	30	3	6	8	30	3	1000
8502440901VR	8502440908VR	8 - 20	20 - 40	6	44	14	30	3	6	8	30	3	1000
8501160901VR	8501160908VR	8 - 20	12 - 18	6	12	-	30	3	12	8	30	3	1000
8501260901VR	8501260908VR	8 - 20	12 - 30	6	26	4	30	3	12	8	30	3	1000
8501440901VR	8501440908VR	8 - 20	12 - 46	6	44	14	30	3	12	8	30	3	1000

15mm Head Diameter

Part Number		Hole Diameter	Male Clip Dimensions (mm)				Female Washer Dimensions (mm)		Std Pack Qty
Black	White		Panel Thickness	l	D	l ₁	D ₁	l ₂	
8501150901VR	8501150908VR	5 - 10	0 - 8	15	15	2	15	3.5	1000
8501220901VR	8501220908VR	5 - 10	0 - 16	22	15	2	15	3.5	1000

NB: One pack contains 1000 each of clips and washers.

SR 1991

new

Push Clips

White Nylon 6.6

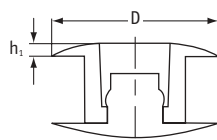

Part Number		Dimensions (mm)				Std Pack Qty
White	Black	Hole Diameter	Max Panel Thickness	D	h ₁	
8201020008VR	8201020001VR	6.0	2.2	10.0	0.8	1000
8201030008VR	8201030001VR	6.0	3.2	10.0	0.8	1000
8201040008VR	8201040001VR	6.0	4.2	10.0	0.8	1000
8201050008VR	8201050001VR	6.0	5.2	10.0	0.8	1000

NB: Pack quantity includes 1000 each of male and female parts.

Our Clips, Suction Pads, Hooks and Snap Fasteners are ideal for point-of-sale applications.

Turn to pages 78-80 to see our full range of products.





Assembly Clips

SR 1990

Assembly Clips

Nylon 6.6

new

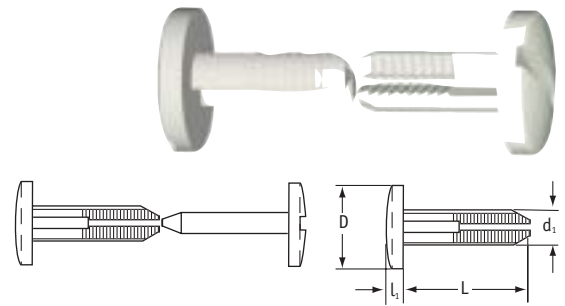

12mm Head with slot

Part Number		Hole Diameter	Panel Thickness	Dimensions (mm)				Std Pack Qty
Black	White			d ₁	D	l ₁	L	
8100670001VR	8100670008VR	5 - 8	5.3 - 7.5	5.0	12.0	3.0	5.5	1000
8100680001VR	8100680008VR	5 - 8	9.0 - 13.0	5.0	12.0	3.0	9.0	1000
8100690001VR	8100690008VR	5 - 8	13.0 - 20.0	5.0	12.0	3.0	13.0	1000
8100660001VR	8100660008VR	5 - 8	18.0 - 28.0	5.0	12.0	3.0	18.0	1000
8100700001VR	8100700008VR	5 - 8	20.0 - 34.0	5.0	12.0	3.0	20.0	1000
8100710001VR	8100710008VR	7 - 8	13.0 - 20.0	7.0	12.0	3.0	13.0	1000

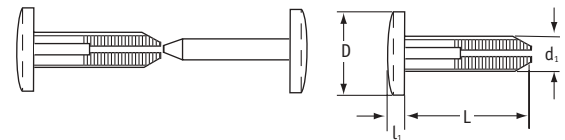

12mm Head without slot

Part Number		Hole Diameter	Panel Thickness	Dimensions (mm)				Std Pack Qty
Black	White			d ₁	D	l ₁	L	
8110670001VR	8110670008VR	5 - 8	5.3 - 7.5	5.0	12.0	4.0	5.5	1000
8110680001VR	8110680008VR	5 - 8	9.0 - 13.0	5.0	12.0	4.0	9.0	1000
8110690001VR	8110690008VR	5 - 8	13.0 - 20.0	5.0	12.0	4.0	13.0	1000
8110660001VR	8110660008VR	5 - 8	18.0 - 28.0	5.0	12.0	4.0	18.0	1000
8110700001VR	8110700008VR	5 - 8	20.0 - 34.0	5.0	12.0	4.0	20.0	1000
8110710001VR	8110710008VR	7 - 8	13.0 - 20.0	7.0	12.0	4.0	13.0	1000

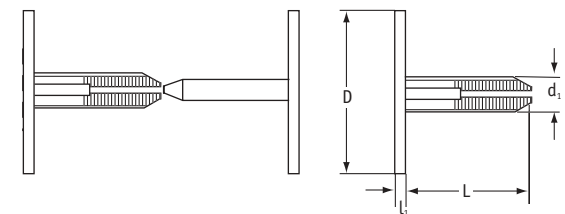

19mm Flat Head without slot

Part Number		Hole Diameter	Panel Thickness	Dimensions (mm)				Std Pack Qty
Black	White			d ₁	D	l ₁	L	
8130670001VR	8130670008VR	5 - 8	5.3 - 7.5	5.0	19.0	3.0	5.5	1000
8130680001VR	8130680008VR	5 - 8	9.0 - 13.0	5.0	19.0	3.0	9.0	1000
8130690001VR	8130690008VR	5 - 8	13.0 - 20.0	5.0	19.0	3.0	13.0	1000
8130660001VR	8130660008VR	5 - 8	18.0 - 28.0	5.0	19.0	3.0	18.0	1000
8130700001VR	8130700008VR	5 - 8	20.0 - 34.0	5.0	19.0	3.0	20.0	1000
8130710001VR	8130710008VR	7 - 8	13.0 - 20.0	7.0	19.0	3.0	13.0	1000

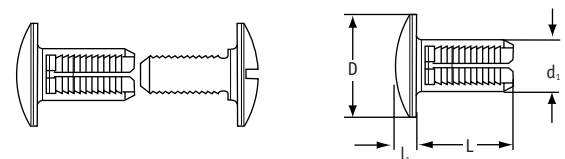

20mm Rounded Head with slot

Part Number		Hole Diameter	Panel Thickness	Dimensions (mm)				Std Pack Qty
Black	White			d ₁	D	l ₁	L	
8170820101VR	8170820108VR	10 - 15	8.7 - 11.5	9.7	20.0	3.5	8.5	1000
8170840101VR	8170840108VR	10 - 15	18.0 - 25.0	9.7	20.0	3.5	16.0	1000