



Non Standardised Screws/Bolts

Metric Screws and Bolts



hexagon head bolts with flange
acc. to MBN 10105
(article 10105)



threaded bolts and nuts acc. to ANSI Standard
(→ DIN 976)

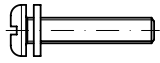

screws and washer assemblies
(→ DIN 6900, 6901/ISO 10644)

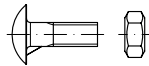

screws with hexagon nuts for crash barriers



HVA friction grip bolts for HV systems

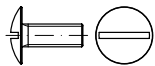

slotted mushroom head screws
(article 88107)

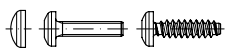

screws for number plates → cap screws



additional types/versions
→ DIN 962/(ISO 7378, 8991)

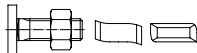
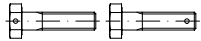

hook bolts/halfen screws
T-head bolts
T-bolts for solar engineering without square
(article 88928-88972)

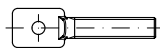
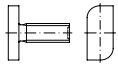

eye screws, thumb screws



screw eyes, cup hooks, screw hooks
(article 88136-88145)

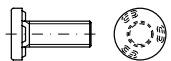
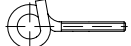
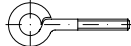

welding screws, NELSON head bolts
(→ DIN 32500, 32501, 34817)

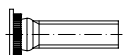
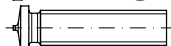

rivet screws

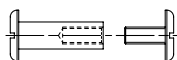

binder posts (book screws)

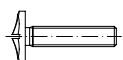

screws with old fashioned head

steel plain	steel coated	stainless steel	brass Cu / Al / Ti plastic
10.9	flZn		
5.6 8.8 ASTM AISI BS	ZP HDG PTFE AISI BS	A2 A4 ASTM	
4.6	HDG		
10.9	HDG		
4.6 5.6	ZP NP	A1 A2	Br
St	ZP NP	A2	Br
4.6 8.8	ZP HDG	A2 A4	
St	ZP		
St	ZP	A2 A4	Br
St			
St	ZP		
5.8	NP		Br
4.6	ZP browned	A2	

* with approval



Driving features:
H = cross recess Phillips
Z = cross recess pozidriv
ISR/TORX = hexalobular socket

steel plain

steel coated

stainless steel

brass
Cu / Al / Ti
plastic



Non Standardised Screws/Bolts

Fasteners with Theft Resistant Drives

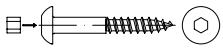

wood screws thread with hexagon socket and rivet pin (article 88110)

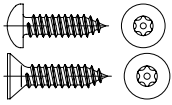

pan head/countersunk head screws with hexalobular socket and pin („PIN-TORX“), tapping screw thread (article 88114, 88115)



pan head/countersunk head screws with snake eyes drive, metric thread (article 88111, 88112)



button head screws with hexagon socket and pin, metric thread (article 88113)

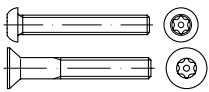

button head/countersunk head screws with hexalobular socket and pin („Pin-TORX“), metric thread (article 88116, 88117)

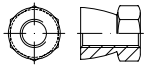

theft resistant nuts/pull-off nuts for one-way assembly (article 88118)

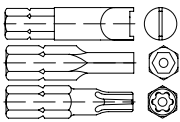

special bits for theft resistant drives (article 88665-88667)

Wood Screws and Chipboard Screws

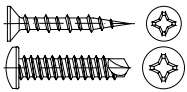

drilling window screws with spiral tip, window frame anchorage (article 88010-88018)

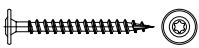

chipboard screws with washer head with hexalobular drive (~TORX) (article 88025)

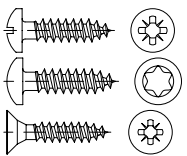

chipboard screws with Pozidriv cross recess Z/hexalobular socket (~TORX)
- pan head
- countersunk head (article 88095-88097)



chipboard screws with partial thread countersunk head, hexalobular socket (~TORX) (article 88098)

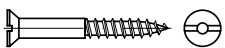

wood screws with center hole (→ DIN 97)



fixings and fasteners for window frames (article 88187-88190)

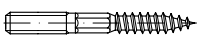

hanger bolts with internal and external drive (article 88149)

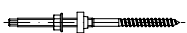

hanger bolts, ready for use for solar engineering (please request special brochure)

steel plain	steel coated	stainless steel	brass Cu / Al / Ti plastic
St	ZP HDG browned	A2	
		A2	
		A2	
		A2	
		A1	
St hard.			
St	ZP		
St hard. lubrica- ted	ZP	A2	
St hard. lubrica- ted	ZP brassed	A2	Br
St hard. lubrica- ted	ZP		
St	ZP	A2 A4	Br
St case- hard.	ZP		
St	ZP	A2 A4	
		A2	

* with approval



Driving features:
H = cross recess Phillips
Z = cross recess pozidriv
ISR/TORX = hexalobular socket

steel plain

steel coated

stainless steel

brass
Cu / Al / Ti
plastic



Non Standardised Screws/Bolts



spacer screws for framework/bars, sleeves, caps

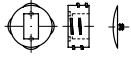

wood screws thread with hexagon socket and rivet pin (article 88110)



SPAX screws

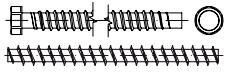

SPAX - threaded rods with wood screw thread for lateral pass and lateral pressure reinforcement for large timber components acc. to DIN 1052 (article 88052, 89016)



SPAX screws with countersunk head, partly threaded, also screws for wood constructions up to 12 x 600, with hexalobular drive (~ TORX) (article 88091)

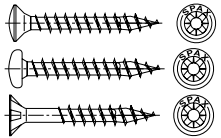

SPAX chipboard screws with Pozidriv cross recess type Z/hexalobular socket (~TORX)
- raised countersunk head
- round head
- countersunk head (article 88092-88094)

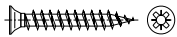

SPAX screws with small countersunk head, with cross recess type Z (article 88094)

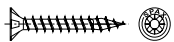

SPAX screws with countersunk head, with Pozidriv cross recess Z and center hole (article 88099)

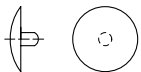

caps with pin for SPAX screws with inner hole (article 88001)

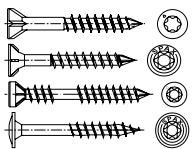

SPAX special screws
type D = for terraces planks
type T = with flange head
type M = for MDF boards
type SF = for solid timber floors
type FB = head 90° with milling ribs
type R = with back panel head (article 88192-88198)



SPAX screws for rear panel (article 88197)

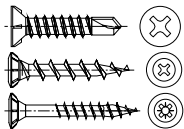

SPAX window air screws FEX
type A = for fastening metal reinforcements for simple-wall profiles
type KS = fitting screws for plastic profiles
type H = screws for wooden window frames (article 88187-88189)



SPAX frame anchors RA with star socket (~TORX)
CSK = with countersunk head
C = with cheese head (article 89010-89011)

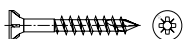

SPAX glass strip screws with Pozidriv cross recess type Z (article 88190)

steel plain	steel coated	stainless steel	brass Cu / Al / Ti plastic
St	ZP		
St	ZP HDG browned		
St	ZP		
St hard. lubrica- ted	ZP	A2	
St hard. lubrica- ted	ZP	A2	
St hard. lubrica- ted	ZP		
St hard. lubrica- ted	ZP		plastic
St hard. lubrica- ted	ZP	A2	
St case- hard.	ZP		
St hard. lubrica- ted	ZP		
St hard. lubrica- ted	ZP		
St hard. lubrica- ted	ZP	A2	

* with approval



Driving features:
H = cross recess Phillips
Z = cross recess pozidriv
ISR/TORX = hexalobular socket

steel plain

steel coated

stainless steel

brass
Cu / Al / Ti
plastic



Non Standardised Screws/Bolts



SPAX post screws with CUT cone end, star socket (~TORX) (article 88191)



SPAX screws assortment (article 88478-88479)

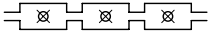

SPAX screws belted

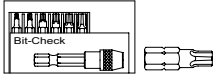

SPAX-BITcheck assortment
SPAX CUT-CASE
(article 88654, 88663)

Tapping Screws, Drilling Screws, Screws for Plastics



cylindrical head tapping screws with hexagon socket (article 88312)

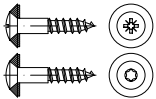

Spengler screws raised countersunk head, wood screws with cross recess/hexalobular socket including rosettes and sealing washer (article 88925-88926)

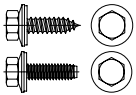

tapping screws for facing
type A = with cone end
type BZ = with full dog point
(article 88176, 88276)



caps for tapping screws for facing (article 88008)



tapping screws for roofs with washers

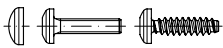

cap bolts, screws for number plates, metric thread, tapping screw thread with caps (article 88981, 88003)

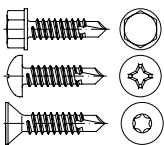

self drilling tapping screws with cone end (e.g. TEKS-, SUPER-TEKS-, Wing-TEKS-, DRIL-KWIK-screws) (→ DIN 7504/ISO 15480-15483)

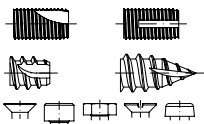

self tapping screws with scrape point, with metric thread/tapping screw thread

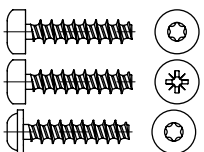

pan head screws with screw thread for plastic (thermoplastics),
- with hexalobular socket (~ TORX)
- with cross recess
(article 88200-88204)

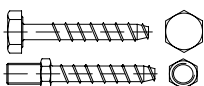

MULTI-MONTI HMS/MMS screw-in-anchors, wall screws (article 88902-88908)

steel plain	steel coated	stainless steel	brass Cu / Al / Ti plastic
		A2	
St hard. lubricated	ZP		
St hard.			
St	ZP NP	A2 A4	
	coppered	A2	
St case-hard.	ZP	A2	
			plastic
St	ZP		
St	ZP NP	A2	Br
St case-hard.	ZP NP		
St case-hard.	ZP NP	A2 A4	
St hard.	ZP		

* with approval



Driving features:
H = cross recess Phillips
Z = cross recess pozidriv
ISR/TORX = hexalobular socket

steel plain

steel coated

stainless steel

brass
Cu / Al / Ti
plastic



Non Standardised Nuts and Inserts

Nuts

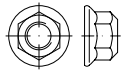

prevailing torque type hexagon nuts with flange, acc. to MBN 13023 (article 13023)

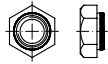

rivet nuts, KALEI/ANCHOR (article 88106)

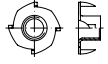

tee nuts with prong (article 88108)

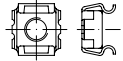

square caged nuts (article 88109)



wing nuts, small „American“ type (article 88215)

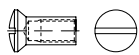

sleeve nuts with slot/no slot (article 88964)

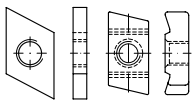

T-nuts (sliding nuts, threaded plates) (article 88951-88955)

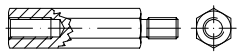

spacer (fastener) with thread and with hexagon (article 88086)



hexagon couplings (article 88087)

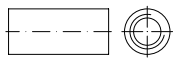

round couplings (article 88088)



round and hexagon nuts with trapezoidal thread (article 88089, 88090)

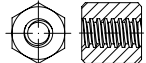

nuts with captive washers

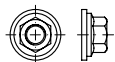

spot-weld nuts

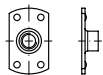

speed nuts, spring nuts for tapping screw threads (→ DIN 34818)

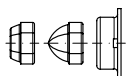

PAL cap nuts for metric thread

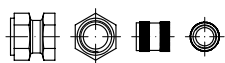

insert nuts (→ DIN 16903)
– to force fit/engage
– to push in/break in

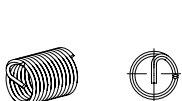

Inserts

AMECOIL wire thread inserts, coarse thread, fine pitch thread, self locking, setting tools (article 88330-88360)

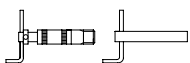

thread cutter, setting tools for AMECOIL-/KATO thread inserts (article 88333, 88360)



AMECOIL assortment box with threaded inserts (article 88342, 88344)

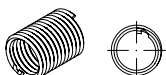

KATO wire thread inserts

steel plain	steel coated	stainless steel	brass Cu / Al / Ti plastic
10	flZn		
St hard.	ZP	A1-A4	
St	ZP		
St	ZP		
St	ZP	A2	Br
St	ZP NP	A1-A4	Br Al
St 5 8	ZP HDG	A2 A4	
St	ZP NP Cr	A1-A5	Al Br plastic
St	ZP HDG flZn	A1-A5	Br
St	ZP HDG flZn	A1-A5	Br Cu-alloy
6 8 10	ZP NP Cr	A2 A4	
St			
SSt	ZP		
SSt	ZP		
St	ZP		Br Al
		A2 NIMONIC	bronze
St hard.			
		A2	
		A2	

* with approval



Driving features:
H = cross recess Phillips
Z = cross recess pozidriv
ISR/TORX = hexalobular socket

steel plain

steel coated

stainless steel

brass
Cu / Al / Ti
plastic



Non Standardised Inserts and Washers

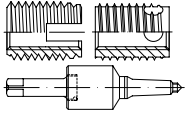

ENSAT threaded inserts, short, long,
setting tools for ENSAT threaded inserts
(article 88301-88308)

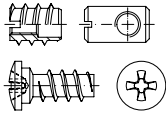

RAMPA inserts/sleeves (→ DIN 7965)
RAMPA transverse threaded bolts
RAMPA screws

Washers



washers „article 1“
(article 88100)



plain washers/“Cupal“ washers
(article 88101)

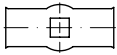

joint washers for cup head square neck bolts
acc. to DIN 603
(article 88102)



washers with large outside diameter
(article 88104)



SCHNORR safety washers
with serrations on both sides S, VS
(article 88120, 88121)



TECKENTRUP lock washers,
for hexagon head screws and
hexagon socket head cap screws
(article 88123-88126)



TECKENTRUP lock washers
with contact serrations
(article 88129)



lock rings
(article 88130, 88131)



NORD-LOCK washers, preassembled pairs
standard = normal outer diameter
SP = enlarged outer diameter
(article 88132)

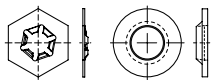

RUV-Reyher captivity washers
(article 88151, 88152, 88154)



machine washers with sink hole
for fixing control units
(article 88184)



sealing washers
(convex metal washers with vulcanised sealing)
(article 88277)

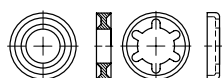

DUBO profile washers, DUBO lock washers
(article 88494-88496)

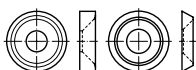

rosettes/finishing washers, KORREX rosettes
(article 88499, 88965)

steel plain	steel coated	stainless steel	brass Cu / Al / Ti plastic
St hard.	ZP	A1	
St	ZP		brass
St	ZP HDG		CuAl
St	ZP		
St	ZP	A2	
St hard.	ZP mechZP flZn	A2 A4	
SSt	mechZP flZn	1.4568	
SSt	mechZP flZn	1.4568	
SSt	ZP flZn	1.4310 A4	
St hard.	flZn	A4	
St		A2	plastic
St			
St	ZP neoprene CuAl	A2 neoprene	Al neoprene
St	ZP		plastic
St	NP Cr	A2 A4	Br Al

* with approval



Driving features:
H = cross recess Phillips
Z = cross recess pozidriv
ISR/TORX = hexalobular socket

steel plain

steel coated

stainless steel

brass
Cu / Al / Ti
plastic



Non Standardised Washers and Locking Elements

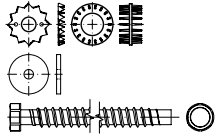

timber fasteners (→ DIN 1052)
mandrels one-sided or both sided,
timber fastener washers
SPAX-threaded rods for timber fasteners (article 88052)

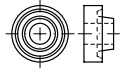

sealings type EPDM for solar engineering
(article 88917)

Locking Elements for Fastenings

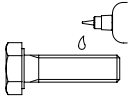

chemical adhesives/Loctite threadlockers
(article 85000)

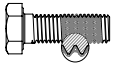

adhesive/clamping coatings for screws

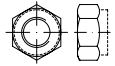

all metal self locking nuts
(→ DIN 980, 6925/ISO 7042, 10513)
(e.g. STOVER/CLEVELOC/UNI-STOP/BILOC)

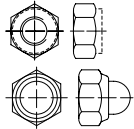

nuts with non-metal inserts (plastic rings)
(→ DIN 982, 985, 986, 6924/ISO 7040, 10511, 10512)
(z.B.: NYLOC/POLY-STOP/ELASTIC-STOP)

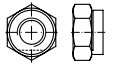

prevailing torque type hexagon nuts,
M = nuts with metal inserts
(e.g.: SPRING-STOP/VARGAL/DAX/THERMAG)
(article 88105)

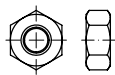

hexagon nuts AMELOCK®
with self locking thread insert

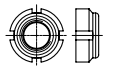

locknuts with non-metallic insert GUK
(article 88081)

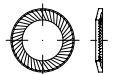

SCHNORR safety washers
(article 88120, 88121)

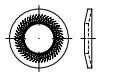

TECKENTRUP lock washers,
for hexagon head screws and
hexagon socket head cap screws
(article 88123-88126)

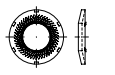

CONTACT washers
(Artikel 88129)

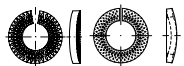

lock rings
(article 88130, 88131)

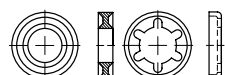

DUBO profile washers, DUBO lock washers
(article 88494-88496)

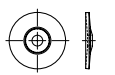

TECKENTRUP disc springs

steel plain	steel coated	stainless steel	brass Cu / Al / Ti plastic
MCI St	black varnish ZP HDG	A2 A4	plastic
8 10	ZP HDG		glue
8 10	ZP flZn		glue plastic
5 6 8 10 12	ZP flZn NP brassed	A1-A4	Br Al
8	ZP	A2 A4	
St	ZP		
SSt	ZP mechZP flZn	A2 A4	
SSt	mechZP flZn	1.4568	
SSt	ZP	A4	bronze
SSt	ZP flZn	1.4310 A4	
St	ZP		plastic
SSt	mechZP flZn	1.4568	

* with approval



Driving features:
H = cross recess Phillips
Z = cross recess pozidriv
ISR/TORX = hexalobular socket

steel plain

steel coated

stainless steel

brass
Cu / Al / Ti
plastic



Non Standardised Locking Elements and other Fastenings



NORD-LOCK washers, preassembled pairs
standard = normal outer diameter
SP = enlarged outer diameter
(article 88132)

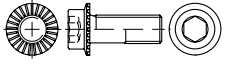

hexagon socket head cap screws
with flange and lock ribs
(article 88912)

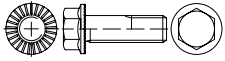

hexagon head screws with flange and lock ribs
(article 88913)

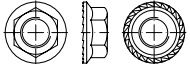

hexagon locking nuts (→ DIN 6923),
surface hardened (article 88934, 88914)

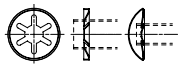

quick fastening elements for axles, bolts and shafts;
axle clamping rings, Duo-Clips, spring cotter pins,
KL-/SL locking devices, U-Clips, shaft locking clips
(article 88122)



RUV-Reyher captivity nuts
for usage acc. to EC machinery directive
(article 88151, 88153)

Caps, Hooks, Handles, Cable ties, Pins



caps for tapping screws for facing
(article 88008)

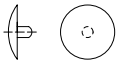

caps with pin for chipboard screws
for SPAX screws with inner hole
(article 88001)

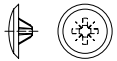

caps for countersunk head screws
with Prozidriv cross recess Z
(article 88002)

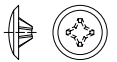

caps for countersunk head screws
with Prozidriv cross recess Z
(article 88004)

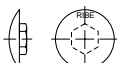

Ribe caps for hexagon socket head screws,
caps for countersunk head screws
with hexalobular/star socket (~TORX)
(article 88251, 88006)



KORREX protection caps
(article 88497)



KORREX insulating tubes
(article 88498)

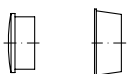

protection and sealing plugs, caps, and sleeves
for tube ends and workpieces

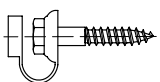

plastic sealings and caps for
hexagon wood screws 7 mm Ø
for fixing corrugated sheets
(article 88005)

steel plain	steel coated	stainless steel	brass Cu / Al / Ti plastic
St hard.	flZn	A4	
100	ZP		
90/100 10.9 12.9	ZP		
8 10 12	ZP flZn		
SSt	ZP mechZP flZn	1.4310	
St	ZP	A2	
			plastic
			plastic
			plastic
			plastic
			plastic
			plastic
			plastic
			plastic

* with approval



Driving features:
H = cross recess Phillips
Z = cross recess pozidriv
ISR/TORX = hexalobular socket

steel plain

steel coated

stainless steel

brass
Cu / Al / Ti
plastic



Non Standardised Screws/Bolts

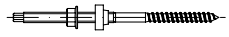

solar engineering fasteners/fixings
(please request special brochure)

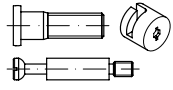

furniture assembly elements
(RAMPA)

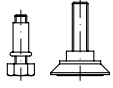

adjusting elements for furniture

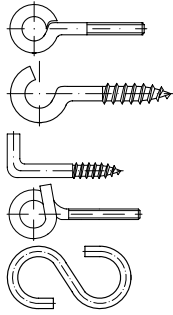

screw eyes, square bend screw hooks, s-hooks
type 1, type 48, type 4, type 4E
type 11, type 11 K, type 11 E
type 7, type 10, type 18, type 18E,
type 45
(article 88133 - 88145)

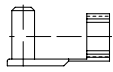

spring flap bolts („ES bolts“)
for fork joints acc. to DIN 71752“
(article 88752)



linch pins for tubes
(article 88023)

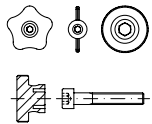

plastic knobs for hexagon screws
- wing knobs
- knurled knobs
- star knobs

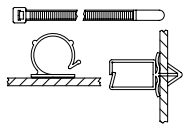

cable ties, supplies, fitting tools

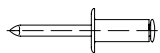

blind rivets
(article 88401-88488)

→ **REYHER®
FIXING
SYSTEMS**

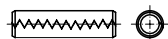

„CONNEX“ spring pins with serrated slot

steel plain	steel coated	stainless steel	brass Cu / Al / Ti plastic
St	HDG	A2	plastic
St	ZP white coating	A2 A4	Br
St	ZP		plastic
St	ZP		plastic
SSt.	1.4310		plastic

* with approval



Driving features:
H = cross recess Phillips
Z = cross recess pozidriv
ISR/TORX = hexalobular socket

steel plain

steel coated

stainless steel

brass
Cu / Al / Ti
plastic