

Plugs and Anchors

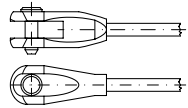

anchor systems for steel construction:
clevis, right hand/left hand threads
bolts, tension rods

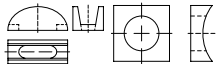

angular tensile joints and anchors for windbracing
(article 82010)
cam segments for diagonal pull up to 45°
(article 88060-88061)

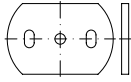

anchor sheets, heavy-duty washers

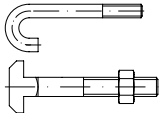

anchor bolts, tie anchors, tractive anchors

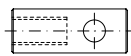

anchor sleeves

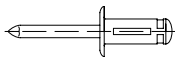

Blind Rivets Technology → page 59-60



BoxBolt® (KEE SAFETY)
cavity profile fixings for steel construction
→ fastener and clamping systems → page 54



brass expanding plugs
(article 88910)

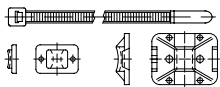

cable ties, fixings,
setting tools, accessory
(article 82500-82565)

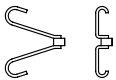

concrete anchors

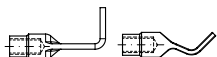

concrete anchor sleeves

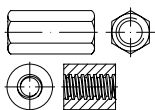

couplings, reduced, hexagon, round
(article 88087-88089)



Drilling Technology → page 59



drive-in plugs/mushroom plugs
with expanding pins

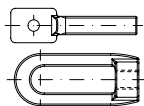

eye screws, thumb screws,
eye nuts, hanger nuts

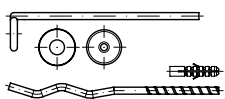

facing anchors

Fastening and Clamping Systems → page 54

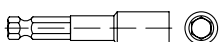

assembly tools: wrenches, keys, bits → page 59
(article 88265-88667)

material	coating
cast iron steel	ZP HDG
steel 52 forged steel	ZP HDG
steel stainless steel A2, A4	ZP HDG flZn
steel stainless steel A4	ZP HDG
steel stainless steel A4	ZP HDG
plastic	
steel stainless steel A4	ZP HDG flZn
steel stainless steel A4	ZP
steel stainless steel A2, A4	ZP HDG flZn
plastic	
steel C 22,8 forged	ZP flZn
stainless steel A4	

* with approval



material

coating

Plugs and Anchors



FISCHER plugs → page 55-58

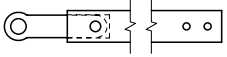

KORO scaffolding systems, caps
(concrete anchor sleeves with ring pads)

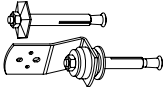

KUNKEL ceiling fixings
KUNKEL pipe fixings
KUNKEL special drills and setting tools

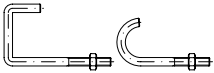

L hooks, stirrup bolts



LIEBIG plugs → page 58

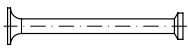

lifting ball head anchors
for concrete construction



LINDAPTER clamps → page 54

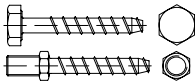

MULTI-MONTI HMS/MMS
screw anchors, wall screws
(article 88902-88908)



perforated strap hangers

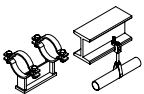

pipe fixings (fixed/insulated)

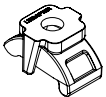

rail fixing systems
(article 82010)

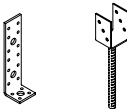

strap joints, angle joints, strap anchors
for timber connectors

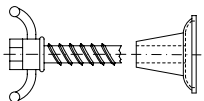

tension rods for steel construction, wing nuts
for tension rods, steel cones and
water locking nuts for tension rods

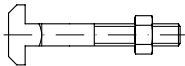

tension rods

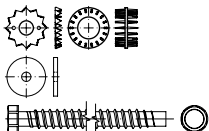

timber connectors (→ DIN 1052)
mandrels one or both sided
washers for timber connectors
ABC threaded rods for timber connectors (article 88052)

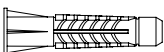

TOX hook plugs, 4 As K, Tri, Trika
(article 88381-88383)

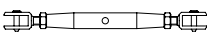

turnbuckles

material	coating
steel stainless steel A4 plastic	ZP
steel	ZP
steel stainless steel A2, A4	ZP HDG
steel 52-3	
MCI	ZP HDG
steel	ZP varnished
steel MCI stainless steel A2, A4	ZP HDG flZn
steel tempered	ZP HDG
steel stainless steel A4	ZP HDG flZn
steel	ZP flZn
steel stainless steel A2, A4	ZP HDG
MCI steel stainless steel A2, A4	black varnish ZP HDG flZn
steel stainless steel A4	ZP

*with approval



material

coating

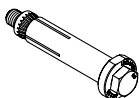
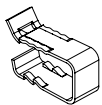
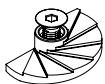
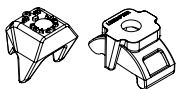
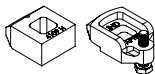
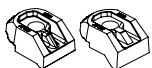
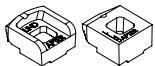
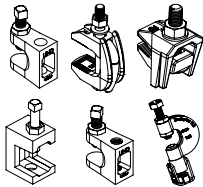
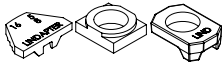
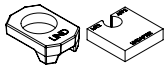
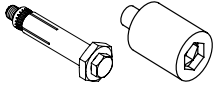
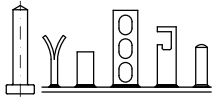

Plugs and Anchors

Upat plugs → page 58
(article 88715-88766)

welded head bolts, wall anchors, panel anchors
(NELSON head bolts)

KEE SAFETY-BoxBolt for cavity profile fixings
(article 82200)
KEE SAFETY-BoxSok valve adapters
for assembly on BoxBolt
(article 88201)

The fasteners and clamping system
with surprisingly many advantages for
new development and retrofit:

- variable clamping instead of welding and drilling
- unlimited use for every construction
- simple, fast and save assembly

* LINDAPTER accessory
type CW, P
(article 82011-82016)

* type AF-CW, AF-P
(article 82040-82044)

* type T, W, AFW
(article 82018, 82021, 82041)

LINDAPTER clamps,
type FL-D, FL-M, FL-S, F9, LC, F3
(article 82008, 82009, 82022, 82025,
82058, 82068)

* LINDAPTER clamps,
type A, B
(article 82001, 82002)

type AF-K
(article 82040)

type BS, D2,
(article 82003, 82007)

type LR, CF
(article 82010, 82045)

LINDAPTER-FLOOR-FAST type FF
floor fixings
(article 82019)

LINDAPTER grating fixings GF
(article 83030)

LINDAPTER-LINDI-BOLT type LB2
LINDAPTER-HOLLO-BOLT type HB
blind assembly fixings for steel cavity profiles
(article 82031)

material	coating
steel stainless steel A2, A4	ZP
stainless steel A4	
steel malleable iron	ZP HDG
steel malleable iron	ZP HDG
steel malleable iron	ZP HDG
malleable iron	ZP HDG
malleable iron	ZP HDG
malleable iron	ZP HDG
malleable iron	ZP HDG
malleable iron (Screw DIN 7991/ ISO 10642)	ZP
spring steel	zinc plated + thin lacquer
steel stainless steel A4	ZP

* with approval



material	coating
----------	---------

Plugs and Anchors



LINDAPTER toggle clamps type TC with internal thread for cavity fixings (article 82024)



LINDAPTER V-nuts



General Fixings

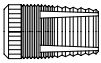

FISCHER board anchors PA 4 (article 88521)

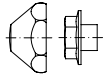

FISCHER caps AKM, FISCHER collar nuts BUM

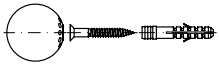

FISCHER door stopper TS8

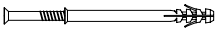

FISCHER nail plugs N (article 88503)



FISCHER nail sleeves FNH

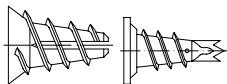

FISCHER plasterboard fixings GK/GK-M (article 88598)



FISCHER plugs M (article 88510)

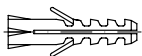

FISCHER plugs M-S (article 88506)

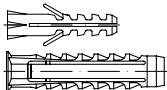

FISCHER plugs S
FISCHER plugs SX
(article 88500, 88554)

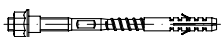

FISCHER sanitary fixing set WD, WDP, WST, UST, BO, WCN, S8 RD, KM

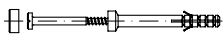

FISCHER special fixings for stairs TB, TBB



FISCHER steel expansion plugs FMD (article 88545)



FISCHER twist lock anchors GB (article 88507)

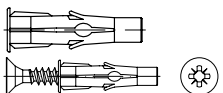

FISCHER universal plugs FU, FU-S (article 88551-88554)



FISCHER universal plugs UX, UX-R (article 88520)



High Performance Steel Anchors

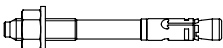

FISCHER anchor bolts FAZ/FAZ II (article 88561)

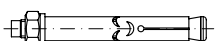

FISCHER bolt anchors FSA

material	coating
steel	ZP
MCI	ZP
brass	
plastic/ plastic	Cr
plastic/ screw: steel	ZP
plastic/ screw: steel stainless steel A2	
spring steel	ZP
plastic	
plastic/ cone: brass	
plastic	
plastic	
plastic/ screw: steel brass	ZP Cr
plastic/ screw: brass	
steel	
plastic	
plastic/ screw: steel	
plastic	
steel stainless steel A4 stainless steel 1.4529	ZP
steel	ZP

*with approval



material	coating
----------	---------

Plugs and Anchors

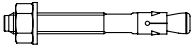

FISCHER bolts F II BN
(article 88582)

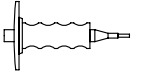
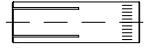

FISCHER hammer set anchors EA and
setting tools EAWH
(article 88567, 88586)

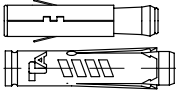

FISCHER heavy-duty anchors SL M/SL M-N, TA-M
(Artikel 88530, 88683)

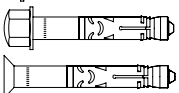
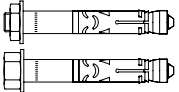

FISCHER high performance anchors
FH II-H, II-H, FH II-B, FH II-S, FH II-SK
(article 88590-88594)

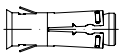

FISCHER hollow ceiling anchors FHY
(article 88513)

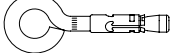
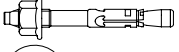
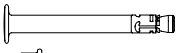

FISCHER nail anchors FNA, FNAM,
FNA OE, FNA-H
(article 88546-88549)

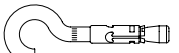

FISCHER wall screws MR
(article 88531)

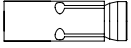

FISCHER Zykon anchors FZA; FZA-D, FZA-ST
FISCHER Zykon anchor bolts FZEA II,
drills, setting tools
(article 88583-88597)“



Chemical Fixings



FISCHER assembly adhesive MK
FISCHER assembly foam PU 500
FISCHER sealing materials silicone
(Artikel 88565)



FISCHER compound anchors RM, FH-P
anchor rods RGM
(Artikel 88533-88535)

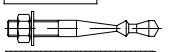
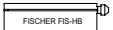

FISCHER Highbond anchors:
- injection cartridges FIS-HB 345 S
- Highbond anchors FHB-II AL, AS, dyn
- resin capsule FHB II-P
- cleaning brushes
(article 885578, 88579)

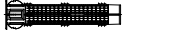
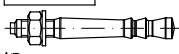

FISCHER injection anchor systems FIS:
cartridges FIS-V360 S, anchor rods,
anchor sleeves, anchors with internal thread
(article 88522-8579)

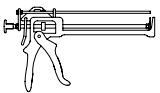

FISCHER squeeze guns for FIS cartridges
(Artikel 88524, 88525)

material	coating
steel stainless steel A4	ZP
steel stainless steel A4	ZP
steel stainless steel A4	ZP
steel stainless steel A4	ZP
steel	ZP
steel	ZP
steel	ZP
steel stainless steel A4 stainless steel 1.4529 ①	ZP
glass capsule steel stainless steel A4 stainless steel 1.45291 ①	ZP
steel stainless steel A4 stainless steel 1.4529 ①	ZP
steel plastic	ZP
steel	ZP

* with approval



① Materials for indoor
swimming pool
environments

material

coating



Plugs and Anchors

Cavity Fixings

FISCHER anchors A



FISCHER cavity metal fixings HM, HM-S
assembly pliers HM Z1
(article 88512)

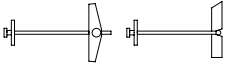

FISCHER toggles KD
(article 88518)

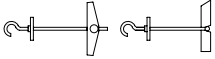

FISCHER toggles KDH, KM
(article 88519)

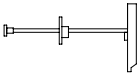

FISCHER toggle fixings K
(article 88509)



Long Shaft Anchors, Frame Fixings, Adjustment Fixings

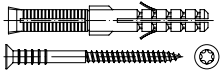

FISCHER adjustment plugs S10J
FISCHER adjustment screws JUSS
(article 88515)

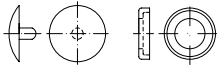

FISCHER caps
ADT, ADF, ADM, ASM
for FISCHER frame fixings
(article 88501, 88556, 88557, 88681, 88682)

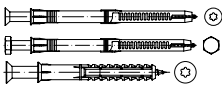

FISCHER frame fixings
SH-, S-R, SXS
FISCHER distance bolts ASL
FISCHER frame screws FS for windows
(article 88505, 88516, 88540-88545, 88563, 88564)



FISCHER fixings for frames (windows) F-M, F-S
(article 88516, 88680)

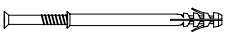

FISCHER nail plugs N
(article 88503)

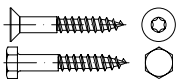

FISCHER safety screws SHT,
countersunk head with hexalobular socket
(TORX) or hexagon head
(Artikel 88596, 88599)



FISCHER universal long shaft anchors
SXS-T, SXS-F US
(article 88504)



Scaffold Fixings

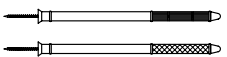

FISCHER wall-ties VBS 8
assembly tools

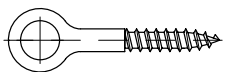

FISCHER scaffold fixings S 14 ROE, GS 12
(article 88536)



Insulation Fixings



FISCHER insulation fixings
DHK, DHM, DTM, DHN, DT, DHT, DPD,
DIPS, DIPK, DVN, FA
(article 88514, 88580)

material	coating
plastic	
steel	ZP
steel	ZP
steel	ZP
plastic	
plastic/ screw: steel stainless steel	
plastic screw: steel stainless steel A4	
plastic/ screw: steel steel/steel	ZP ZP
plastic/ screw: steel stainless steel A2	ZP
steel stainless steel A4	ZP
stainless steel	
plastic/ screw: steel plastic	
plastic steel	Al-Zn- coating

*with approval



material	coating
----------	---------

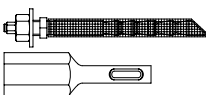
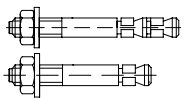
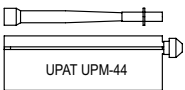
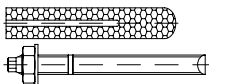
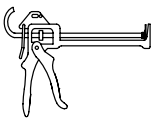
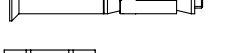
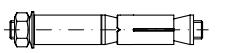
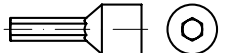
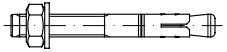
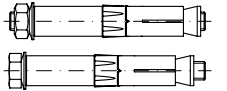
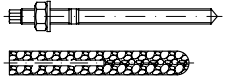
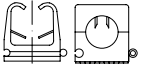

Plugs and Anchors

Electrical Fixings

FISCHER electric fixings SF, KB, SHA, RC
FISCHER clamps SCH, FC
(article 88558, 88559)

Heavy-Duty Fixings, Steel Anchors and Chemistry

* LIEBIG adhesive anchors KLP
anchor rods KLS für KLP

* LIEBIG anchors
AB = with threaded bolts, nuts and washers
AS = with hexagon screw and washer

LIEBIG anchors A
expansion sleeves with cone

* LIEBIG bolt anchors, BOA-X

LIEBIG brass expanding plugs WECO

* LIEBIG clamping anchors Ultra plus UP
LIEBIG cutting tools for Ultra-plus anchors UP

LIEBIG quick release bolt turners BE
for LIEBIG anchor rods

LIEBIG safety plugs
B = with threaded bolts, nuts and washers
S = with hexagon head screw and washer
SK = with hexagon head screw

* LIEBIG-ultraplus undercut adhesive anchors
LIEBIG anchor rods

Heavy-Duty Fixings, Steel Anchors and Chemistry

application guns for Upat chemical mortar UPM 44
(article 88736, 88739)

Upat anchor system UKA 3-anchor capsules (EAP)
Upat anchor rods for UKA 3,
Upat sleeves with internal thread IST
(article 88714-88723)

Upat chemical mortar UPM 44/UPM 44-CX 150,
Upat anchor rods UPM-A for UPM 44
(article 88733-88739)

Upat express anchors EXA/EXA, short
(article 88715, 88741)

Upat multicone anchor system UMV, UMV-dyn.
synthetic resin injection cartridges
capsules/anchor rods/setting tools
(article 88757-88769)

material	coating
plastic	
glass capsule steel stainless steel A4	ZP
steel stainless steel A4	ZP
steel stainless steel A4	ZP
steel stainless steel A4	ZP
brass	
steel stainless steel A4	ZP
steel hardened	
steel stainless steel A4	ZP
glass capsules steel stainless steel A4	ZP
steel	
steel stainless steel A4/1.4529 ^①	ZP HDG
steel stainless steel	ZP
steel stainless steel A4	
steel stainless steel A4	ZP

* with approval



① Materials for indoor swimming pool environments

material

coating

Drills, Bits and Wrench Keys, Blind Rivets

Assembly tools - Drills



Hammer drills ~ DIN 8035
with SDS-plus shank, grooved, cone, hexagon shank
(article 88997)



HSS drills for steel DIN 338
HSS-ECO drills for special materials
(article 88988, 88989)



masonry drills ~ DIN 8039
standard and special length
(article 88990)

Assembly Tools - Bits, Wrench Keys

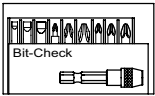

bits assortment
– for slotted head
– for cross recess H, Z
– for hexalobular socket (~TORX)
(article 88281-88286)

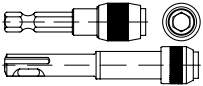

bit holders, screw coupling, magnetic socket holder
(article 88279, 88280)

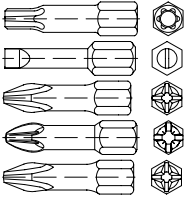

bits with hexagon drive
for screws with slotted head, cross recess
(Phillips, Pozidriv) and hexalobular socket (~TORX)
(article 88281-88286, 88655-88662)

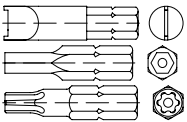

special bits for screws with theft resistant drive
(article 88665-88667)

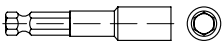

wrench keys
(article 88265)

Blind Rivets

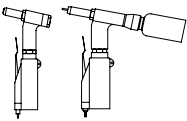

automatic tool for blind rivets and blind rivet nuts
(article 88425-88466)

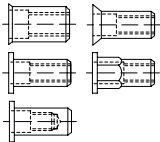

blind rivet nuts, open/closed,
round, round with hexagon push knurl
F = panhead, CSK = countersunk head,
SCSK = small countersunk head
(article 88418-88424, 88480, 88483)

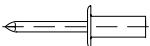

closed blind rivets (ISO 15973, 15974),
„CAP“ blind rivets for air and water tight connections
(article 88420)

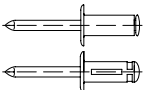

expanding blind rivets/Bulbtite blind rivets,
press-plate blind rivets „TRIFOLD“
for assembly at soft construction material
(article 88422, 88488)

material	coating
steel hardened	
steel hardened	
steel hardened	
steel hardened	
steel hardened	
steel hardened	
steel hardened	
steel hardened	
steel hardened	
steel stainless steel A2 Al-alloy	ZP
Al-alloy	
steel Al-alloy copper NiCu stainless steel	ZP

*with approval



material	coating
----------	---------

Blind Rivets

GESIPA-automatic GAV
fully automatic blind rivet system
for industrial serial production

hand tools for blind rivets and blind rivet nuts
(article 88430-88451)

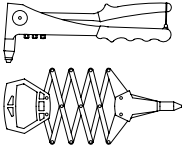

multi-zone blind rivets (open blind rivets)
GESIPA-Poly Grip
type A = pan head
type FK = big pan head
(article 88474, 88475)

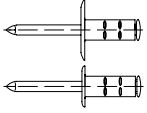

open-end blind rivets with break pull mandrel DIN 7337
(ISO 15977-15984)
type A = pan head,
type B = countersunk head,
type C = with big pan head
(article 88401-88417)

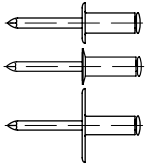

rivet boxes, set case, assembly case
(article 88470-88472)

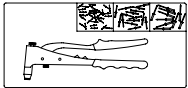

special blind rivets
– for facades (with varnished heads)
– with grooved shaft
– with threaded pin
– with swaged head
(article 88419, 88421)

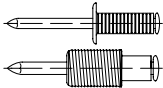

special blind rivets „MEGA GRIP“/„G-BULB“
for high tensile rivet assembly
type F = round pan head, type S = countersunk head
(article 88476-88486)

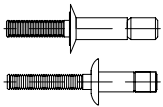

wireless tool gun for blind rivets/blind rivet nuts,
GESIPA-AccuBird/GESIPA-FireBird/GESIPA-PowerBird
quick-change accu
(article 88455-88457, 88465)

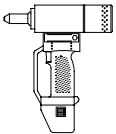

material	coating
steel Al-alloy stainless steel A2, A4 Kupfer NiCu plastic	ZP anodized
steel Al-alloy	ZP vanished
steel Al-alloy stainless steel A2	ZP

* with approval



material

coating